

# HOLIDAY AND GARDEN CABINS



HOLIDAY HOMES • WEEKEND CABINS • GARAGES



# CONTENTS



|  |           |                    |            |
|--|-----------|--------------------|------------|
| <b>LASITA MAJA</b>                     | <b>4</b>  | Elgin              | 91         |
| About Lasita Maja                      | 4         | Euftrat            | 64         |
| <b>YOUR HOLIDAY HOME</b>               | <b>6</b>  | Ganges             | 62         |
| Configuring your holiday home          | 8         | Großglockner       | 68         |
| Holiday homes in detail                | 10        | Han                | 82         |
| Doors and windows                      | 12        | Jari               | 90         |
| <b>Top sellers</b>                     | <b>16</b> | Jordan             | 77         |
| Domeo 9                                | 24        | Kasai              | 84         |
| Domeo 10                               | 25        | Lyndhurst          | 50         |
| Java                                   | 32        | Maipo              | 85         |
| Liverpool                              | 22        | Mälaren            | 57         |
| Malmö                                  | 28        | Matterhorn         | 72         |
| Örebro                                 | 30        | Mekong             | 58         |
| Öregrund                               | 18        | Mekong XL          | 60         |
| Östersund                              | 20        | Missouri           | 65         |
| Varberg                                | 26        | Mont Blanc         | 66         |
| <b>Holiday homes with flat roofs</b>   | <b>34</b> | Oka                | 81         |
| Barbados                               | 42        | Orinoco            | 80         |
| Barbados Mini                          | 44        | Shetland           | 48         |
| Brava                                  | 40        | Spiekeroog         | 93         |
| Dorset                                 | 36        | Staffordshire      | 49         |
| Exeter                                 | 39        | Tahiti             | 83         |
| Glencoe                                | 38        | Tigris             | 89         |
| Orkney                                 | 45        | Tresco             | 88         |
| <b>Holiday homes with gabled roofs</b> | <b>46</b> | Twin Cabin         | 86         |
| Alex                                   | 54        | Värnamo            | 74         |
| Aviemore                               | 55        | Volta              | 53         |
| Blue Nile                              | 78        | White Nile         | 79         |
| Brighton                               | 52        | Yukon              | 76         |
| Canada                                 | 70        | Zanzibar           | 92         |
| Ceylon                                 | 71        | <b>GARAGES</b>     | <b>94</b>  |
| Dingwall                               | 51        | Antigua            | 101        |
| Elba                                   | 87        | Canberra           | 100        |
|  |           | Hawaii             | 98         |
|  |           | <b>ACCESSORIES</b> | <b>102</b> |



Lasita Maja

# MORE THAN 20 YEARS OF QUALITY

## EVERY GARDEN CABIN BEGINS WITH A DREAM.

It's your dream. At Lasita Maja, we just bring it to life.

As an experienced manufacturer of high-quality blockboard cabins, we produce children's playhouses, pavilions, garages and individual holiday homes, as well as classic garden cabins. To do this, we use the best wood and combine modern and gentle processing technology with traditional craftsmanship and secure packaging. We are well aware that high quality equals happy customers. And if there's one thing that matters more than most, it's getting the details right.



## HIGH-QUALITY WOOD

We use only selected Nordic spruce for our garden cabins. Thanks to its flexible properties, it is perfect for use as building and construction timber. Its slow growth in Europe's colder regions makes the wood particularly stable and solid. In addition to a natural look, our holiday homes are also available in four colours: Swedish red, granite grey, glacier green and light grey.



To ensure that we deliver a unique product, we rely on a combination of long-standing employees with a great deal of experience and modern machinery. Trained eyes inspect and sort the materials and components. Our precision machine tools saw, plane and mill the individual parts to the correct dimensions and shapes. Before being carefully and securely packed, everything undergoes a final inspection.

So that we can continue to offer our customers the best quality, we have implemented a quality management system that complies with the requirements of the ISO 9001 standard. Our products also come with a 5-year warranty.



## HIGH-QUALITY NORDIC RAW MATERIALS, STATE-OF-THE-ART PROCESSING AND DECADES OF EXPERIENCE: OUR RECIPE FOR SUCCESS.



## DELIVERED TO YOUR DOOR

### The assembly kit

Your garden cabin will be delivered as a complete kit in one or more packs. Comprehensive assembly instructions are included. If you do not begin assembly immediately after delivery, store your garden cabin in a dry location, protected from UV light.

### Delivery

We deliver our products to your specialist dealer on request or "to the kerb" at your home for an additional charge. Delivery will be made on the agreed date using a 40-t HGV. There must be no restrictions to access for this vehicle.



SNAP & LIKE

FOLLOW US ON FACEBOOK.







ÖREBRO

p. 30

These are real little homes, for living in during the year's short time-outs. Find your own personal time-out cabin with us!



MALMÖ

p. 28



**A diverse selection**

From small to huge: **1** The two-storey Örebro cabin with a floor space of 40 m<sup>2</sup> impresses with its bright sleeping loft. **2** A terrace can also be added to each of our holiday homes. **3** The Malmö cabin offers plenty of space over two floors, as well as an optional roof over the terrace. Windows on three sides allow sun to flood in at any time of the day **4** The Östersund cabin will also impress with its large windows, high quality and plenty of space in a small area.



ÖSTERSUND

p. 20

**WHETHER ONE OR TWO STOREYS, 40 OR 100 SQUARE METRES – YOUR PERFECT FEEL-GOOD RETREAT AWAITS!**



NOT BEING A STRANGER AWAY FROM HOME. NOT HAVING TO WONDER IF ALL THE UTENSILS WILL BE THERE. WHAT THE BEDDING IS LIKE. THAT IS WHAT A HOLIDAY MEANS TO ME.

**SIMPLY HOP IN THE CAR AND ARRIVE. AT HOME. YET AWAY.**



# THE DREAM OF A HOLIDAY HOME: WHAT YOU SHOULD BEAR IN MIND.



## Our garden cabin and holiday home concept

At Lasita Maja, we value individuality and creativity. That's why we specialise in developing custom cabin solutions. The designs in this catalogue are intended to inspire you and give you ideas for your own concept. Each model shown can be changed, adapted or completely redesigned. So be sure to have your sketchbook by your side when looking through the countless models available; don't be afraid to draw everything that comes to mind. Because we want to work with you to build the holiday home you imagine. So we can make your dream of the perfect holiday home or garden cabin a reality.

Feel free to contact us. We will advise you, step-by-step, until your dream house is delivered.

## COMPLETE FREEDOM IN THE PLANNING OF YOUR HOLIDAY HOME

### Materials and product classes

We use selected Nordic spruce (*Picea abies*) for our products, which has proven itself in holiday home construction. Finger-jointing of the material enables us to also produce constructions exceeding the standard length of the log (6 metres). We offer wall thicknesses of 44, 70 and 92 mm.



Further details on our products such as e.g. wood type, wall thickness etc. can be found on pages 10-15.



As when building a home, there are a few things to consider when building a holiday home.

## WHAT IS THE CABIN GOING TO BE USED FOR?

If the house is intended to function as additional living space, the planning/construction must be oriented towards this. If it is to be used as a storage space, more emphasis should be placed on the floor, which must support the weight of the stored items. Consideration should also be given to an alternative type of access for a wheelbarrow or even a vehicle. If the garden cabin is to be used for creative activities, the interior will need to be well lit. All these considerations will affect the appropriate design of your product. So ensure that you define the intended use as precisely as possible.



## CHECKLIST

1. Select a suitable location
2. Familiarise yourself with the building regulations in your region
3. Plan your garden cabin or holiday home with Lasita Maja
4. Consult with our planning experts
5. Plan and quotation
6. Financing the project
7. Obtain a building permit from the responsible authority
8. Selection of the architect/fitter/contractor
9. Coordination of the different projects
10. Compilation of the order
11. Organisation of the installation

So you can see, there is a lot to think about and also a lot to do to turn your holiday home into your dream. But don't worry!

At Lasita Maja, we have many years of experience and are always available to provide you with expert support.

**Thought of everything? Take another look at our checklist. There is also space for your own notes on the last pages of this catalogue.**





# HOLIDAY HOMES

## RELIABLE TECHNOLOGY FOR SITTING BACK AND RELAXING.

This is a real little home, for living in during the year's short time-outs. So it must be of a correspondingly high quality. The focus of our holiday homes is on construction, functionality and workmanship!



| DESIGN   |                             |
|--|-----------------------------|
| 1 Wall thickness mm  | 44 / 70 / 92                |
| 2 Double tongue and groove<br>Wind-tight chalet connection | +                           |
| 3 Wind protection  | Threaded rod or storm strip |
| 4 Wall insulation  | Optional                    |
| 5 Impregnated substructure                                 | +                           |
| 6 Floorboards 18 / 28 mm                                   | +                           |
| 7 Floor insulation   | Optional                    |

| ROOF CONSTRUCTION                      |                        |
|--|------------------------|
| 8 Roof boards                          | 18 mm                  |
| 9 Roof construction                    | Roof purlins / rafters |
| 10 Roof insulation                     | Optional               |
| 11 Roof construction for roofing tiles | On request             |

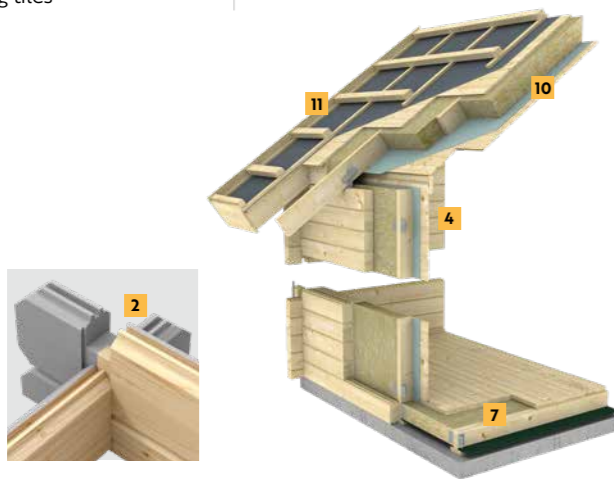

## Essentials

**NORDIC SPRUCE**  
**44 / 70 / 92 MM**

**DOUBLE TONGUE AND GROOVE**

**IMPREGNATED SUBSTRUCTURE**

**FLOORBOARDS 28 MM**  
**ROOF BOARDS 18 MM**

**SAFETY GLASS**

**U-VALUE WINDOW / DOOR 2.8**



| WINDOW                           |   |
|----------------------------------|---|
| Wood type                        | Untreated glued pine                    |
| 1 Profile thickness mm           | 44 / 70 / 92                            |
| 2 Mullions                       | (with screws)                           |
| 3 Glass                          | Double (4 / 14 / 4)                     |
| U-value > W/m²K                  | 2.8                                     |
| 4 Rubber seal                    | +                                       |
| 5 Drip cap                       | Aluminium                               |
| Window opening                   | inwards                                 |
| 6 Opening system                 | 2-hand tilt & turn / 1-hand tilt & turn |
| 7 Frame profile for installation | Included from 70 mm                     |

| DOORS                            |  |
|----------------------------------|--|
| Wood type glued wood             | Untreated glued pine                     |
| 1 Profile thickness mm           | 44 / 70 / 92                             |
| 2 Mullions                       | (with screws)                            |
| 3 Glass                          | Double (4 / 8 / 4) / Double (4 / 14 / 4) |
| U-value > W/m²K                  | 3.0 / 2.8                                |
| 4 Rubber seal                    | +  |
| 5 Door threshold                 | Aluminium / coated metal                 |
| Door opening                     | outwards                                 |
| 6 Lock                           | Cylinder                                 |
| 7 Frame profile for installation | Included from 70 mm                      |



# PLATINUM DOORS

## DOUBLE DOOR 1



## DOUBLE DOOR 2



## DOUBLE DOOR 3



## SINGLE DOOR 1



## SINGLE DOOR 2



## SINGLE DOOR 3



## PLATINUM DETAILS



Symbol images

|                         | DOUBLE DOOR 1         | DOUBLE DOOR 2         | DOUBLE DOOR 3         | SINGLE DOOR 1        | SINGLE DOOR 2        | SINGLE DOOR 3        |
|-------------------------|-----------------------|-----------------------|-----------------------|----------------------|----------------------|----------------------|
| <b>Size</b>             | <b>1580 x 2000 mm</b> | <b>1580 x 2000 mm</b> | <b>1580 x 2000 mm</b> | <b>827 x 2000 mm</b> | <b>827 x 2000 mm</b> | <b>827 x 2000 mm</b> |
| Wood type               | Pine                  | Pine                  | Pine                  | Pine                 | Pine                 | Pine                 |
| Item number             | 2+ TU.26P.b           | 2+ TU.2LP.b           | 2+ TU.18P.b           | 2+ U.18P.b           | 2+ U.26P.b           | 2+ U.2LP.b           |
| Suitable wall thickness | 44 / 70 / 92 mm       | 44 / 70 / 92 mm       | 44 / 70 / 92 mm       | 44 / 70 / 92 mm      | 44 / 70 / 92 mm      | 44 / 70 / 92 mm      |
| Glued wood              | +                     | +                     | +                     | +                    | +                    | +                    |
| Mullions                | +                     | -                     | +                     | +                    | +                    | -                    |
| Glazing                 | Double (ISO)          | -                     | Double (ISO)          | Double (ISO)         | Double (ISO)         | -                    |
| Glass thickness         | 4 / 8 / 4             | -                     | 4 / 8 / 4             | 4 / 8 / 4            | 4 / 8 / 4            | -                    |
| U-value                 | 3.0 W/m²K             | 3.0 W/m²K             | 3.0 W/m²K             | 3.0 W/m²K            | 3.0 W/m²K            | 3.0 W/m²K            |
| Silicone seal           | +                     | +                     | +                     | +                    | +                    | +                    |
| Opens                   | outwards              | outwards              | outwards              | outwards             | outwards             | outwards             |
| Lock                    | Cylinder              | Cylinder              | Cylinder              | Cylinder             | Cylinder             | Cylinder             |

# DIAMOND DOORS

## DOUBLE DOOR 1



## DOUBLE DOOR 2



## SLIDING DOOR



## SINGLE DOOR 1



## SINGLE DOOR 2



## DIAMOND DETAILS

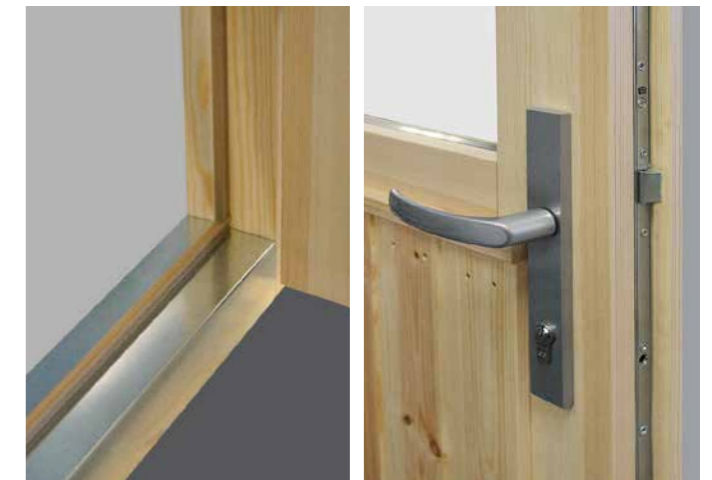

Symbol images

|                         | DOUBLE DOOR 1              | DOUBLE DOOR 2              | SLIDING DOOR 1             | SINGLE DOOR 1              | SINGLE DOOR 2              |
|-------------------------|----------------------------|----------------------------|----------------------------|----------------------------|----------------------------|
| <b>Size</b>             | <b>1580 x 2000 mm</b>      | <b>1580 x 2000 mm</b>      | <b>2500 x 2000 mm</b>      | <b>827 x 2000 mm</b>       | <b>827 x 2000 mm</b>       |
| Wood type               | Pine                       | Pine                       | Pine                       | Pine                       | Pine                       |
| Item number             | 3+ TU.18P.b                | 3+ TU.24P.b                | 3+ TU2L.10P                | 3+ U.26P.b                 | 3+ U.18P.b                 |
| Suitable wall thickness | 44 / 70 / 92 mm            | 44 / 70 / 92 mm            | 44 / 70 / 92 mm            | 44 / 70 / 92 mm            | 44 / 70 / 92 mm            |
| Glued wood              | +                          | +                          | +                          | +                          | +                          |
| Mullions                | +                          | +                          | +                          | +                          | +                          |
| Glazing                 | Double (ISO)               | Double (ISO)               | Double (ISO)               | Double (ISO)               | Double (ISO)               |
| Glass thickness         | 4 / 14 / 4                 | 4 / 14 / 4                 | 4 / 14 / 4                 | 4 / 14 / 4                 | 4 / 14 / 4                 |
| U-value                 | 2.8 W/m²K                  | 2.8 W/m²K                  | 2.8 W/m²K                  | 2.8 W/m²K                  | 2.8 W/m²K                  |
| Silicone seal           | +                          | +                          | +                          | +                          | +                          |
| Opens                   | outwards                   | outwards                   | inwards                    | outwards                   | outwards                   |
| Lock                    | Multi-point locking system | Multi-point locking system | Multi-point locking system | Multi-point locking system | Multi-point locking system |



# PLATINUM WINDOWS

## SINGLE WINDOW 1



Interior view

Exterior view

## SINGLE WINDOW 2



# DIAMOND WINDOWS

## SINGLE WINDOW



Interior view

Exterior view

## DOUBLE WINDOW



Interior view

## DOUBLE WINDOW



## BI-FOLD DOOR



# DIAMOND++ WINDOW



Symbol Image

Cross-section of Diamond window with double glazing

- Laminated pine
- TPE seals
- Aluminium water drip
- Exterior windowsill
- 26 mm double glazing (4 / 18 / 4)



|                         | SINGLE WINDOW 1     | SINGLE WINDOW 2      | DOUBLE WINDOW        |
|-------------------------|---------------------|----------------------|----------------------|
| <b>Size</b>             | <b>916 x 916 mm</b> | <b>552 x 1729 mm</b> | <b>1374 x 916 mm</b> |
| Wood type               | Pine                | Pine                 | Pine                 |
| Item number             | 2+ A.9P             | 2+ A.OP.b            | 2+ TA.6P             |
| Suitable wall thickness | 44 / 70 / 92 mm     | 44 / 70 / 92 mm      | 44 / 70 / 92 mm      |
| Glued wood              | +                   | +                    | +                    |
| Mullions                | +                   | -                    | +                    |
| Glazing                 | Double (ISO)        | -                    | Double (ISO)         |
| Glass thickness         | 4 / 14 / 4          | 4 / 14 / 4           | 4 / 14 / 4           |
| U-value                 | 2.8 W/m²K           | 2.8 W/m²K            | 2.8 W/m²K            |
| Silicone seal           | +                   | +                    | +                    |
| Water drip              | +                   | +                    | +                    |
| Opens                   | inwards             | inwards              | inwards              |
| Opening system          | 2-hand tilt & turn  | 2-hand tilt & turn   | 2-hand tilt & turn   |
| Lock                    | Cylinder            | Cylinder             | Cylinder             |

|                                | SINGLE WINDOW       |
|--------------------------------|---------------------|
| Wood type                      | Pine                |
| Suitable wall thickness        | 44 / 70 / 92 mm     |
| Glued wood                     | +                   |
| Mullions                       | +                   |
| Glazing                        | Double (4 / 18 / 4) |
| Code                           | 5+                  |
| U-value                        | 1.1 W/m²K           |
| Silicone seal                  | +                   |
| Water drip                     | Aluminium           |
| Opens                          | inwards             |
| Opening system                 | 1-hand tilt&turn    |
| Frame profile for installation | Included from 44 mm |
| Toughened glass                | +                   |

|                         | SINGLE WINDOW              | DOUBLE WINDOW              | BI-FOLD DOOR               |
|-------------------------|----------------------------|----------------------------|----------------------------|
| <b>Size</b>             | <b>810 x 1050 mm</b>       | <b>1374 x 916 mm</b>       | <b>4100 x 2000 mm</b>      |
| Wood type               | Pine                       | Pine                       | Pine                       |
| Item number             | 3+ A.6P.f                  | 3+ TA.4P                   | 3+ TU5V.20V                |
| Suitable wall thickness | 44 / 70 / 92 mm            | 44 / 70 / 92 mm            | 44 / 70 / 92 mm            |
| Glued wood              | +                          | +                          | +                          |
| Mullions                | +                          | +                          | -                          |
| Glazing                 | Double (ISO)               | Double (ISO)               | Double (ISO)               |
| Glass thickness         | 4 / 14 / 4                 | 4 / 14 / 4                 | 4 / 14 / 4                 |
| U-value                 | 2.8 W/m²K                  | 2.8 W/m²K                  | 2.8 W/m²K                  |
| Silicone seal           | +                          | +                          | +                          |
| Water drip              | +                          | +                          | +                          |
| Opens                   | inwards                    | inwards                    | inwards                    |
| Opening system          | 1-hand tilt & turn         | 1-hand tilt & turn         | 1-hand tilt & turn         |
| Lock                    | Multi-point locking system | Multi-point locking system | Multi-point locking system |



# TOP SELLERS.

PERFECT FOR EVERY NEED.  
OUR MOST POPULAR HOLIDAY HOMES  
– AT A GLANCE.

08 03

MODELS

WALL  
THICK-  
NESSES



# ÖREGRUND

## ULTRAMODERN WEEK-END CABIN WITH A LIGHT-FILLED INTERIOR.

|                              | ÖREGRUND DIAMOND**    | ÖREGRUND DIAMOND**    |
|------------------------------|-----------------------|-----------------------|
| Item number                  | 7015544               | 9215544               |
| <b>Base dimensions W × D</b> | <b>1200 × 530 cm</b>  | <b>1200 × 530 cm</b>  |
| Wall thickness               | 70 mm                 | 92 mm                 |
| Floor area                   | 47.50 m <sup>2</sup>  | 47.50 m <sup>2</sup>  |
| Terrace area                 | 40.10 m <sup>2</sup>  | 40.10 m <sup>2</sup>  |
| Interior                     | 44.20 m <sup>2</sup>  | 43.30 m <sup>2</sup>  |
| Volume                       | 191.43 m <sup>3</sup> | 191.43 m <sup>3</sup> |
| Side wall height             | 272 cm                | 272 cm                |
| Ridge height                 | 321 cm                | 321 cm                |
| Roof overhang                | 100 cm                | 100 cm                |
| Roof area                    | 86.80 m <sup>2</sup>  | 86.80 m <sup>2</sup>  |
| Single door W × H            | 90 × 200 cm           | 90 × 200 cm           |
| 4 × single door W × H        | 83 × 200 cm           | 83 × 200 cm           |
| 2 × sliding door W × H       | 160 × 200 cm          | 160 × 200 cm          |
| 2 × double door W × H        | 160 × 265 cm          | 160 × 265 cm          |
| 2 × single window W × H      | 92 × 92 cm            | 92 × 92 cm            |
| Single window W × H          | 65 × 65 cm            | 65 × 65 cm            |
| 2 × double window W × H      | 137 × 105 cm          | 137 × 105 cm          |
| Fixed double window W × H    | 360 × 265 cm          | 360 × 265 cm          |
| Floor thickness              | 28 mm                 | 28 mm                 |
| Roof covering, optional      | 8 × 15 m              | 8 × 15 m              |
| Onduline, optional           | 22 × 5 m              | 22 × 5 m              |

\*Platinum: Window opening system: 2-hand tilt & turn. Door opening: outwards.  
Locking system: Cylinder  
\*\*Diamond: Window opening system: 1-hand tilt & turn. Door opening: outwards/inwards.  
Locking system: various lock types



### APPROPRIATE ACCESSORIES



Onduline



Bar unit

Other accessories can be found from page 102.

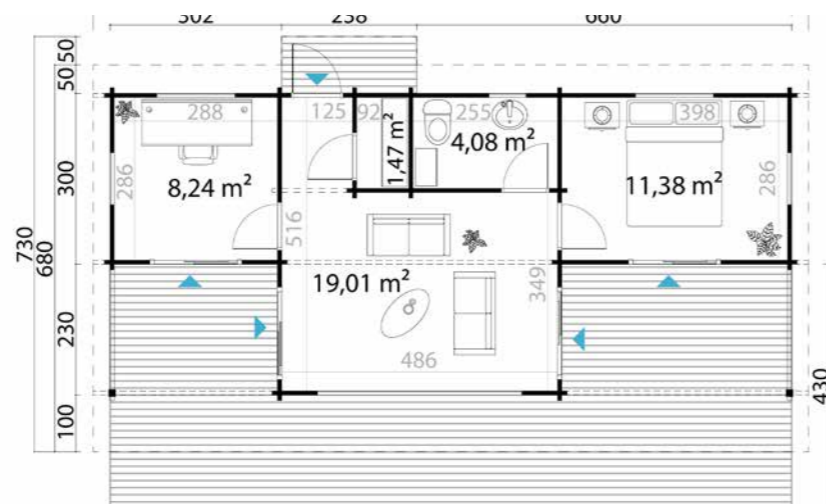

SNAP & WATCH





47.5 m<sup>2</sup>



SNAP & WATCH

# ÖSTERSUND MODERN WEEKEND CABIN WITH LARGE WINDOW FRONTAGE AND HIGH-QUALITY SLIDING DOORS.

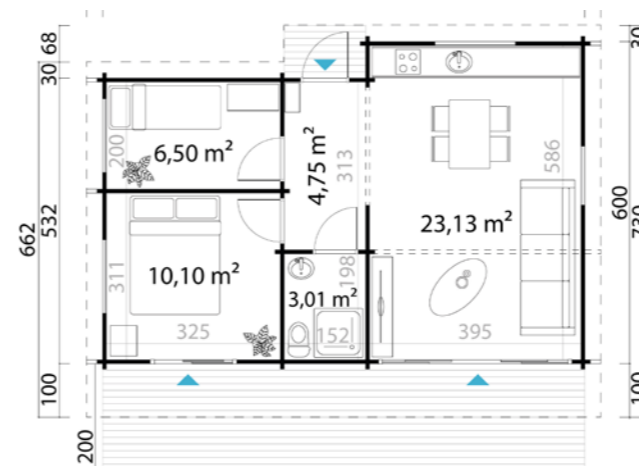

|                                    | ÖSTERSUND DIAMOND*    | ÖSTERSUND DIAMOND**   |
|------------------------------------|-----------------------|-----------------------|
| Item number                        | 7015444               | 9215444               |
| <b>Base dimensions W × D</b>       | <b>900 × 600 cm</b>   | <b>900 × 600 cm</b>   |
| Wall thickness                     | 70 mm                 | 92 mm                 |
| Floor area                         | 50.70 m <sup>2</sup>  | 50.70 m <sup>2</sup>  |
| Terrace area                       | 19.50 m <sup>2</sup>  | 19.50 m <sup>2</sup>  |
| Interior                           | 47.50 m <sup>2</sup>  | 46.50 m <sup>2</sup>  |
| Volume                             | 152.50 m <sup>3</sup> | 152.50 m <sup>3</sup> |
| Side wall height                   | 276 cm                | 276 cm                |
| Ridge height                       | 318 cm                | 318 cm                |
| Roof overhang                      | 100 cm                | 100 cm                |
| Roof area                          | 68.13 m <sup>2</sup>  | 68.13 m <sup>2</sup>  |
| Single door W × H                  | 90 × 200 cm           | 90 × 200 cm           |
| 3 × single door W × H              | 83 × 200 cm           | 83 × 200 cm           |
| Double door W × H                  | 160 × 265 cm          | 160 × 265 cm          |
| Double door with side panels W × H | 160 × 265 cm          | 160 × 265 cm          |
| Single window W × H                | 150 × 65 cm           | 150 × 65 cm           |
| 2 × double window W × H            | 137 × 92 cm           | 137 × 92 cm           |
| Double window W × H                | 110 × 173 cm          | 110 × 173 cm          |
| 2 × fixed single window W × H      | 100 × 265 cm          | 100 × 265 cm          |
| Floor thickness                    | 28 mm                 | 28 mm                 |
| Roof covering, optional            | 9 × 10 m              | 9 × 10 m              |
| Onduline, optional                 | 17 × 5 m              | 17 × 5 m              |

\*Platinum: Window opening system: 2-hand tilt & turn. Door opening: outwards. Locking system: Cylinder  
 \*\*Diamond: Window opening system: 1-hand tilt & turn. Door opening: outwards/inwards. Locking system: various lock types

## APPROPRIATE ACCESSORIES

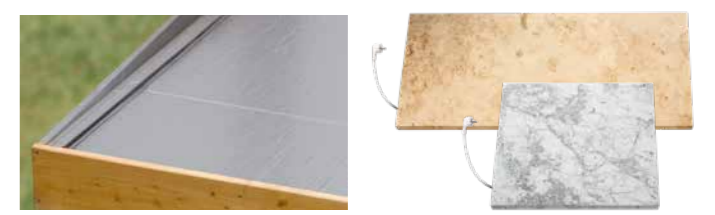

Onduline Infrared heater Other accessories can be found from page 102.





**NEW!**



15.8 m<sup>2</sup>

Liverpool 3



**SNAP & WATCH**



Liverpool 1

Wood bi-fold door



Liverpool 2

Wood bi-fold door

**LIVERPOOL**  
**A WIDE WINDOW FRONTAGE PROVIDES GREAT INTERIOR LIGHT, WITH LARGE, COVERED TERRACE.**

|                           | LIVERPOOL 1          | LIVERPOOL 2          | LIVERPOOL 3          |
|---------------------------|----------------------|----------------------|----------------------|
| Item number               | 7016344              | 4428244              | 4428319              |
| Base dimensions W x D     | 550 x 300 + 100 cm   | 550 x 300 + 100 cm   | 550 x 300 + 100 cm   |
| Wall thickness            | 70 mm                | 44 mm                | 44 mm                |
| Floor area                | 16.50 m <sup>2</sup> | 16.50 m <sup>2</sup> | 16.50 m <sup>2</sup> |
| Terrace area              | 5.50 m <sup>2</sup>  | 5.50 m <sup>2</sup>  | 5.50 m <sup>2</sup>  |
| Interior                  | 15.30 m <sup>2</sup> | 15.80 m <sup>2</sup> | 15.80 m <sup>2</sup> |
| Volume                    | 34.66 m <sup>3</sup> | 36.83 m <sup>3</sup> | 36.83 m <sup>3</sup> |
| Side wall height          | 221 cm               | 228 cm               | 228 cm               |
| Ridge height              | 236 cm               | 239 cm               | 239 cm               |
| Roof overhang             | 130 cm               | 115 cm               | 115 cm               |
| Roof area                 | 28.16 m <sup>2</sup> | 25.10 m <sup>2</sup> | 25.10 m <sup>2</sup> |
| Glazed door W x H         | 410 x 200 cm         | 410 x 200 cm         | 340 x 198 cm         |
| Floor thickness           | 18 mm                | 18 mm                | 18 mm                |
| Roof covering, optional   | 3 x 15 m             | 3 x 15 m             | 3 x 15 m             |
| Onduline, optional (pack) | 7 x 5 m              | 6 x 5 m              | 6 x 5 m              |

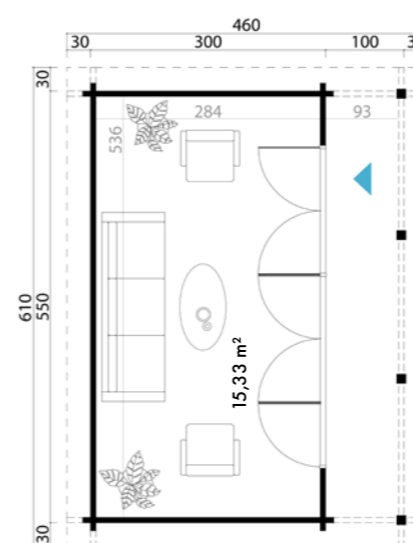

LIVERPOOL 1

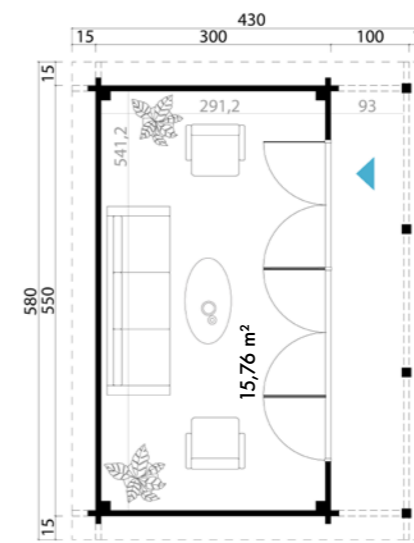

LIVERPOOL 2

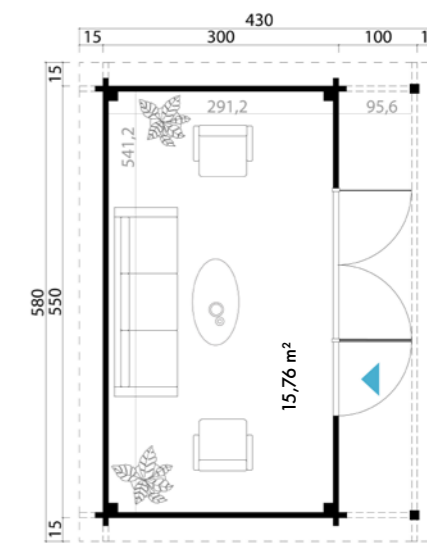

LIVERPOOL 3

TOP SELLERS



# DOMEO 9

## CONTEMPORARY DESIGN WITH BI-FOLD DOOR GLASS FRONT.

|                               | DOMEO 9              | DOMEO 10             |
|-------------------------------|----------------------|----------------------|
| Item number                   | 7015641              | 7015741              |
| Base dimensions W x D         | 450 x 450 cm         | 450/850 x 450 cm     |
| Wall thickness                | 70 mm                | 70 mm                |
| Floor area                    | 20.30 m <sup>2</sup> | 20.30 m <sup>2</sup> |
| Terrace area                  | 12.20 m <sup>2</sup> | 27.9 m <sup>2</sup>  |
| Interior                      | 19 m <sup>2</sup>    | 19 m <sup>2</sup>    |
| Volume                        | 47.83 m <sup>3</sup> | 47.83 m <sup>3</sup> |
| Side wall height              | 245 cm               | 245 cm               |
| Ridge height                  | 261 cm               | 262 cm               |
| Roof overhang                 | 120 cm               | 120 cm               |
| Roof area                     | 34.81 m <sup>2</sup> | 52.51 m <sup>2</sup> |
| 2 x glazed bi-fold door W x H | 340 x 198 cm         | 340 x 198 cm         |
| Floor thickness               | 28 mm                | 28 mm                |
| Roof covering, optional       | 4 x 15 m             | 7 x 10 m             |
| Onduline, optional            | 9 x 5 m              | 13 x 5 m             |



## DOMEO 10

**WHEN YOU NEED A LITTLE MORE LUXURY: BI-FOLD DOOR DESIGN WITH LARGE COVERED OUTDOOR AREA FOR "MORE LIFE IN THE GARDEN".**

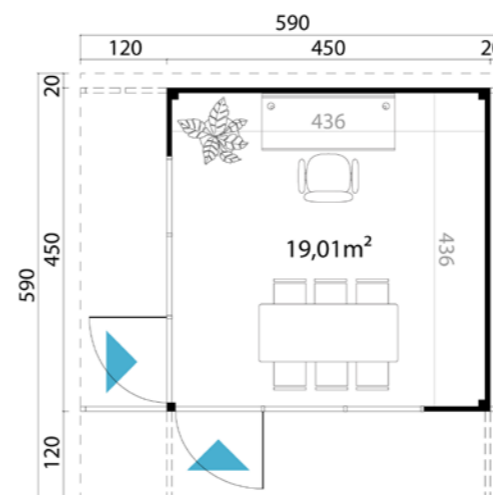

DOMEO 9

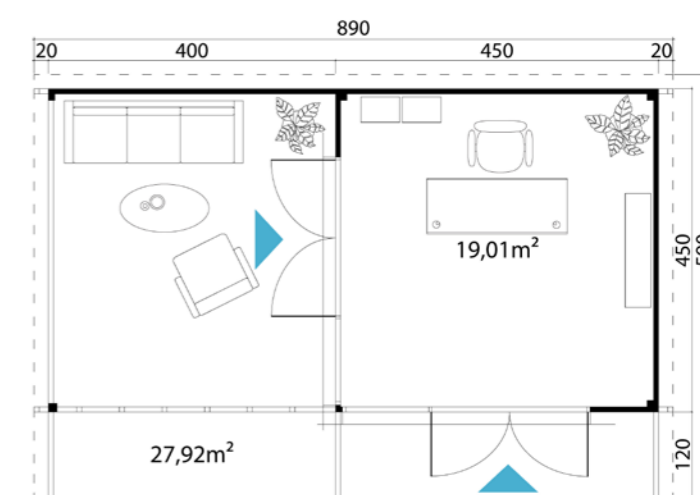

DOMEO 10



# VARBERG COMPACT CABIN WITH DIFFERENT WALL THICKNESSES. PERFECT FOR COOLER DAYS.

## APPROPRIATE ACCESSORIES



Infrared heater



Onduline

Other accessories  
can be found from page 102.



28.6 m<sup>2</sup>

|                              | VARBERG 44<br>PLATINUM* | VARBERG 44<br>DIAMOND** | VARBERG 70<br>PLATINUM* | VARBERG 70<br>DIAMOND** | VARBERG 92<br>PLATINUM* | VARBERG 92<br>DIAMOND** |
|------------------------------|-------------------------|-------------------------|-------------------------|-------------------------|-------------------------|-------------------------|
| Item number                  | 4427702                 | 4427706                 | 7016041                 | 7016044                 | 9216041                 | 9216044                 |
| <b>Base dimensions W × D</b> | <b>800 × 500 cm</b>     | <b>800 × 500 cm</b>     | <b>800 × 500 cm</b>     | <b>800 × 500 cm</b>     | <b>800 × 500 cm</b>     | <b>800 × 500 cm</b>     |
| Wall thickness               | 44 mm                   | 44 mm                   | 70 mm                   | 70 mm                   | 92 mm                   | 92 mm                   |
| Floor area                   | 30 m <sup>2</sup>       | 30 m <sup>2</sup>       | 30 m <sup>2</sup>       | 30 m <sup>2</sup>       | 30 m <sup>2</sup>       | 30 m <sup>2</sup>       |
| Interior                     | 28.60 m <sup>2</sup>    | 28.60 m <sup>2</sup>    | 27.80 m <sup>2</sup>    | 27.80 m <sup>2</sup>    | 27.10 m <sup>2</sup>    | 27.10 m <sup>2</sup>    |
| Volume                       | 65.74 m <sup>3</sup>    | 65.74 m <sup>3</sup>    | 65.74 m <sup>3</sup>    | 65.74 m <sup>3</sup>    | 65.74 m <sup>3</sup>    | 65.74 m <sup>3</sup>    |
| Side wall height             | 228 cm                  | 228 cm                  | 229 cm                  | 229 cm                  | 229 cm                  | 229 cm                  |
| Ridge height                 | 239 cm                  | 239 cm                  | 243 cm                  | 243 cm                  | 243 cm                  | 243 cm                  |
| Roof overhang                | 25 cm                   | 25 cm                   | 25 cm                   | 25 cm                   | 25 cm                   | 25 cm                   |
| Roof area                    | 36.75 m <sup>2</sup>    | 36.75 m <sup>2</sup>    | 36.75 m <sup>2</sup>    | 36.75 m <sup>2</sup>    | 36.75 m <sup>2</sup>    | 36.75 m <sup>2</sup>    |
| 2 × double door W × H        | 158 × 196 cm            | 158 × 196 cm            | 158 × 200 cm            | 158 × 200 cm            | 158 × 200 cm            | 158 × 200 cm            |
| 2 × single door W × H        | 83 × 196 cm             | 83 × 196 cm             | 83 × 200 cm             | 83 × 200 cm             | 83 × 200 cm             | 83 × 200 cm             |
| 2 × single window W × H      | 55 × 178 cm             | 55 × 178 cm             | 55 × 173 cm             | 55 × 173 cm             | 55 × 173 cm             | 55 × 173 cm             |
| Single window W × H          | 65 × 65 cm              | 65 × 65 cm              | 65 × 65 cm              | 65 × 65 cm              | 65 × 65 cm              | 65 × 65 cm              |
| 2 × single window W × H      | 150 × 54 cm             | 150 × 54 cm             | 150 × 51 cm             | 150 × 51 cm             | 150 × 51 cm             | 150 × 51 cm             |
| Double window W × H          | 110 × 178 cm            | 110 × 178 cm            | 110 × 173 cm            | 110 × 173 cm            | 110 × 173 cm            | 110 × 173 cm            |
| Floor thickness              | 18 mm                   | 18 mm                   | 18 mm                   | 18 mm                   | 18 mm                   | 18 mm                   |
| Roof covering, optional      | 6 × 10 m                | 6 × 10 m                | 6 × 10 m                | 6 × 10 m                | 6 × 10 m                | 6 × 10 m                |
| Onduline, optional           | 9 × 5 m                 | 9 × 5 m                 | 9 × 5 m                 | 9 × 5 m                 | 9 × 5 m                 | 9 × 5 m                 |

\*Platinum: Window opening system: 2-hand tilt & turn. Door opening: outwards. Locking system: Cylinder  
 \*\*Diamond: Window opening system: 1-hand tilt & turn. Door opening: outwards/inwards. Locking system: various lock types

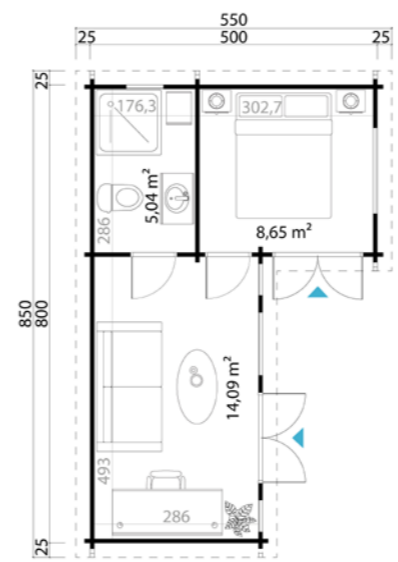



Reverse installation possible

Select your door and window quality.

Fixed double window

Fixed double window

Malmö Platinum: Premium door with 3.0 insulation value

Malmö Diamond: Premium door with 2.8 insulation value

4 separate rooms

Ladder to upstairs loft

With optional terrace

39.8 m<sup>2</sup>

# MALMÖ

## MODERN LIGHT-FILLED PENT ROOM CABIN WITH LARGE LOFT SLEEPING AREA.



SNAP & WATCH

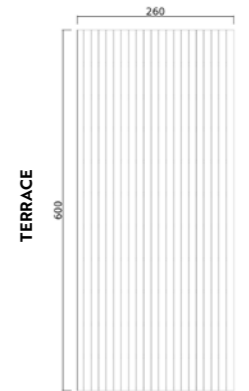
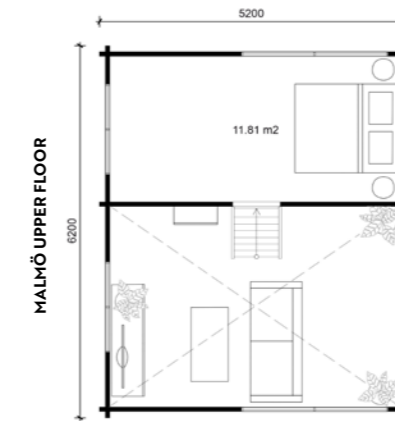
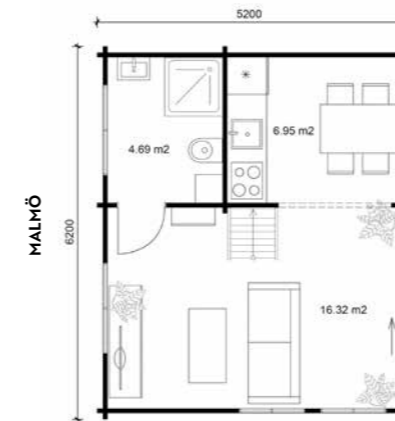

|                                | MALMÖ PLATINUM*       | MALMÖ DIAMOND**       | TERRACE      | ROOF OVERHANG |
|--------------------------------|-----------------------|-----------------------|--------------|---------------|
| Item number                    | 7015041               | 7015044               | 9902400      | 9902500       |
| Base dimensions W x D          | 600 x 500 cm          | 600 x 500 cm          | 600 x 260 cm | 586 x 270 cm  |
| Wall thickness                 | 70 mm                 | 70 mm                 |              |               |
| Floor area                     | 30 m <sup>2</sup>     | 30 m <sup>2</sup>     |              |               |
| Interior                       | 39.80 m <sup>2</sup>  | 39.80 m <sup>2</sup>  |              |               |
| Volume                         | 107.17 m <sup>3</sup> | 107.17 m <sup>3</sup> |              |               |
| Side wall height               | 272 cm                | 272 cm                |              |               |
| Ridge height                   | 481 cm                | 481 cm                |              |               |
| Roof overhang                  | 40 cm                 | 40 cm                 |              |               |
| Roof area                      | 37.80 m <sup>2</sup>  | 37.80 m <sup>2</sup>  |              |               |
| Sliding door W x H             | 250 x 200 cm          | 250 x 200 cm          |              |               |
| Single door W x H              | 83 x 193 cm           | 83 x 193 cm           |              |               |
| Double window W x H            | 160 x 173 cm          | 160 x 173 cm          |              |               |
| Fixed double window W x H      | 250 x 78 cm           | 250 x 78 cm           |              |               |
| Double window W x H            | 160 x 78 cm           | 160 x 78 cm           |              |               |
| 2 x double window W x H        | 110 x 173 cm          | 110 x 173 cm          |              |               |
| 2 x double window W x H        | 150 x 51 cm           | 150 x 51 cm           |              |               |
| 2 x fixed double window W x H  | 246 x 128 cm          | 246 x 128 cm          |              |               |
| Floor thickness                | 28 mm                 | 28 mm                 |              |               |
| Roof covering, optional        | 4 x 15 m              | 4 x 15 m              |              |               |
| Roof shingles, optional (pack) | 14                    | 14                    |              |               |

\*Platinum: Window opening system: 2-hand tilt & turn. Door opening: outwards. Locking system: Cylinder

\*\*Diamond: Window opening system: 1-hand tilt & turn. Door opening: outwards/inwards. Locking system: various lock types





Reverse installation possible

Select your door and window quality.

Örebro Platinum: Premium door with 3.0 insulation value

Örebro Diamond: Premium door with 2.8 insulation value

4 separate rooms

Ladder to upstairs loft

39.8 m<sup>2</sup>

# ÖREBRO

## THE HUGE WINDOW FRONTAGE ALLOWS LIGHT TO FLOOD IN. WITH EXTRA LOFT SPACE.



|                                | ÖREBRO PLATINUM*      | ÖREBRO DIAMOND**      |
|--------------------------------|-----------------------|-----------------------|
| Item number                    | 7014941               | 7014944               |
| <b>Base dimensions W × D</b>   | <b>500 × 600 cm</b>   | <b>500 × 600 cm</b>   |
| Wall thickness                 | 70 mm                 | 70 mm                 |
| Floor area                     | 30 m <sup>2</sup>     | 30 m <sup>2</sup>     |
| Interior                       | 39.80 m <sup>2</sup>  | 39.80 m <sup>2</sup>  |
| Volume                         | 101.40 m <sup>3</sup> | 101.40 m <sup>3</sup> |
| Side wall height               | 258 cm                | 258 cm                |
| Ridge height                   | 466 cm                | 466 cm                |
| Roof overhang                  | 60 cm                 | 60 cm                 |
| Roof area                      | 51.30 m <sup>2</sup>  | 51.30 m <sup>2</sup>  |
| Double door W × H              | 158 × 193 cm          | 158 × 193 cm          |
| 2 × single door W × H          | 83 × 193 cm           | 83 × 193 cm           |
| Double window W × H            | 160 × 173 cm          | 160 × 173 cm          |
| 2 × fixed single window W × H  | 160 × 145 cm          | 160 × 145 cm          |
| 3 × single window W × H        | 92 × 92 cm            | 92 × 92 cm            |
| Floor thickness                | 28 mm                 | 28 mm                 |
| Roof covering, optional        | 5 × 15 m              | 5 × 15 m              |
| Roof shingles, optional (pack) | 20                    | 20                    |

\*Platinum: Window opening system: 2-hand tilt & turn. Door opening: outwards. Locking system: Cylinder  
 \*\*Diamond: Window opening system: 1-hand tilt & turn. Door opening: outwards/inwards. Locking system: various lock types

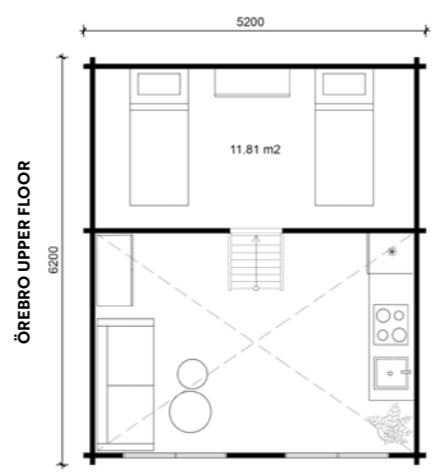
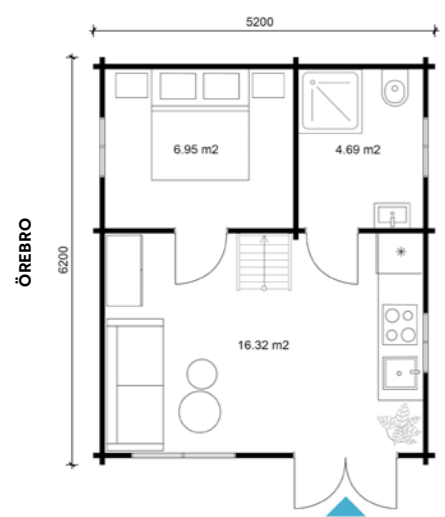

WITH A TERRACE ADDITION ÖREBRO WILL BE EVEN MORE COMFORTABLE.

### APPROPRIATE ACCESSORIES



Other accessories can be found from page 102.



# JAVA

## SOLID GARDEN CABIN WITH THREE ROOMS. METAL ROOF EDGING BOARDS FOR A HIGH-QUALITY LOOK.

|                              | JAVA                     |
|------------------------------|--------------------------|
| Item number                  | 4415802                  |
| <b>Base dimensions W x D</b> | <b>608 x 390 + 60 cm</b> |
| Wall thickness               | 44 mm                    |
| Floor area                   | 23.70 m <sup>2</sup>     |
| Terrace area                 | 3.60 m <sup>2</sup>      |
| Interior                     | 22.60 m <sup>2</sup>     |
| Volume                       | 53.40 m <sup>3</sup>     |
| Side wall height             | 234 cm                   |
| Ridge height                 | 260 cm                   |
| Roof overhang                | 60 cm                    |
| Roof area                    | 30.50 m <sup>2</sup>     |
| Glazed double door W x H     | 391 x 196 cm             |
| 2 x single door W x H        | 84 x 190 cm              |
| Fixed window W x H           | 150 x 41 cm              |
| Floor thickness              | 18 mm                    |
| Roof covering, optional      | 3 x 15 m                 |
| Onduline, optional           | 8 x 5 m                  |

### APPROPRIATE ACCESSORIES



Onduline



Gutter

Other accessories can be found from page 102.



22.6 m<sup>2</sup>



SNAP & WATCH

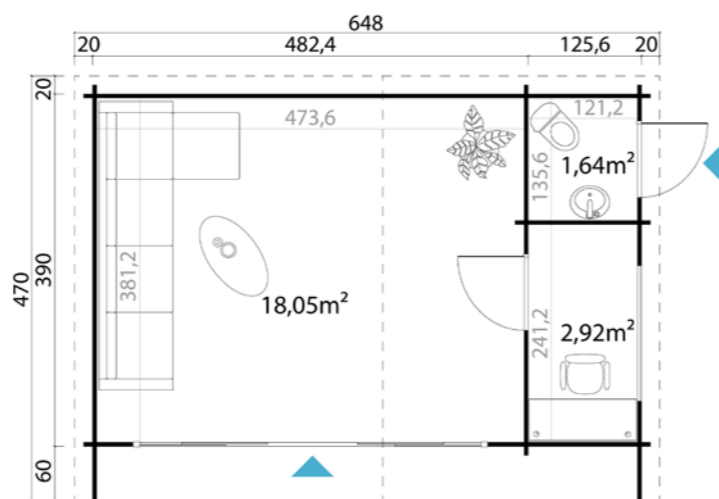



# FLAT ROOF.

TIMELESS LOOK. BLENDS SEAMLESSLY  
INTO ANY GARDEN STYLE.

07

MODELS

03

WALL  
THICK-  
NESSES







11 m<sup>2</sup>

Dorset 73



Reverse installation possible in natural

Dorset 71



Reverse installation possible in natural

Dorset 72



SNAP & WATCH

# DORSET MODERN DESIGN, DOUBLE DOORS AND LARGE WINDOWS – FOR A PERFECT WORKING ATMOS- PHERE.

|                          | DORSET 71            | DORSET 72            | DORSET 73            |
|--------------------------|----------------------|----------------------|----------------------|
| Item number              | 709502               | 709602               | 709702               |
| Base dimensions W × D    | 400 × 250 cm         | 450 × 250 cm         | 480 × 250 cm         |
| Wall thickness           | 70 mm                | 70 mm                | 70 mm                |
| Floor area               | 10 m <sup>2</sup>    | 11.25 m <sup>2</sup> | 12 m <sup>2</sup>    |
| Interior                 | 9.10 m <sup>2</sup>  | 10.30 m <sup>2</sup> | 11 m <sup>2</sup>    |
| Volume                   | 20.75 m <sup>3</sup> | 23.79 m <sup>3</sup> | 25.43 m <sup>3</sup> |
| Side wall height         | 224 cm               | 224 cm               | 224 cm               |
| Ridge height             | 239 cm               | 239 cm               | 239 cm               |
| Roof overhang            | 80 cm                | 80 cm                | 80 cm                |
| Roof area                | 16.56 m <sup>2</sup> | 18.36 m <sup>2</sup> | 19.44 m <sup>2</sup> |
| Glazed double door W × H | 158 × 193 cm         | 158 × 193 cm         | 158 × 193 cm         |
| Double window W × H      | 110 × 173 cm         | 110 × 173 cm         | 2 × 110 × 173 cm     |
| Single window            | –                    | 55 × 173 cm          | –                    |
| Floor thickness          | 18 mm                | 18 mm                | 18 mm                |
| Roof covering, optional  | 2 × 10 m             | 2 × 15 m             | 3 × 15 m             |
| Onduline, optional       | 4 × 5 m              | 5 × 5 m              | 5 × 5 m              |

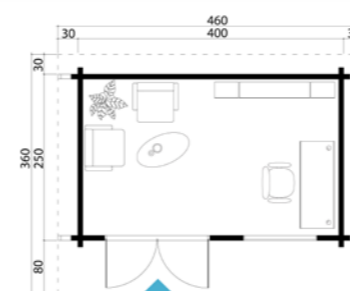

DORSET 71

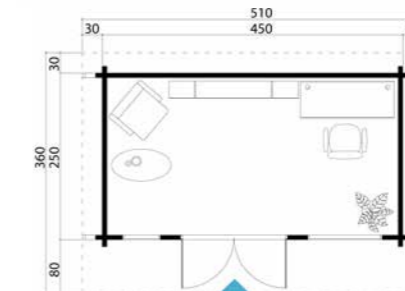

DORSET 72

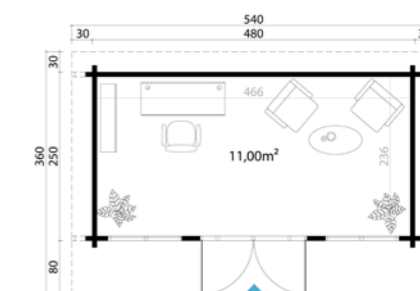

DORSET 73





22.6 m<sup>2</sup>

Porthole window



SNAP & WATCH

## GLENCOE

### MODERN, SPACE-SAVING PURIST. WITH PORTHOLE WINDOW FOR STYLE.

|                              | GLENCOE              |
|------------------------------|----------------------|
| Item number                  | 7013302              |
| <b>Base dimensions W x D</b> | <b>600 x 400 cm</b>  |
| Wall thickness               | 70 mm                |
| Floor area                   | 24 m <sup>2</sup>    |
| Terrace area                 | 7.20 m <sup>2</sup>  |
| Interior                     | 22.60 m <sup>2</sup> |
| Volume                       | 53.10 m <sup>3</sup> |
| Side wall height             | 224 cm               |
| Ridge height                 | 243 cm               |
| Roof overhang                | 130 cm               |
| Roof area                    | 37.4 m <sup>2</sup>  |
| Bi-fold door W x H           | 260 x 200 cm         |
| Round window W x H           | 104 x 104 cm         |
| Floor thickness              | 18 mm                |
| Roof covering, optional      | 4 x 15 m             |
| Onduline, optional           | 9 x 5 m              |

Diamond doors and Platinum windows

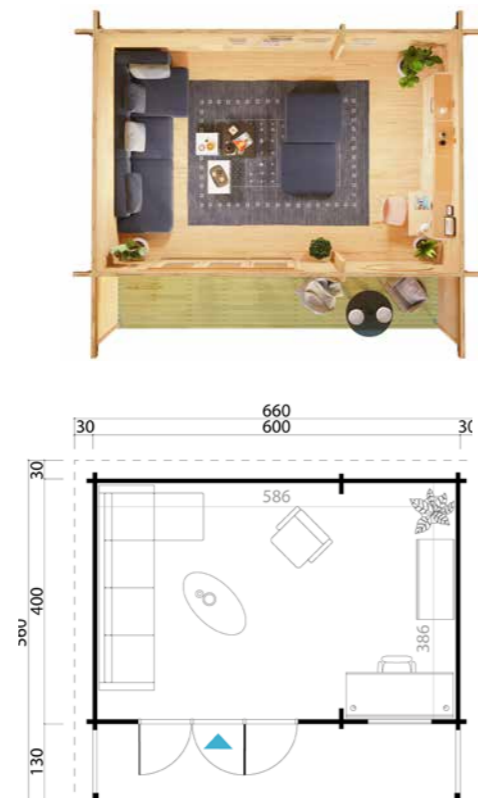

19.1 m<sup>2</sup>

Exeter 1

Exeter 1: 3 separate rooms

Reverse installation possible in natural

Including impregnated terrace



Exeter 2



SNAP & WATCH

## EXETER

### ELEGANT DESIGN WITH ADDITIONAL SPACE OPTION. FOR EVEN MORE ROOM.

|                              | EXETER 1                  | EXETER 2                  |
|------------------------------|---------------------------|---------------------------|
| Item number                  | 7012202                   | 7012302                   |
| <b>Base dimensions W x D</b> | <b>390 x 524 + 120 cm</b> | <b>390 x 397 + 120 cm</b> |
| Wall thickness               | 70 mm                     | 70 mm                     |
| Floor area                   | 20.40 m <sup>2</sup>      | 15.40 m <sup>2</sup>      |
| Terrace area                 | 4.30 m <sup>2</sup>       | 4.30 m <sup>2</sup>       |
| Interior                     | 19.10 m <sup>2</sup>      | 14.40 m <sup>2</sup>      |
| Volume                       | 44.99 m <sup>3</sup>      | 33.78 m <sup>3</sup>      |
| Side wall height             | 224 cm                    | 224 cm                    |
| Ridge height                 | 241 cm                    | 242 cm                    |
| Roof overhang                | 120 cm                    | 120 cm                    |
| Roof area                    | 30.33 m <sup>2</sup>      | 24.62 m <sup>2</sup>      |
| 2 x single door W x H        | 83 x 193 cm               | -                         |
| Bi-fold door W x H           | 260 x 200 cm              | 260 x 200 cm              |
| 3 x single window W x H      | 55 x 173 cm               | 55 x 173 cm               |
| Single window W x H          | 51 x 51 cm                | -                         |
| Single window W x H          | 150 x 51 cm               | -                         |
| Floor thickness              | 28 mm                     | 28 mm                     |
| Roof covering, optional      | 4 x 10 m                  | 3 x 10 m                  |
| Onduline, optional           | 8 x 5 m                   | 7 x 5 m                   |

Diamond doors and Platinum windows



EXETER 1



EXETER 2





Modern, minimalist design with large roof overhang

26.9 m<sup>2</sup> Brava



Brava 2



Brava 2 with terrace

Terrace included with Brava 2 model



# BRAVA

## TIMELESS MODEL FOR "MORE LIFE IN THE GARDEN".

### APPROPRIATE ACCESSORIES



**Onduline**  
Other accessories can be found from page 102.

|                          | BRAVA                | BRAVA 2              | TERRACE BRAVA |
|--------------------------|----------------------|----------------------|---------------|
| Item number              | 4419402              | 4425102              | 4425300       |
| Base dimensions W × D    | 400 × 700 cm         | 350 × 700 cm         | 350 × 250 cm  |
| Wall thickness           | 44 mm                | 44 mm                |               |
| Floor area               | 28 m <sup>2</sup>    | 24.5 m <sup>2</sup>  |               |
| Interior                 | 26.89 m <sup>2</sup> | 23.44 m <sup>2</sup> |               |
| Volume                   | 66.30 m <sup>3</sup> | 61.20 m <sup>3</sup> |               |
| Side wall height         | 239 cm               | 239 cm               |               |
| Ridge height             | 251 cm               | 251 cm               |               |
| Roof overhang            | 25 cm                | 25 cm                |               |
| Roof area                | 51.76 m <sup>2</sup> | 43.3 m <sup>2</sup>  |               |
| Glazed double door W × H | 266 × 196 cm         | 266 × 196 cm         |               |
| 1 × single door W × H    | –                    | 84 × 196 cm          |               |
| Double window W × H      | 101 × 178 cm         | –                    |               |
| 2 × single window W × H  | 150 × 41 cm          | –                    |               |
| 2 × single window W × H  | 56 × 178 cm          | 56 × 178 cm          |               |
| Floor thickness          | 18 mm                | 18 mm                |               |
| Onduline, optional       | 13 × 5 m             | 11 × 5 m             |               |

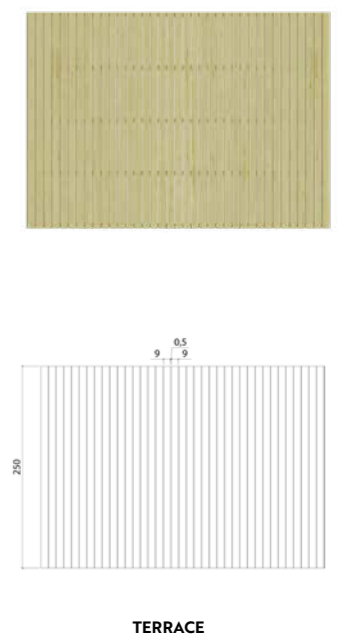
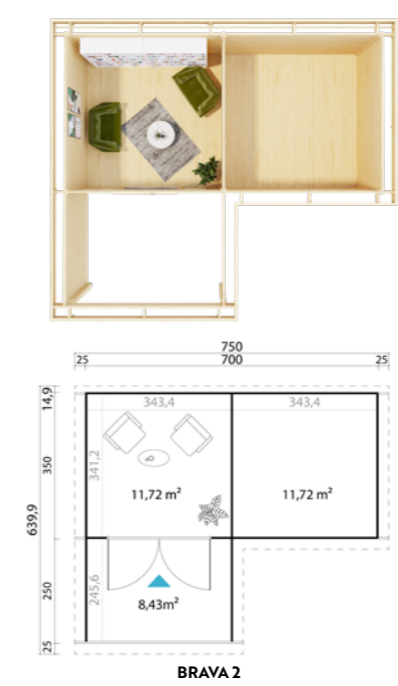



Reverse installation possible in natural

Barbados 5



19.4 m<sup>2</sup>

# BARBADOS MODERN PENT ROOF MODEL WITH EXTRA LARGE FLOOR-TO-CEILING GLASS PANELS.



Barbados 2



Reverse installation possible in natural

Double wall construction

11.4 m<sup>2</sup>

Barbados 3



Expand your garden cabin with our practical lean-to shed. For more information on this see page 44.



Barbados 2 and 5 Double are holiday homes with 244 mm thick double walls. This enables the gap between the walls to be insulated, allowing the holiday homes to be used all year round. We recommend using a professional installation service, as the assembly is more complex than with classic garden cabins.

|                          | BARBADOS 2 GOLD      | BARBADOS 3 PLATINUM  | BARBADOS 5 PLATINUM  |
|--------------------------|----------------------|----------------------|----------------------|
| Item number              | 4414502              | 7011602              | 7010702              |
| Base dimensions W x D    | 519 x 339 cm         | 399 x 309 cm         | 519 x 399 cm         |
| Wall thickness           | 44 mm                | 70 mm                | 70 mm                |
| Floor area               | 17.60 m <sup>2</sup> | 12.30 m <sup>2</sup> | 20.70 m <sup>2</sup> |
| Interior                 | 16.90 m <sup>2</sup> | 11.40 m <sup>2</sup> | 19.40 m <sup>2</sup> |
| Volume                   | 37.45 m <sup>3</sup> | 25.87 m <sup>3</sup> | 43.63 m <sup>3</sup> |
| Side wall height         | 209 cm               | 211 cm               | 211 cm               |
| Ridge height             | 239 cm               | 242 cm               | 241 cm               |
| Roof overhang            | 80 cm                | 80 cm                | 80 cm                |
| Roof area                | 26.06 m <sup>2</sup> | 19.20 m <sup>2</sup> | 29.40 m <sup>2</sup> |
| Glazed double door W x H | 159 x 196 cm         | 158 x 193 cm         | 158 x 193 cm         |
| 3 x single window W x H  | 56 x 178 cm          | 55 x 173 cm          | 55 x 173 cm          |
| Floor thickness          | 18 mm                | 18 mm                | 18 mm                |
| Roof covering, optional  | 3 x 15 m             | 2 x 15 m             | 5 x 10 m             |
| Onduline, optional       | 7 x 5 m              | 5 x 5 m              | 8 x 5 m              |

## APPROPRIATE ACCESSORIES



Onduline



Infrared heater

Other accessories can be found from page 102.

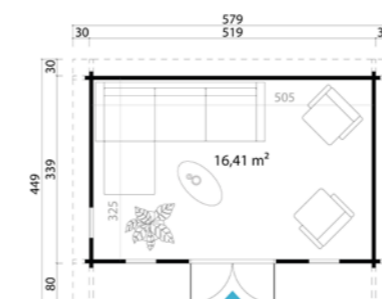

BARBADOS 2

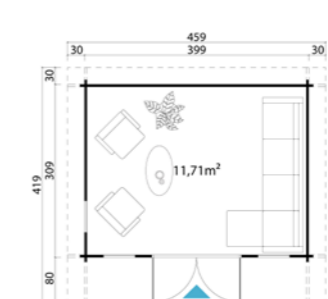

BARBADOS 3

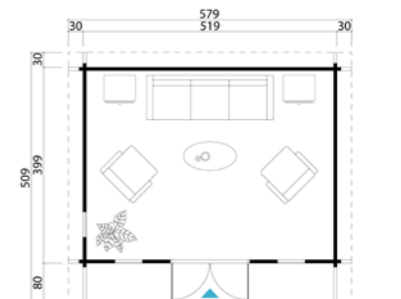

BARBADOS 5





## BARBADOS MINI PRACTICAL PENT ROOF CABIN. IDEAL FOR THE COMPACT GARDEN.

|                              | BARBADOS MINI        | ANBAU 200           | ANBAU 260           |
|------------------------------|----------------------|---------------------|---------------------|
| Item number                  | 4415040              | 2829200             | 2829600             |
| <b>Base dimensions W x D</b> | <b>330 x 240 cm</b>  | <b>120 x 200 cm</b> | <b>140 x 260 cm</b> |
| Wall thickness               | 44 mm                | 28 mm               | 28 mm               |
| Floor area                   | 7.90 m <sup>2</sup>  | 2.40 m <sup>2</sup> | 3.60 m <sup>2</sup> |
| Interior                     | 7.40 m <sup>2</sup>  | 2.30 m <sup>2</sup> | 3.50 m <sup>2</sup> |
| Volume                       | 16.50 m <sup>3</sup> | 4.44 m <sup>3</sup> | 6.82 m <sup>3</sup> |
| Side wall height             | 209 cm               | 188 cm              | 188 cm              |
| Ridge height                 | 239 cm               | 212 cm              | 213 cm              |
| Roof overhang                | 80 cm                | 10 cm               | 20 cm               |
| Roof area                    | 13.70 m <sup>2</sup> | 2.88 m <sup>2</sup> | 4.40 m <sup>2</sup> |
| Door W x H                   | 149 x 196 cm         | 84 x 185 cm         | 84 x 185 cm         |
| 2 x single window W x H      | 56 x 178 cm          | —                   | —                   |
| Floor thickness              | 18 mm                | 18 mm               | 18 mm               |
| Roof covering, optional      | 2 x 10 m             | 1 x 10 m            | 1 x 10 m            |
| Onduline, optional           | 4 x 5 m              | 1 x 5 m             | 2 x 5 m             |

Including impregnated substructure



SNAP & WATCH



Suitable for garden cabins from a wall depth of 200 cm. Ideal as a store room – perfectly suited for our Barbados Series or other pent roof models

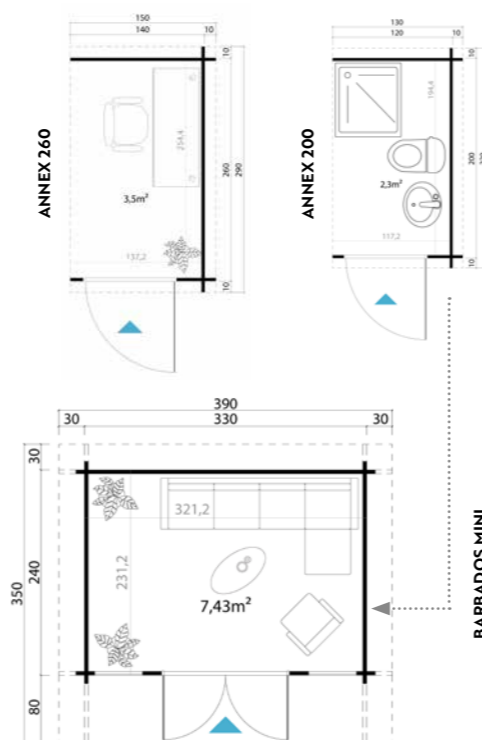

## ORKNEY COSY FLAT-ROOFED CABIN WITH FLOOR-TO-CEILING WINDOWS AND DOUBLE DOOR ENTRANCE.

|                              | ORKNEY               |
|------------------------------|----------------------|
| Item number                  | 4413802              |
| <b>Base dimensions W x D</b> | <b>520 x 390 cm</b>  |
| Wall thickness               | 44 mm                |
| Floor area                   | 17.20 m <sup>2</sup> |
| Terrace area                 | 3.10 m <sup>2</sup>  |
| Interior                     | 16.40 m <sup>2</sup> |
| Volume                       | 44.43 m <sup>3</sup> |
| Side wall height             | 222 cm               |
| Ridge height                 | 234 cm               |
| Roof overhang                | 30 cm                |
| Roof area                    | 26.13 m <sup>2</sup> |
| Glazed double door W x H     | 159 x 196 cm         |
| 2 x single window W x H      | 56 x 178 cm          |
| Floor thickness              | 18 mm                |
| Roof covering, optional      | 3 x 15 m             |
| Onduline, optional           | 7 x 5 m              |

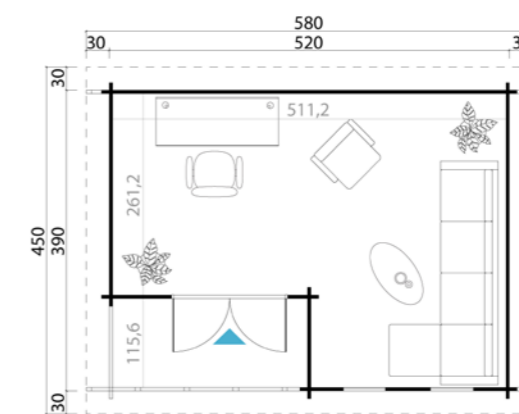

### APPROPRIATE ACCESSORIES



Lean-to shed see p. 44



Infrared heater

Other accessories can be found from page 102



# GABLED ROOF.

CLASSICS REDEFINED.  
PROVEN DESIGN FOR RELAXATION.

49

MODELS

03

WALL  
THICK-  
NESSES







16.8 m<sup>2</sup>

Shetland 1



Shetland 2

## SHETLAND EXTRA BRIGHT ROOMS AND LOTS OF SPACE FOR CREATIVITY.

|                                | SHETLAND 1           | SHETLAND 2           |
|--------------------------------|----------------------|----------------------|
| Item number                    | 7011002              | 7011202              |
| <b>Base dimensions W × D</b>   | <b>600 × 300 cm</b>  | <b>600 × 300 cm</b>  |
| Wall thickness                 | 70 mm                | 70 mm                |
| Floor area                     | 18 m <sup>2</sup>    | 18 m <sup>2</sup>    |
| Interior                       | 16.80 m <sup>2</sup> | 16.80 m <sup>2</sup> |
| Volume                         | 38.18 m <sup>3</sup> | 38.18 m <sup>3</sup> |
| Side wall height               | 204 cm               | 204 cm               |
| Ridge height                   | 245 cm               | 245 cm               |
| Roof overhang                  | 30 cm                | 30 cm                |
| Roof area                      | 23.90 m <sup>2</sup> | 23.90 m <sup>2</sup> |
| Glazed double door W × H       | 158 × 187 cm         | 158 × 187 cm         |
| Double window W × H            | 3 × 110 × 173 cm     | 2 × 110 × 173 cm     |
| Floor thickness                | 18 mm                | 18 mm                |
| Roof covering, optional        | 2 × 15 m             | 2 × 15 m             |
| Roof shingles, optional (pack) | 10                   | 10                   |

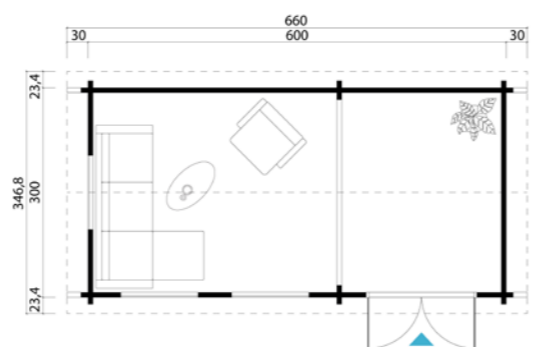

18.7 m<sup>2</sup>

Staffordshire 2



Staffordshire 1

## STAFFORDSHIRE WITH COVERED TERRACE WHICH EN- TICES YOU TO LINGER.

|                                | STAFFORDSHIRE 1           | STAFFORDSHIRE 2           |
|--------------------------------|---------------------------|---------------------------|
| Item number                    | 7012402                   | 7012502                   |
| <b>Base dimensions W × D</b>   | <b>540 × 370 + 150 cm</b> | <b>540 × 370 + 150 cm</b> |
| Wall thickness                 | 70 mm                     | 70 mm                     |
| Floor area                     | 20 m <sup>2</sup>         | 20 m <sup>2</sup>         |
| Terrace area                   | 8.10 m <sup>2</sup>       | 8.10 m <sup>2</sup>       |
| Interior                       | 18.70 m <sup>2</sup>      | 18.70 m <sup>2</sup>      |
| Volume                         | 49.02 m <sup>3</sup>      | 43.29 m <sup>3</sup>      |
| Side wall height               | 218 cm                    | 218 cm                    |
| Ridge height                   | 306 cm                    | 245 cm                    |
| Roof overhang                  | 180 cm                    | 180 cm                    |
| Roof area                      | 36.9 m <sup>2</sup>       | 36.9 m <sup>2</sup>       |
| Double door W × H              | 158 × 200 cm              | 154 × 198 cm              |
| 2 × double window W × H        | 110 × 132 cm              | 110 × 132 cm              |
| Floor thickness                | 28 mm                     | 28 mm                     |
| Roof covering, optional        | 4 × 15 m                  | 3 × 15 m                  |
| Roof shingles, optional (pack) | 14                        | 13                        |



STAFFORDSHIRE 1



STAFFORDSHIRE 2

In Staffordshire 1, the ridge is located in the centre of the cabin in the room, in Staffordshire 2, it is positioned off centre, above the outer wall of the terrace.





## LYNDHURST

**A SMALL HOLIDAY HOME WITH A COSY VERANDA AND PLENTY OF LIGHT INSIDE.**

| LYNDHURST                      |                           |
|--------------------------------|---------------------------|
| Item number                    | 7011902                   |
| <b>Base dimensions W x D</b>   | <b>550 x 300 + 100 cm</b> |
| Wall thickness                 | 70 mm                     |
| Floor area                     | 16.50 m <sup>2</sup>      |
| Terrace area                   | 5.50 m <sup>2</sup>       |
| Interior                       | 15.30 m <sup>2</sup>      |
| Volume                         | 34.40 m <sup>3</sup>      |
| Side wall height               | 197 cm                    |
| Ridge height                   | 245 cm                    |
| Roof overhang                  | 130 cm                    |
| Roof area                      | 28.88 m <sup>2</sup>      |
| Glazed door W x H              | 410 x 200 cm              |
| Floor thickness                | 18 mm                     |
| Roof covering, optional        | 6 x 10 m                  |
| Roof shingles, optional (pack) | 11                        |



## DINGWALL

**COMPACT AND CHARMING GABLE-ROOFED CLASSIC. INVITING, COSY – AND HIGHLY FUNCTIONAL.**

| DINGWALL                       |                      |
|--------------------------------|----------------------|
| Item number                    | 7013402              |
| <b>Base dimensions W x D</b>   | <b>400 x 400 cm</b>  |
| Wall thickness                 | 70 mm                |
| Floor area                     | 14.43 m <sup>2</sup> |
| Terrace area                   | 1.60 m <sup>2</sup>  |
| Interior                       | 13.30 m <sup>2</sup> |
| Volume                         | 27.71 m <sup>3</sup> |
| Side wall height               | 218 cm               |
| Ridge height                   | 245 cm               |
| Roof overhang                  | 30 cm                |
| Roof area                      | 21.50 m <sup>2</sup> |
| Double door W x H              | 158 x 200 cm         |
| 3 x single window W x H        | 70 x 119 cm          |
| Floor thickness                | 18 mm                |
| Roof covering, optional        | 3 x 10 m             |
| Roof shingles, optional (pack) | 9                    |

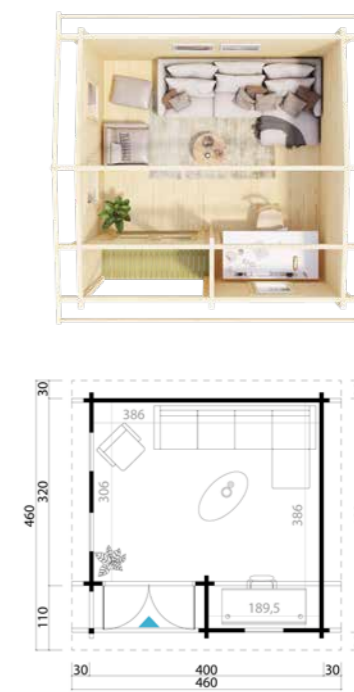



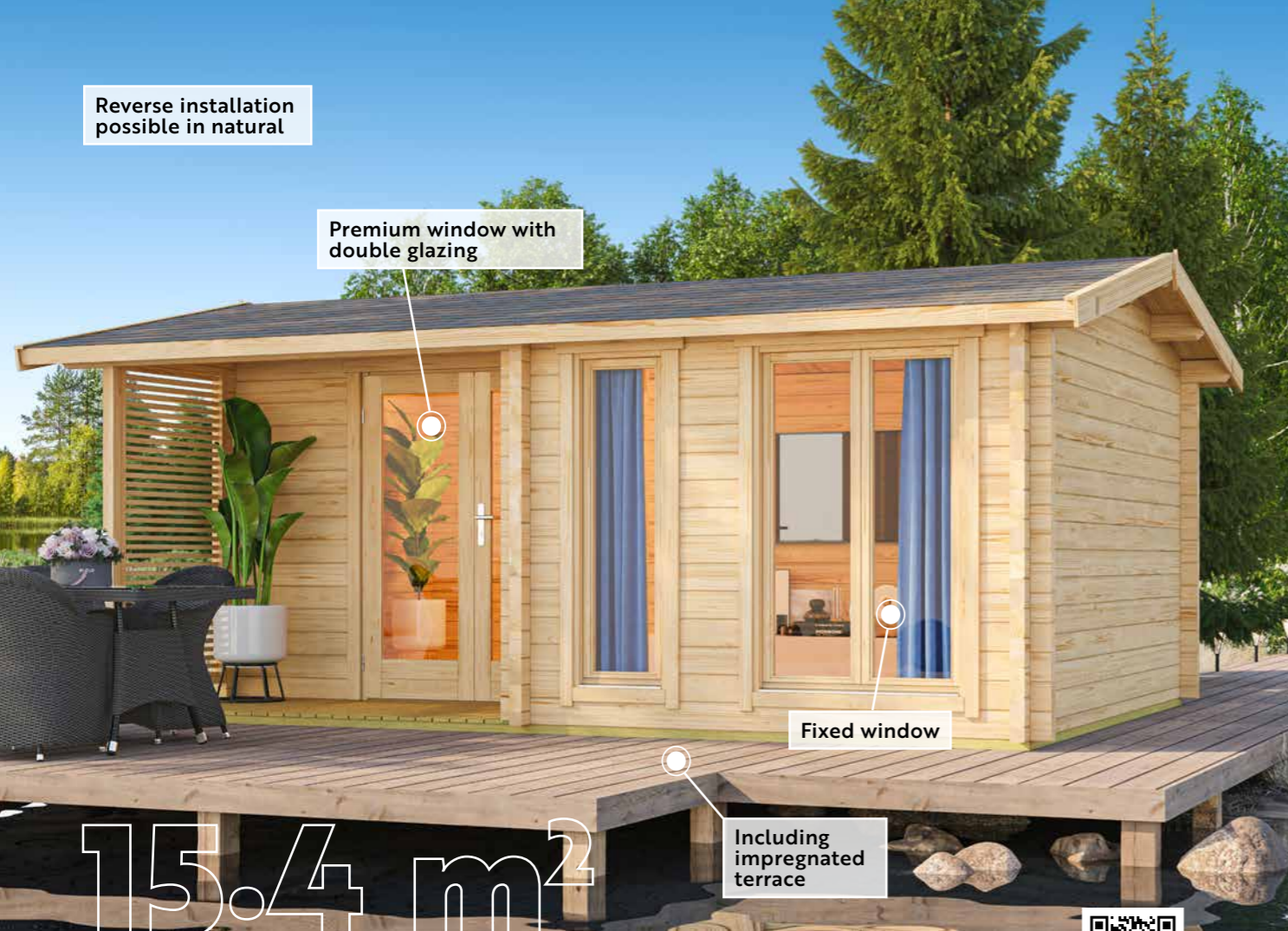

## BRIGHTON SPACIOUS, BRIGHT AND NATURAL.

|                                | BRIGHTON 44          | BRIGHTON 70          |
|--------------------------------|----------------------|----------------------|
| Item number                    | 4416902              | 7011802              |
| Base dimensions W × D          | 520 × 370 cm         | 520 × 370 cm         |
| Wall thickness                 | 44 mm                | 70 mm                |
| Floor area                     | 16.10 m <sup>2</sup> | 16.10 m <sup>2</sup> |
| Terrace area                   | 3.10 m <sup>2</sup>  | 3.10 m <sup>2</sup>  |
| Interior                       | 15.40 m <sup>2</sup> | 14.90 m <sup>2</sup> |
| Volume                         | 42.63 m <sup>3</sup> | 39.81 m <sup>3</sup> |
| Side wall height               | 211 cm               | 204 cm               |
| Ridge height                   | 251 cm               | 242 cm               |
| Roof overhang                  | 30 cm                | 30 cm                |
| Roof area                      | 25.52 m <sup>2</sup> | 25.52 m <sup>2</sup> |
| Glazed single door W × H       | 159 × 196 cm         | 158 × 200 cm         |
| Single window W × H            | 56 × 178 cm          | 55 × 173 cm          |
| Fixed window W × H             | 101 × 178 cm         | 110 × 173 cm         |
| Floor thickness                | 18 mm                | 18 mm                |
| Roof covering, optional        | 3 × 15 m             | 3 × 15 m             |
| Roof shingles, optional (pack) | 10                   | 10                   |

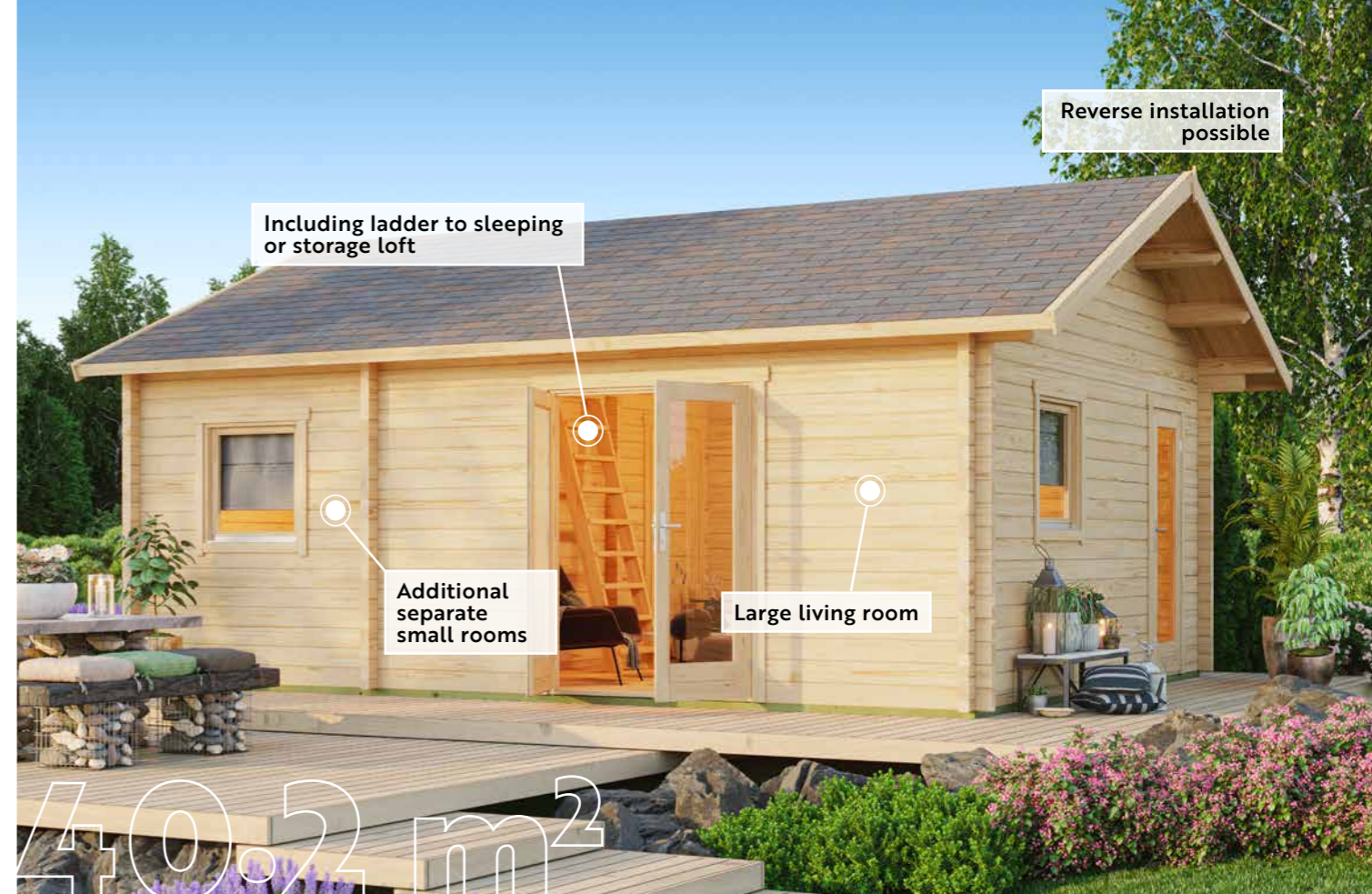
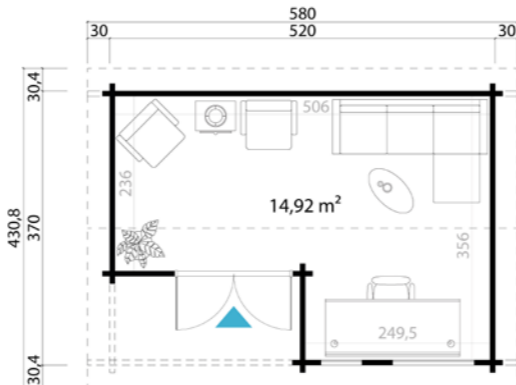

## VOLTA CLASSIC MODEL WITH LARGE TERRACE FOR EXTRA SPACE.

|                                | VOLTA                |
|--------------------------------|----------------------|
| Item number                    | 702441               |
| Base dimensions W × D          | 500 × 650 cm         |
| Wall thickness                 | 70 mm                |
| Floor area                     | 32.50 m <sup>2</sup> |
| Interior                       | 40.20 m <sup>2</sup> |
| Volume                         | 91.40 m <sup>3</sup> |
| Side wall height               | 245 cm               |
| Ridge height                   | 347 cm               |
| Roof overhang                  | 37 cm                |
| Roof area                      | 45.80 m <sup>2</sup> |
| 2 × single door W × H          | 83 × 193 cm          |
| Double door W × H              | 158 × 193 cm         |
| 3 × single window W × H        | 92 × 92 cm           |
| Single window W × H            | 65 × 65 cm           |
| Double window W × H            | 137 × 92 cm          |
| Floor thickness                | 18 mm                |
| Roof covering, optional        | 7 × 15 m             |
| Roof shingles, optional (pack) | 17                   |

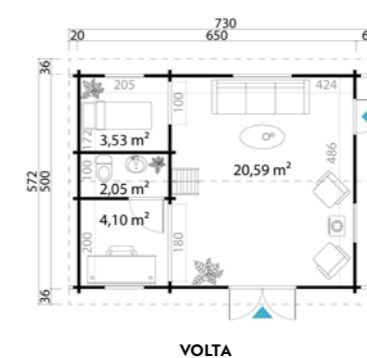
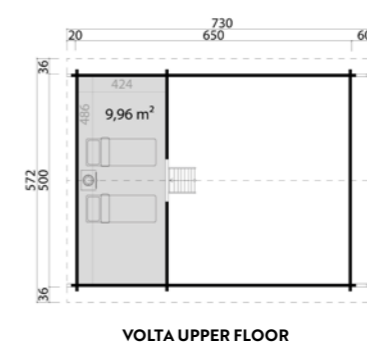



Reverse installation possible in natural

Round arch on windows and door



Premium window with double glazing



# ALEX CLASSIC GARDEN CABIN, PERFECT FOR SMALL GARDENS.

| ALEX                           |                      |
|--------------------------------|----------------------|
| Item number                    | 4414440              |
| <b>Base dimensions W x D</b>   | <b>300 x 250 cm</b>  |
| Wall thickness                 | 44 mm                |
| Floor area                     | 7.50 m <sup>2</sup>  |
| Interior                       | 7 m <sup>2</sup>     |
| Volume                         | 16.01 m <sup>3</sup> |
| Side wall height               | 211 cm               |
| Ridge height                   | 245 cm               |
| Roof overhang                  | 29 cm                |
| Roof area                      | 10.88 m <sup>2</sup> |
| Double door W x H              | 124 x 185 cm         |
| Double window W x H            | 99 x 134 cm          |
| Floor thickness                | 18 mm                |
| Roof covering, optional        | 1 x 15 m             |
| Roof shingles, optional (pack) | 5                    |

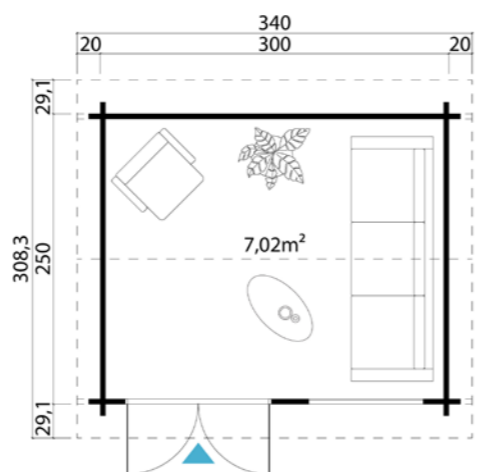

With separate storage space

Premium window with double glazing

13.9 m<sup>2</sup>



# AVIEMORE ADDITIONAL SPACE FOR A PROVEN DESIGN. PRACTICALLY DIVIDED.

| AVIEMORE PLATINUM              |                      |
|--------------------------------|----------------------|
| Item number                    | 7013202              |
| <b>Base dimensions W x D</b>   | <b>500 x 300 cm</b>  |
| Wall thickness                 | 70 mm                |
| Floor area                     | 15 m <sup>2</sup>    |
| Interior                       | 13.90 m <sup>2</sup> |
| Volume                         | 36.63 m <sup>3</sup> |
| Side wall height               | 218 cm               |
| Ridge height                   | 245 cm               |
| Roof overhang                  | 27 cm                |
| Roof area                      | 20.40 m <sup>2</sup> |
| Glazed double door W x H       | 158 x 187 cm         |
| Single door W x H              | 83 x 187 cm          |
| Double window                  | 102 x 132 cm         |
| Floor thickness                | 18 mm                |
| Roof covering, optional        | 2 x 15 m             |
| Roof shingles, optional (pack) | 9                    |

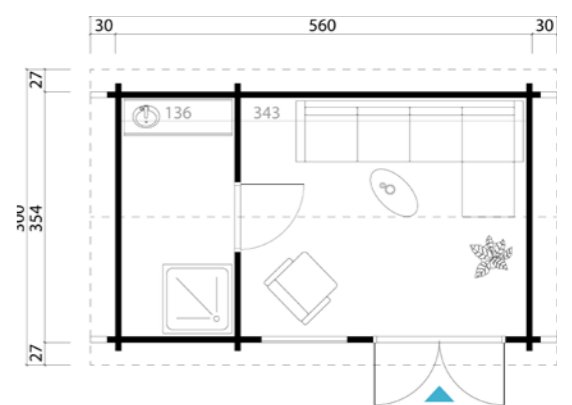



Select your window quality.



# MÄLAREN

## RETREAT WITHOUT COMPROMISE. FOR THE WHOLE FAMILY.

|                                | MÄLAREN PLATINUM      | MÄLAREN DIAMOND       |
|--------------------------------|-----------------------|-----------------------|
| Item number                    | 7013141               | 7013144               |
| <b>Base dimensions W × D</b>   | <b>941 × 833 cm</b>   | <b>941 × 833 cm</b>   |
| Wall thickness                 | 70 mm                 | 70 mm                 |
| Floor area                     | 56.30 m <sup>2</sup>  | 56.30 m <sup>2</sup>  |
| Terrace area                   | 22.10 m <sup>2</sup>  | 22.10 m <sup>2</sup>  |
| Interior                       | 101.70 m <sup>2</sup> | 101.70                |
| Volume                         | 340.73 m <sup>3</sup> | 340.73 m <sup>3</sup> |
| Side wall height               | 354 cm                | 354 cm                |
| Ridge height                   | 492 cm                | 492 cm                |
| Roof overhang                  | 70 cm                 | 70 cm                 |
| Roof area                      | 82.60 m <sup>2</sup>  | 82.60 m <sup>2</sup>  |
| 2 × glazed double door W × H   | 158 × 200 cm          | 158 × 200 cm          |
| 4 × single door W × H          | 83 × 200 cm           | 83 × 200 cm           |
| 5 × single door W × H          | 83 × 187 cm           | 83 × 187 cm           |
| Double window W × H            | 137 × 105 cm          | 137 × 105 cm          |
| 2 × single window W × H        | 92 × 92 cm            | 92 × 92 cm            |
| 3 × single window W × H        | 65 × 65 cm            | 65 × 65 cm            |
| 6 × single window W × H        | 55 × 173 cm           | 55 × 173 cm           |
| 2 × double window W × H        | 150 × 65 cm           | 150 × 65 cm           |
| 3 × double window W × H        | 180 × 65 cm           | 180 × 65 cm           |
| Floor thickness W × H          | 28 mm                 | 28 mm                 |
| Roof covering, optional        | 9 × 15 m              | 9 × 15 m              |
| Roof shingles, optional (pack) | 34                    | 34                    |

\*Platinum window: Opening system: 2-hand tilt & turn.  
 \*\*Diamond window: Opening system: 1-hand tilt & turn.

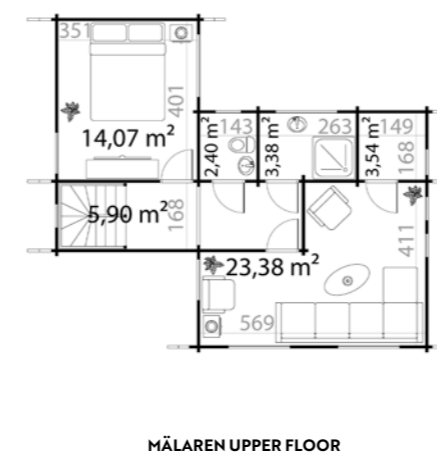
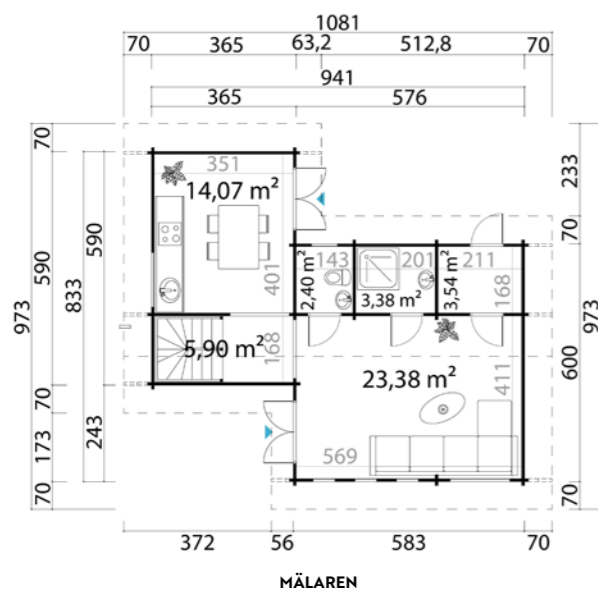



# MEKONG

## A HOLIDAY HOME WITHOUT EQUAL. FOR PURE LUXURY.

|                                | MEKONG PLATINUM*      | MEKONG DIAMOND**      |
|--------------------------------|-----------------------|-----------------------|
| Item number                    | 702241                | 702244                |
| <b>Base dimensions W x D</b>   | <b>1050 x 735 cm</b>  | <b>1050 x 735 cm</b>  |
| Wall thickness                 | 70 mm                 | 70 mm                 |
| Floor area                     | 70.10 m <sup>2</sup>  | 70.10 m <sup>2</sup>  |
| Terrace area                   | 30.70 m <sup>2</sup>  | 30.70 m <sup>2</sup>  |
| Interior                       | 103.30 m <sup>2</sup> | 103.30 m <sup>2</sup> |
| Volume                         | 212.20 m <sup>3</sup> | 212.20 m <sup>3</sup> |
| Side wall height               | 231 cm                | 231 cm                |
| Ridge height                   | 506 cm                | 506 cm                |
| Roof overhang                  | 30 cm                 | 30 cm                 |
| Roof area                      | 102.80 m <sup>2</sup> | 102.80 m <sup>2</sup> |
| 4 x single door W x H          | 83 x 200 cm           | 83 x 200 cm           |
| Double door W x H              | 158 x 200 cm          | 158 x 200 cm          |
| 1 x single window W x H        | 55 x 173 cm           | 55 x 173 cm           |
| 5 x double window W x H        | 137 x 92 cm           | 137 x 92 cm           |
| 1 x single window W x H        | 92 x 92 cm            | 92 x 92 cm            |
| 2 x single window W x H        | 65 x 65 cm            | 65 x 65 cm            |
| 3 x double window W x H        | 110 x 173 cm          | 110 x 173 cm          |
| 3 x fixed single window W x H  | 184 x 65 cm           | 184 x 65 cm           |
| Floor thickness W x H          | 28 mm                 | 28 mm                 |
| Roof covering, optional        | 12 x 15 m             | 12 x 15 m             |
| Roof shingles, optional (pack) | 37                    | 37                    |

\*Platinum window: Opening system: 2-hand tilt & turn.  
 \*\*Diamond window: Opening system: 1-hand tilt & turn.



Select your window quality.

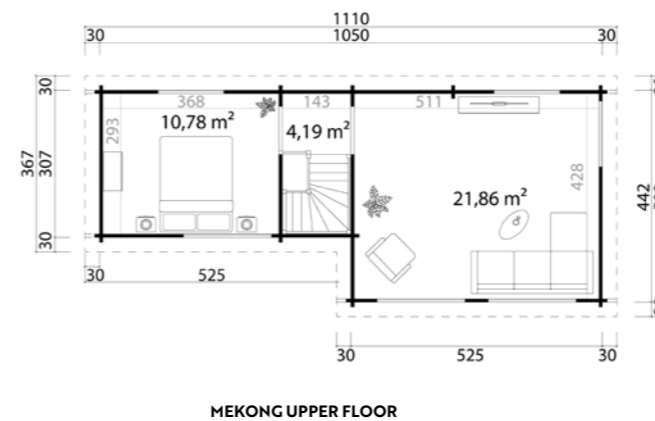



Select your window quality.

Mekong XL Platinum: Window with 2-hand tilt & turn

Mekong XL Diamond: Window with 1-hand tilt & turn

9 separate rooms

Fixed double windows

Including stairs to upper floor

Including covered terrace

127.8 m<sup>2</sup>

# MEKONG XL

## HOLIDAY AT HOME WITHOUT LIMITATIONS. COMPLETE COMFORT AND RELAXATION.

|                                | MEKONG XL PLATINUM*   | MEKONG XL DIAMOND**   |
|--------------------------------|-----------------------|-----------------------|
| Item number                    | 7012641               | 7012644               |
| Base dimensions W × D          | 1050 × 735 cm         | 1050 × 735 cm         |
| Wall thickness                 | 70 mm                 | 70 mm                 |
| Floor area                     | 70.10 m <sup>2</sup>  | 70.10 m <sup>2</sup>  |
| Terrace area                   | 30.70 m <sup>2</sup>  | 30.70 m <sup>2</sup>  |
| Interior                       | 127.80 m <sup>2</sup> | 127.80 m <sup>2</sup> |
| Volume                         | 230.60 m <sup>3</sup> | 230.60 m <sup>3</sup> |
| Side wall height               | 420 cm                | 420 cm                |
| Ridge height                   | 501 cm                | 501 cm                |
| Roof overhang                  | 30 cm                 | 30 cm                 |
| Roof area                      | 103.70 m <sup>2</sup> | 103.70 m <sup>2</sup> |
| 2 × double door W × H          | 158 × 200 cm          | 158 × 200 cm          |
| 8 × single door W × H          | 83 × 200 cm           | 83 × 200 cm           |
| 2 × double window W × H        | 137 × 92 cm           | 137 × 92 cm           |
| 3 × single window W × H        | 92 × 92 cm            | 92 × 92 cm            |
| 3 × double window W × H        | 110 × 173 cm          | 110 × 173 cm          |
| 4 × single window W × H        | 65 × 65 cm            | 65 × 65 cm            |
| 7 × fixed double window W × H  | 184 × 65 cm           | 184 × 65 cm           |
| Floor thickness W × H          | 28 mm                 | 28 mm                 |
| Roof covering, optional        | 12 × 15 m             | 12 × 15 m             |
| Roof shingles, optional (pack) | 37                    | 37                    |

\*Platinum window: Opening system: 2-hand tilt&turn.  
 \*\*Diamond window: Opening system: 1-hand tilt&turn.

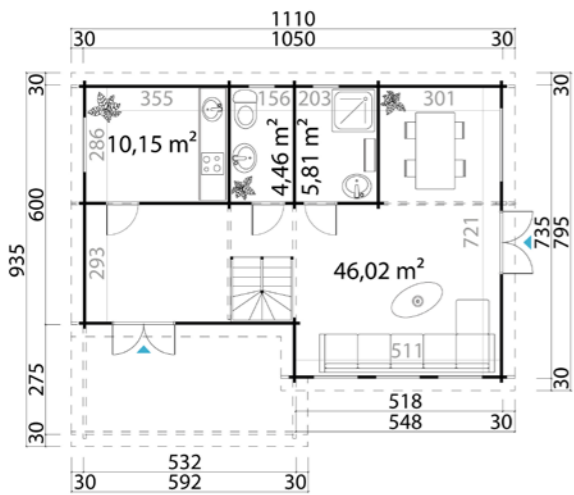

MEKONG XL



MEKONG XL

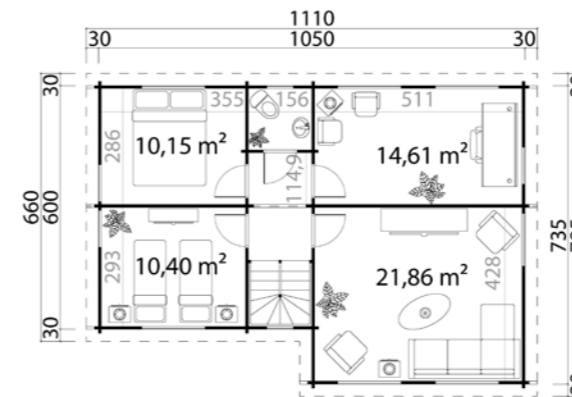

MEKONG XL UPPER FLOOR



MEKONG XL UPPER FLOOR





65.7 m<sup>2</sup>



**GANGES**  
**A DREAM HOME WITH STYLE AND LOTS OF EXTRA SPACE. THE COVERED TERRACE ENTICES YOU TO LINGER.**



GANGES



GANGES



GANGES UPPER FLOOR

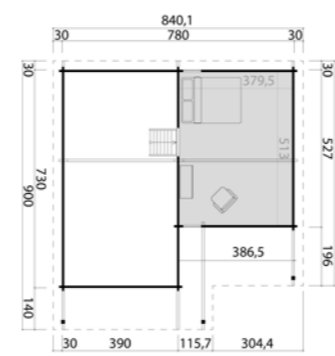

GANGES UPPER FLOOR

|                                | GANGES PLATINUM*      | GANGES DIAMOND**      |
|--------------------------------|-----------------------|-----------------------|
| Item number                    | 702041                | 702044                |
| Base dimensions W × D          | <b>780 × 730 cm</b>   | <b>780 × 730 cm</b>   |
| Wall thickness                 | 70 mm                 | 70 mm                 |
| Floor area                     | 49.10 m <sup>2</sup>  | 49.10 m <sup>2</sup>  |
| Terrace area                   | 17.20 m <sup>2</sup>  | 17.20 m <sup>2</sup>  |
| Interior                       | 65.70 m <sup>2</sup>  | 65.70 m <sup>2</sup>  |
| Volume                         | 148.50 m <sup>3</sup> | 148.50 m <sup>3</sup> |
| Side wall height               | 252 cm                | 252 cm                |
| Ridge height                   | 407 cm                | 407 cm                |
| Roof overhang                  | 140 cm                | 140 cm                |
| Roof area                      | 74.40 m <sup>2</sup>  | 74.40 m <sup>2</sup>  |
| 3 × single door W × H          | 83 × 193 cm           | 83 × 193 cm           |
| 2 × single window W × H        | 55 × 173 cm           | 55 × 173 cm           |
| 3 × single window W × H        | 65 × 65 cm            | 65 × 65 cm            |
| 1 × single window W × H        | 70 × 119 cm           | 70 × 119 cm           |
| 2 × double window W × H        | 137 × 92 cm           | 137 × 92 cm           |
| 2 × double window W × H        | 110 × 173 cm          | 110 × 173 cm          |
| Floor thickness                | 28 mm                 | 28 mm                 |
| Roof covering, optional        | 10 × 10 m             | 10 × 10 m             |
| Roof shingles, optional (pack) | 27                    | 27                    |

\*Platinum window: Opening system: 2-hand tilt&turn.

\*\*Diamond window: Opening system: 1-hand tilt&turn.



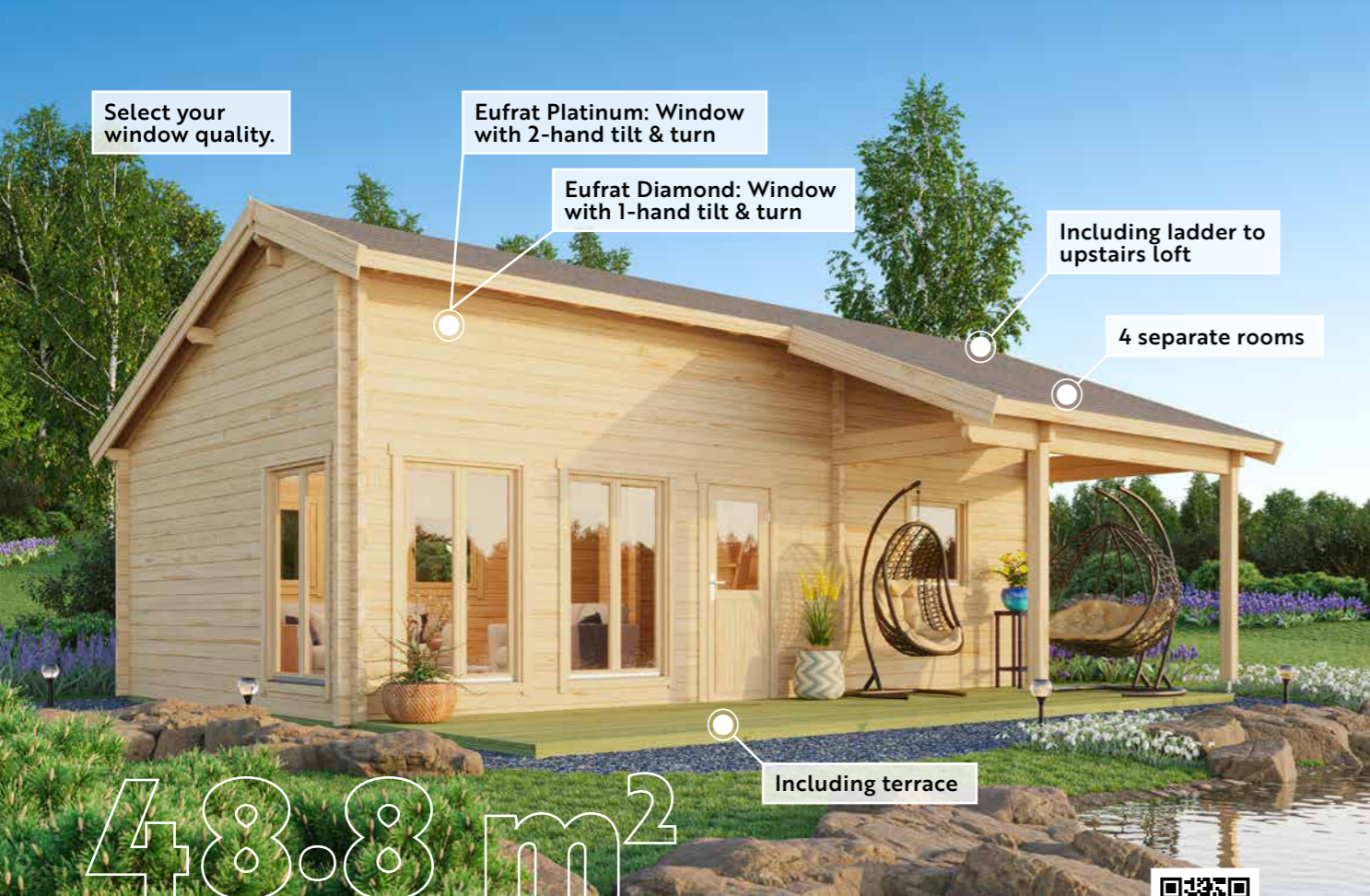

Select your window quality.

Eufrat Platinum: Window with 2-hand tilt & turn

Eufrat Diamond: Window with 1-hand tilt & turn

Including ladder to upstairs loft

4 separate rooms

Including terrace

48.8 m<sup>2</sup>



## EUFRAT ELEGANT DESIGN WITH LOFT ROOM.

|                                | EUFRAT PLATINUM*      | EUFRAT DIAMOND**      |
|--------------------------------|-----------------------|-----------------------|
| Item number                    | 701941                | 701944                |
| <b>Base dimensions W x D</b>   | <b>464 x 800 cm</b>   | <b>464 x 800 cm</b>   |
| Wall thickness                 | 70 mm                 | 70 mm                 |
| Floor area                     | 37.10 m <sup>2</sup>  | 37.10 m <sup>2</sup>  |
| Terrace area                   | 18.40 m <sup>2</sup>  | 18.40 m <sup>2</sup>  |
| Interior                       | 48.80 m <sup>2</sup>  | 48.80 m <sup>2</sup>  |
| Volume                         | 105.92 m <sup>3</sup> | 105.92 m <sup>3</sup> |
| Side wall height               | 252 cm                | 252 cm                |
| Ridge height                   | 390 cm                | 390 cm                |
| Roof overhang                  | 20 cm                 | 20 cm                 |
| Roof area                      | 60.70 m <sup>2</sup>  | 60.70 m <sup>2</sup>  |
| 3 x single door W x H          | 83 x 193 cm           | 83 x 193 cm           |
| 3 x single window W x H        | 92 x 92 cm            | 92 x 92 cm            |
| 2 x single window W x H        | 65 x 65 cm            | 65 x 65 cm            |
| 3 x double window W x H        | 110 x 173 cm          | 110 x 173 cm          |
| Floor thickness                | 28 mm                 | 28 mm                 |
| Roof covering, optional        | 9 x 15 m              | 9 x 15 m              |
| Roof shingles, optional (pack) | 23                    | 23                    |

\*Platinum window: Opening system: 2-hand tilt & turn.  
\*\*Diamond window: Opening system: 1-hand tilt & turn.

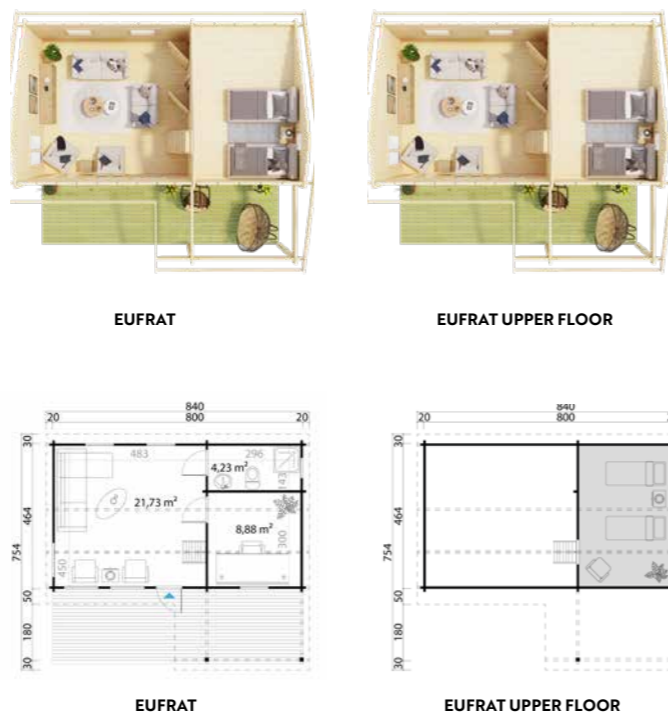

Extra long roof overhang

Ladder to upstairs loft

Select your window quality.

4 separate rooms

Including terrace

32.7 m<sup>2</sup>



## MISSOURI LIKE SOMETHING OUT OF A PICTURE BOOK. WITH LONG ROOF OVERHANG FOR BALMY SUMMER NIGHTS.

|                                | MISSOURI PLATINUM*              | MISSOURI DIAMOND**              |
|--------------------------------|---------------------------------|---------------------------------|
| Item number                    | 702541                          | 702544                          |
| <b>Base dimensions W x D</b>   | <b>184 + 430 x 560 + 100 cm</b> | <b>184 + 430 x 560 + 100 cm</b> |
| Wall thickness                 | 70 mm                           | 70 mm                           |
| Floor area                     | 24.10 m <sup>2</sup>            | 24.10 m <sup>2</sup>            |
| Terrace area                   | 16.50 m <sup>2</sup>            | 16.50 m <sup>2</sup>            |
| Interior                       | 32.70 m <sup>2</sup>            | 32.70 m <sup>2</sup>            |
| Volume                         | 74.60 m <sup>3</sup>            | 74.60 m <sup>3</sup>            |
| Side wall height               | 250 cm                          | 250 cm                          |
| Ridge height                   | 398 cm                          | 398 cm                          |
| Roof overhang                  | 130 cm                          | 130 cm                          |
| Roof area                      | 55.78 m <sup>2</sup>            | 55.78 m <sup>2</sup>            |
| 2 x double door W x H          | 158 x 193 cm                    | 158 x 193 cm                    |
| Single door W x H              | 83 x 193 cm                     | 83 x 193 cm                     |
| Single window W x H            | 92 x 92 cm                      | 92 x 92 cm                      |
| Single window W x H            | 55 x 173 cm                     | 55 x 173 cm                     |
| Single window W x H            | 70 x 119 cm                     | 70 x 119 cm                     |
| Double window W x H            | 137 x 92 cm                     | 137 x 92 cm                     |
| Floor thickness                | 28 mm                           | 28 mm                           |
| Roof covering, optional        | 5 x 15 m                        | 5 x 15 m                        |
| Roof shingles, optional (pack) | 21                              | 21                              |

\*Platinum window: Opening system: 2-hand tilt & turn.  
\*\*Diamond window: Opening system: 1-hand tilt & turn.





Select your window quality.

Mont Blanc Platinum: Window with 2-hand tilt&turn

Mont Blanc Diamond: Window with 1-hand tilt&turn

3 separate rooms

Including terrace

41.1 m<sup>2</sup>



SNAP & WATCH

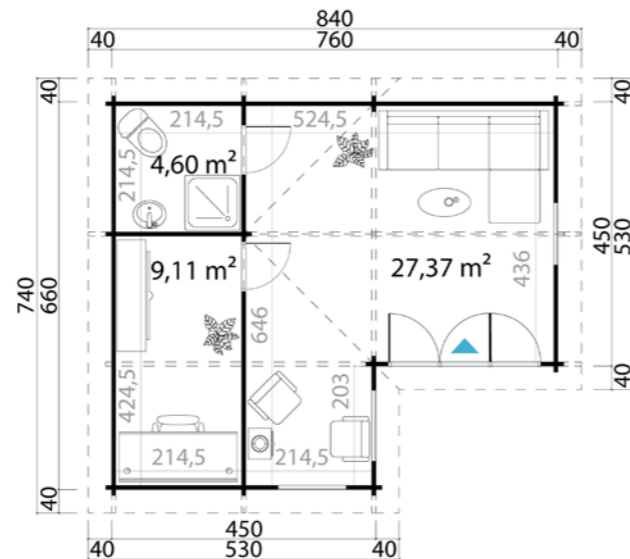

# MONT BLANC FOR THAT MOUNTAIN FEELING IN COMFORT.

|                                | MONT BLANC 70 PLATINUM* | MONT BLANC 70 DIAMOND** |
|--------------------------------|-------------------------|-------------------------|
| Item number                    | 7011341                 | 7011344                 |
| <b>Base dimensions W × D</b>   | <b>760 × 660 cm</b>     | <b>760 × 660 cm</b>     |
| Wall thickness                 | 70 mm                   | 70 mm                   |
| Floor area                     | 43.60 m <sup>2</sup>    | 43.60 m <sup>2</sup>    |
| Terrace area                   | 6.50 m <sup>2</sup>     | 6.50 m <sup>2</sup>     |
| Interior                       | 41.10 m <sup>2</sup>    | 41.10 m <sup>2</sup>    |
| Volume                         | 118.8 m <sup>3</sup>    | 118.8 m <sup>3</sup>    |
| Side wall height               | 231 cm                  | 231 cm                  |
| Ridge height                   | 347 cm                  | 347 cm                  |
| Roof overhang                  | 40 cm                   | 40 cm                   |
| Roof area                      | 58.70 m <sup>2</sup>    | 58.70 m <sup>2</sup>    |
| Bi-fold door W × H             | 260 × 200 cm            | 260 × 200 cm            |
| 2 × single door W × H          | 83 × 200 cm             | 83 × 200 cm             |
| Double window W × H            | 110 × 173 cm            | 110 × 173 cm            |
| Double window W × H            | 137 × 105 cm            | 137 × 105 cm            |
| Single window W × H            | 65 × 65 cm              | 65 × 65 cm              |
| 2 × single window W × H        | 120 × 65 cm             | 120 × 65 cm             |
| Floor thickness                | 28 mm                   | 28 mm                   |
| Roof covering, optional        | 7 × 10 m                | 7 × 10 m                |
| Roof shingles, optional (pack) | 25                      | 25                      |
|                                | MONT BLANC 92 PLATINUM* | MONT BLANC 92 DIAMOND** |
| Item number                    | 920341                  | 920344                  |
| <b>Base dimensions W × D</b>   | <b>760 × 660 cm</b>     | <b>760 × 660 cm</b>     |
| Wall thickness                 | 92 mm                   | 92 mm                   |
| Floor area                     | 43.60 m <sup>2</sup>    | 43.60 m <sup>2</sup>    |
| Terrace area                   | 6.50 m <sup>2</sup>     | 6.50 m <sup>2</sup>     |
| Interior                       | 40.40 m <sup>2</sup>    | 40.40 m <sup>2</sup>    |
| Volume                         | 115.27 m <sup>3</sup>   | 115.27 m <sup>3</sup>   |
| Side wall height               | 231 cm                  | 231 cm                  |
| Ridge height                   | 347 cm                  | 347 cm                  |
| Roof overhang                  | 40 cm                   | 40 cm                   |
| Roof area                      | 58.70 m <sup>2</sup>    | 58.70 m <sup>2</sup>    |
| Bi-fold door W × H             | 260 × 200 cm            | 260 × 200 cm            |
| 2 × single door W × H          | 83 × 200 cm             | 83 × 200 cm             |
| Double window W × H            | 110 × 173 cm            | 110 × 173 cm            |
| Double window W × H            | 137 × 105 cm            | 137 × 105 cm            |
| Single window W × H            | 65 × 65 cm              | 65 × 65 cm              |
| 2 × single window W × H        | 120 × 65 cm             | 120 × 65 cm             |
| Floor thickness                | 28 mm                   | 28 mm                   |
| Roof covering, optional        | 7 × 10 m                | 7 × 10 m                |
| Roof shingles, optional (pack) | 25                      | 25                      |

\*Platinum window: Opening system: 2-hand tilt & turn.  
\*\*Diamond window: Opening system: 1-hand tilt & turn.



# GROßGLOCKNER HOLIDAY HOME WITH THE CHARM OF AN ALPINE HUT.

|                                | GROßGLOCKNER 70 PLATINUM* | GROßGLOCKNER 70 DIAMOND** |
|--------------------------------|---------------------------|---------------------------|
| Item number                    | 7011141                   | 7011144                   |
| <b>Base dimensions W × D</b>   | <b>540 × 640 + 150 cm</b> | <b>540 × 640 + 150 cm</b> |
| Wall thickness                 | 70 mm                     | 70 mm                     |
| Floor area                     | 34.60 m <sup>2</sup>      | 34.60 m <sup>2</sup>      |
| Terrace area                   | 8.10 m <sup>2</sup>       | 8.10 m <sup>2</sup>       |
| Interior                       | 46.40 m <sup>2</sup>      | 46.40 m <sup>2</sup>      |
| Volume                         | 124.27 m <sup>3</sup>     | 124.27 m <sup>3</sup>     |
| Side wall height               | 279 cm                    | 279 cm                    |
| Ridge height                   | 487 cm                    | 487 cm                    |
| Roof overhang                  | 200 cm                    | 200 cm                    |
| Roof area                      | 69.80 m <sup>2</sup>      | 69.80 m <sup>2</sup>      |
| 3 × single door W × H          | 83 × 200 cm               | 83 × 200 cm               |
| Single window W × H            | 92 × 105 cm               | 92 × 105 cm               |
| Double window W × H            | 137 × 105 cm              | 137 × 105 cm              |
| 2 × double window W × H        | 110 × 173 cm              | 110 × 173 cm              |
| 2 × single window W × H        | 65 × 65 cm                | 65 × 65 cm                |
| Floor thickness                | 28 mm                     | 28 mm                     |
| Roof covering, optional        | 9 × 10 m                  | 9 × 10 m                  |
| Roof shingles, optional (pack) | 26                        | 26                        |

|                                | GROßGLOCKNER 92 PLATINUM* | GROßGLOCKNER 92 DIAMOND** |
|--------------------------------|---------------------------|---------------------------|
| Item number                    | 9211141                   | 9211144                   |
| <b>Base dimensions W × D</b>   | <b>540 × 640 + 150 cm</b> | <b>540 × 640 + 150 cm</b> |
| Wall thickness                 | 92 mm                     | 92 mm                     |
| Floor area                     | 34.60 m <sup>2</sup>      | 34.60 m <sup>2</sup>      |
| Terrace area                   | 8.10 m <sup>2</sup>       | 8.10 m <sup>2</sup>       |
| Interior                       | 45.80 m <sup>2</sup>      | 45.80 m <sup>2</sup>      |
| Volume                         | 121.97 m <sup>3</sup>     | 121.97 m <sup>3</sup>     |
| Side wall height               | 279 cm                    | 279 cm                    |
| Ridge height                   | 484 cm                    | 484 cm                    |
| Roof overhang                  | 200 cm                    | 200 cm                    |
| Roof area                      | 69.80 m <sup>2</sup>      | 69.80 m <sup>2</sup>      |
| 3 × single door W × H          | 83 × 200 cm               | 83 × 200 cm               |
| Single window W × H            | 92 × 105 cm               | 92 × 105 cm               |
| Double window W × H            | 137 × 105 cm              | 137 × 105 cm              |
| 2 × double window W × H        | 110 × 173 cm              | 110 × 173 cm              |
| 2 × single window W × H        | 65 × 65 cm                | 65 × 65 cm                |
| Floor thickness                | 28 mm                     | 28 mm                     |
| Roof covering, optional        | 9 × 10 m                  | 9 × 10 m                  |
| Roof shingles, optional (pack) | 26                        | 26                        |

\*Platinum window: Opening system: 2-hand tilt & turn.  
\*\*Diamond window: Opening system: 1-hand tilt & turn.

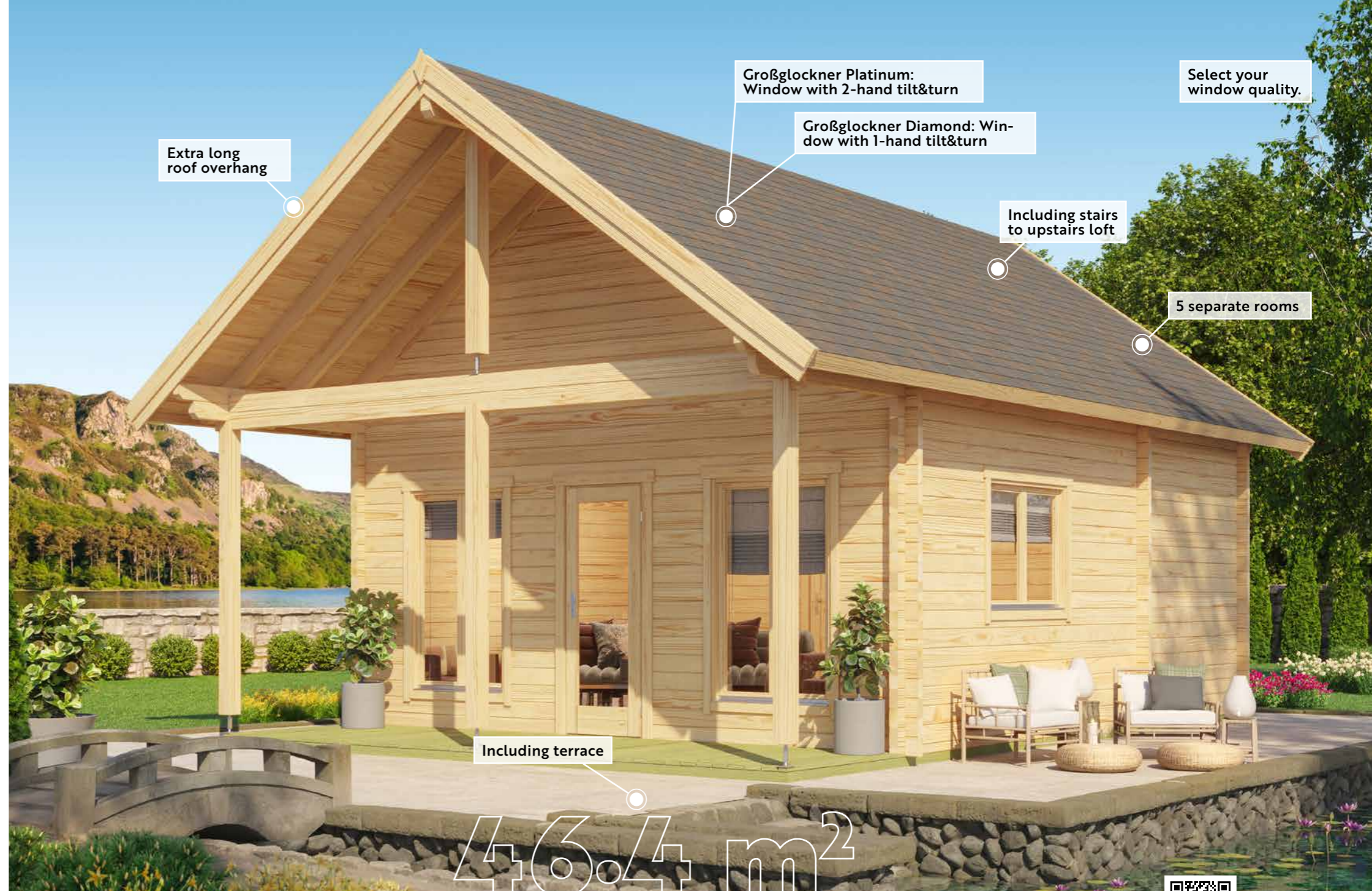

Select your window quality.

5 separate rooms

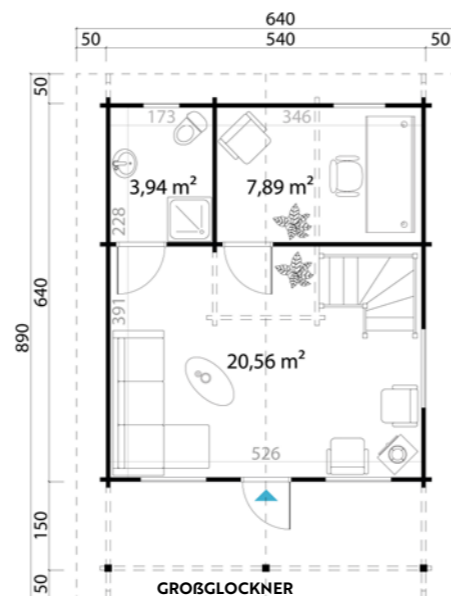

GROßGLOCKNER

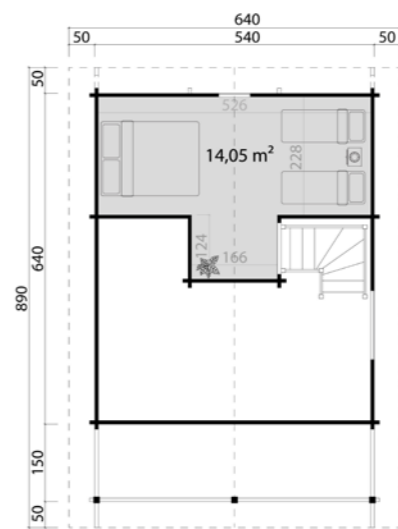

GROßGLOCKNER UPPER FLOOR



GROßGLOCKNER UPPER FLOOR





## CANADA

**PLENTY OF SPACE AND LIGHT,  
A PRACTICAL ANTEROOM SERVES  
AS A PORCH.**

|                                | CANADA PLATINUM*          | CANADA DIAMOND**          |
|--------------------------------|---------------------------|---------------------------|
| Item number                    | 703441                    | 703444                    |
| <b>Base dimensions W x D</b>   | <b>540 x 640 + 150 cm</b> | <b>540 x 640 + 150 cm</b> |
| Wall thickness                 | 70 mm                     | 70 mm                     |
| Floor area                     | 34.50 m <sup>2</sup>      | 34.50 m <sup>2</sup>      |
| Terrace area                   | 8.10 m <sup>2</sup>       | 8.10 m <sup>2</sup>       |
| Interior                       | 44 m <sup>2</sup>         | 44 m <sup>2</sup>         |
| Volume                         | 121.55 m <sup>3</sup>     | 121.55 m <sup>3</sup>     |
| Side wall height               | 252 cm                    | 252 cm                    |
| Ridge height                   | 462 cm                    | 462 cm                    |
| Roof overhang                  | 200 cm                    | 200 cm                    |
| Roof area                      | 67.65 m <sup>2</sup>      | 67.65 m <sup>2</sup>      |
| 2 x single door W x H          | 83 x 200 cm               | 83 x 200 cm               |
| Single window W x H            | 65 x 65 cm                | 65 x 65 cm                |
| 3 x single window W x H        | 92 x 105 cm               | 92 x 105 cm               |
| 3 x double window W x H        | 137 x 105 cm              | 137 x 105 cm              |
| Floor thickness                | 28 mm                     | 28 mm                     |
| Roof covering, optional        | 9 x 10 m                  | 9 x 10 m                  |
| Roof shingles, optional (pack) | 25                        | 25                        |

\*Platinum window: Opening system: 2-hand tilt & turn.  
\*\*Diamond window: Opening system: 1-hand tilt & turn.



CANADA



CANADA UPPER FLOOR



CANADA



CANADA UPPER FLOOR



## CEYLON

**BID FAREWELL TO WANDERLUST:  
CLASSIC DESIGN IS THE PERFECT HAVEN OF  
TRANQUILITY.**

|                                | CEYLON PLATINUM*                | CEYLON DIAMOND**                |
|--------------------------------|---------------------------------|---------------------------------|
| Item number                    | 706141                          | 706144                          |
| <b>Base dimensions W x D</b>   | <b>740 x 544 + 157 x 214 cm</b> | <b>740 x 544 + 157 x 214 cm</b> |
| Wall thickness                 | 70 mm                           | 70 mm                           |
| Floor area                     | 43.60 m <sup>2</sup>            | 43.60 m <sup>2</sup>            |
| Interior                       | 75.20 m <sup>2</sup>            | 75.20 m <sup>2</sup>            |
| Volume                         | 170.30 m <sup>3</sup>           | 170.30 m <sup>3</sup>           |
| Side wall height               | 347 cm                          | 347 cm                          |
| Ridge height                   | 503 cm                          | 503 cm                          |
| Roof overhang                  | 50 cm                           | 50 cm                           |
| Roof area                      | 67 m <sup>2</sup>               | 67 m <sup>2</sup>               |
| Double door W x H              | 158 x 200 cm                    | 158 x 200 cm                    |
| 2 x single door W x H          | 83 x 193 cm                     | 83 x 193 cm                     |
| 4 x single door W x H          | 83 x 200 cm                     | 83 x 200 cm                     |
| 2 x single window W x H        | 92 x 92 cm                      | 92 x 92 cm                      |
| 3 x single window W x H        | 65 x 65 cm                      | 65 x 65 cm                      |
| 2 x double window W x H        | 110 x 173 cm                    | 110 x 173 cm                    |
| Single window W x H            | 150 x 65 cm                     | 150 x 65 cm                     |
| Floor thickness                | 28 mm                           | 28 mm                           |
| Roof covering, optional        | 9 x 10 m                        | 9 x 10 m                        |
| Roof shingles, optional (pack) | 28                              | 28                              |

\*Platinum window: Opening system: 2-hand tilt & turn.  
\*\*Diamond window: Opening system: 1-hand tilt & turn.



CEYLON



CEYLON UPPER FLOOR



CEYLON



CEYLON UPPER FLOOR





# MATTERHORN IDEAL MIX OF MODERN AND HARMONY WITH EXTRA COMFORT.

|                                | MATTERHORN 70 PLATINUM* | MATTERHORN 70 DIAMOND** |
|--------------------------------|-------------------------|-------------------------|
| Item number                    | 7011241                 | 7011244                 |
| <b>Base dimensions W × D</b>   | <b>740 × 540 cm</b>     | <b>740 × 540 cm</b>     |
| Wall thickness                 | 70 mm                   | 70 mm                   |
| Floor area                     | 40 m <sup>2</sup>       | 40 m <sup>2</sup>       |
| Interior                       | 66.60 m <sup>2</sup>    | 66.60 m <sup>2</sup>    |
| Volume                         | 167.49 m <sup>3</sup>   | 167.49 m <sup>3</sup>   |
| Side wall height               | 360 cm                  | 360 cm                  |
| Ridge height                   | 526 cm                  | 526 cm                  |
| Roof overhang                  | 50 cm                   | 50 cm                   |
| Roof area                      | 61.57 m <sup>2</sup>    | 61.57 m <sup>2</sup>    |
| Double door W × H              | 158 × 200 cm            | 158 × 200 cm            |
| 5 × single door W × H          | 83 × 200 cm             | 83 × 200 cm             |
| Single window W × H            | 65 × 65 cm              | 65 × 65 cm              |
| 2 × double window W × H        | 110 × 173 cm            | 110 × 173 cm            |
| 2 × double window W × H        | 92 × 92 cm              | 92 × 92 cm              |
| 5 × single window W × H        | 120 × 65 cm             | 120 × 65 cm             |
| Floor thickness                | 28 mm                   | 28 mm                   |
| Roof covering, optional        | 8 × 10 m                | 8 × 10 m                |
| Roof shingles, optional (pack) | 23                      | 23                      |

|                                | MATTERHORN 92 PLATINUM* | MATTERHORN 92 DIAMOND** |
|--------------------------------|-------------------------|-------------------------|
| Item number                    | 920241                  | 920244                  |
| <b>Base dimensions W × D</b>   | <b>740 × 540 cm</b>     | <b>740 × 540 cm</b>     |
| Wall thickness                 | 92 mm                   | 92 mm                   |
| Floor area                     | 40 m <sup>2</sup>       | 40 m <sup>2</sup>       |
| Interior                       | 65.30 m <sup>2</sup>    | 65.30 m <sup>2</sup>    |
| Volume                         | 167.49 m <sup>3</sup>   | 167.49 m <sup>3</sup>   |
| Side wall height               | 360 cm                  | 360 cm                  |
| Ridge height                   | 526 cm                  | 526 cm                  |
| Roof overhang                  | 50 cm                   | 50 cm                   |
| Roof area                      | 61.57 m <sup>2</sup>    | 61.57 m <sup>2</sup>    |
| Double door W × H              | 158 × 200 cm            | 158 × 200 cm            |
| 5 × single door W × H          | 83 × 200 cm             | 83 × 200 cm             |
| Single window W × H            | 65 × 65 cm              | 65 × 65 cm              |
| 2 × double window W × H        | 110 × 173 cm            | 110 × 173 cm            |
| 2 × double window W × H        | 92 × 92 cm              | 92 × 92 cm              |
| 5 × single window W × H        | 120 × 65 cm             | 120 × 65 cm             |
| Floor thickness                | 28 mm                   | 28 mm                   |
| Roof covering, optional        | 8 × 10 m                | 8 × 10 m                |
| Roof shingles, optional (pack) | 23                      | 23                      |

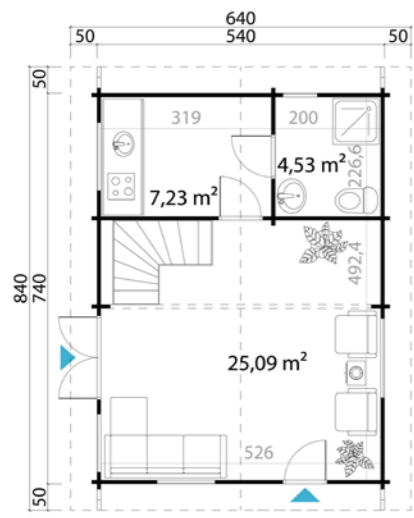

MATTERHORN



MATTERHORN

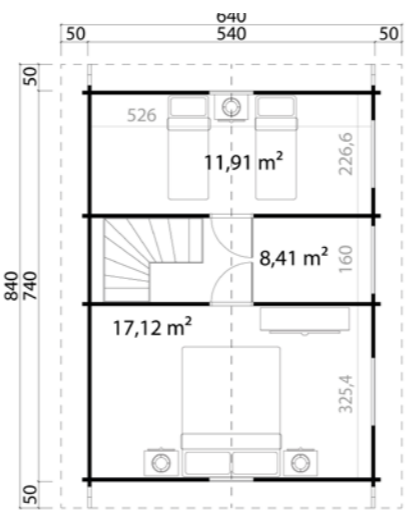

MATTERHORN UPPER FLOOR

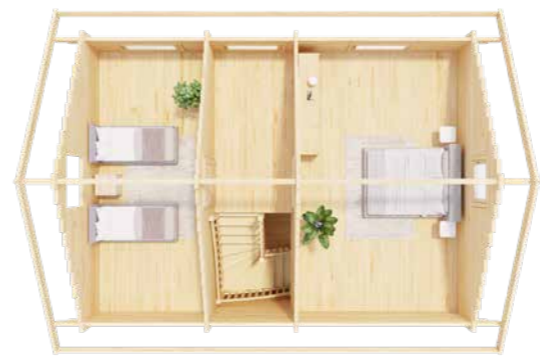

MATTERHORN UPPER FLOOR



Select your window quality.



98.5 m<sup>2</sup>

# VÄRNAMO

## SEPARATE ENTRIES FOR PLENTY OF PRIVACY.

|                                | VÄRNAMO PLATINUM*    | VÄRNAMO DIAMOND**    |
|--------------------------------|----------------------|----------------------|
| Item number                    | 7013041              | 7013044              |
| Base dimensions W × D          | 990 × 600 cm         | 990 × 600 cm         |
| Wall thickness                 | 70 mm                | 70 mm                |
| Floor area                     | 59.40 m <sup>2</sup> | 59.40 m <sup>2</sup> |
| Interior                       | 98.50 m <sup>2</sup> | 98.50 m <sup>2</sup> |
| Volume                         | 247 m <sup>3</sup>   | 247 m <sup>3</sup>   |
| Side wall height               | 377 cm               | 377 cm               |
| Ridge height                   | 497 cm               | 497 cm               |
| Roof overhang                  | 50 cm                | 50 cm                |
| Roof area                      | 76.80 m <sup>2</sup> | 76.80 m <sup>2</sup> |
| Double door W × H              | 158 × 200 cm         | 158 × 200 cm         |
| Single door W × H              | 73 × 186 cm          | 73 × 186 cm          |
| 2 × single door W × H          | 79 × 168 cm          | 79 × 168 cm          |
| 2 × single door W × H          | 104 × 200 cm         | 104 × 200 cm         |
| 3 × single door W × H          | 83 × 200 cm          | 83 × 200 cm          |
| 2 × single window W × H        | 92 × 92 cm           | 92 × 92 cm           |
| 2 × single window W × H        | 65 × 65 cm           | 65 × 65 cm           |
| 2 × single window W × H        | 55 × 200 cm          | 55 × 200 cm          |
| 3 × double window W × H        | 137 × 119 cm         | 137 × 119 cm         |
| Floor thickness                | 28 mm                | 28 mm                |
| Roof covering, optional        | 7 × 15 m             | 7 × 15 m             |
| Roof shingles, optional (pack) | 30                   | 30                   |

\*Platinum window: Opening system: 2-hand tilt & turn.  
 \*\*Diamond window: Opening system: 1-hand tilt & turn.

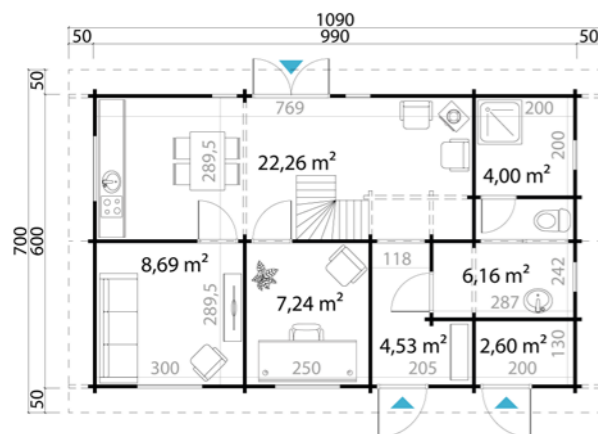

VÄRNAMO



VÄRNAMO

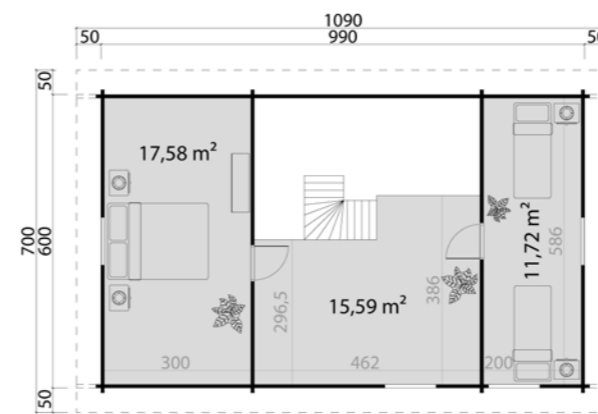

VÄRNAMO UPPER FLOOR



VÄRNAMO UPPER FLOOR





## YUKON

### PRETTY HOLIDAY HOME FOR THAT UNADULTERATED HOLIDAY FEELING.

|                                | YUKON                |
|--------------------------------|----------------------|
| Item number                    | 702641               |
| <b>Base dimensions W × D</b>   | <b>575 × 575 cm</b>  |
| Wall thickness                 | 70 mm                |
| Floor area                     | 30.20 m <sup>2</sup> |
| Terrace area                   | 9.40 m <sup>2</sup>  |
| Interior                       | 27.80 m <sup>2</sup> |
| Volume                         | 72.30 m <sup>3</sup> |
| Side wall height               | 218 cm               |
| Ridge height                   | 306 cm               |
| Roof overhang                  | 115 cm               |
| Roof area                      | 46.90 m <sup>2</sup> |
| Double door W × H              | 158 × 193 cm         |
| 3 × single door W × H          | 83 × 193 cm          |
| 3 × single window W × H        | 92 × 92 cm           |
| Single window W × H            | 65 × 65 cm           |
| Double window W × H            | 137 × 92 cm          |
| Floor thickness                | 18 mm                |
| Roof covering, optional        | 4 × 15 m             |
| Roof shingles, optional (pack) | 18                   |

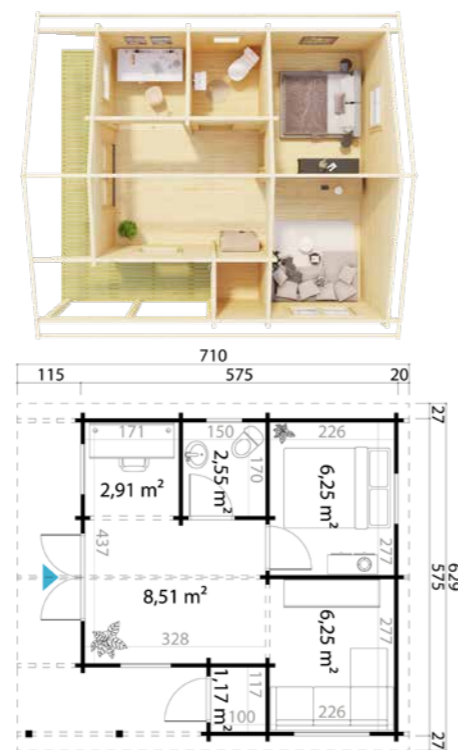

## JORDAN

### HOLIDAYING IN STYLE IN A SMALL SPACE. GENEROUS PROFILE FOR OPTIMUM COMFORT.

|                                | JORDAN               |
|--------------------------------|----------------------|
| Item number                    | 702341               |
| <b>Base dimensions W × D</b>   | <b>575 × 575 cm</b>  |
| Wall thickness                 | 70 mm                |
| Floor area                     | 30.20 m <sup>2</sup> |
| Terrace area                   | 8.30 m <sup>2</sup>  |
| Interior                       | 27.80 m <sup>2</sup> |
| Volume                         | 73 m <sup>3</sup>    |
| Side wall height               | 218 cm               |
| Ridge height                   | 300 cm               |
| Roof overhang                  | 115 cm               |
| Roof area                      | 46.90 m <sup>2</sup> |
| 5 × single door W × H          | 83 × 193 cm          |
| Single window W × H            | 70 × 119 cm          |
| 2 × single window W × H        | 92 × 92 cm           |
| 2 × double window W × H        | 137 × 105 cm         |
| Single window W × H            | 65 × 65 cm           |
| Floor thickness                | 28 mm                |
| Roof covering, optional        | 4 × 15 m             |
| Roof shingles, optional (pack) | 18                   |

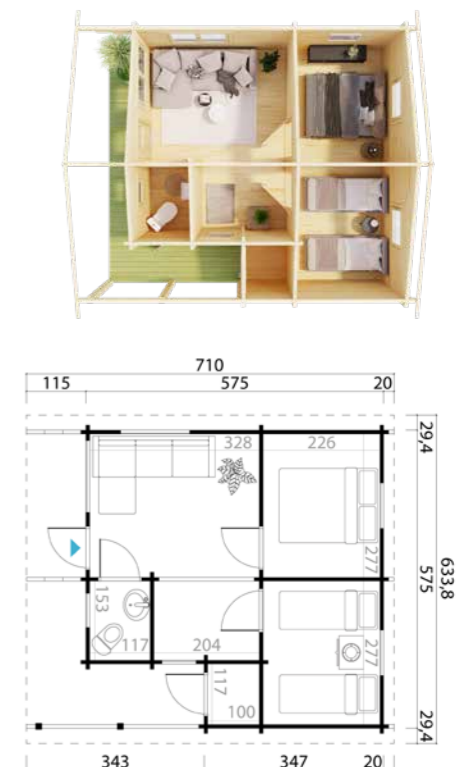





## BLUE NILE

### EXTRAVAGANT HOLIDAY HOME WITH LARGE TERRACE AND PRACTICAL ROOF OVERHANG.

| BLUE NILE                      |                                 |
|--------------------------------|---------------------------------|
| Item number                    | 703041                          |
| <b>Base dimensions W × D</b>   | <b>300 + 600 × 500 + 200 cm</b> |
| Wall thickness                 | 70 mm                           |
| Floor area                     | 30 m <sup>2</sup>               |
| Volume                         | 82.30 m <sup>3</sup>            |
| Terrace area                   | 33 m <sup>2</sup>               |
| Interior                       | 28 m <sup>2</sup>               |
| Side wall height               | 245 cm                          |
| Ridge height                   | 333 cm                          |
| Roof overhang                  | 320 cm                          |
| Roof area                      | 73.32 m <sup>2</sup>            |
| Glazed double door W × H       | 158 × 193 cm                    |
| Single door W × H              | 83 × 193 cm                     |
| Double window W × H            | 137 × 92 cm                     |
| 2 × single window W × H        | 55 × 173 cm                     |
| Floor thickness                | 28 mm                           |
| Roof covering, optional        | 9 × 10 m                        |
| Roof shingles, optional (pack) | 22                              |

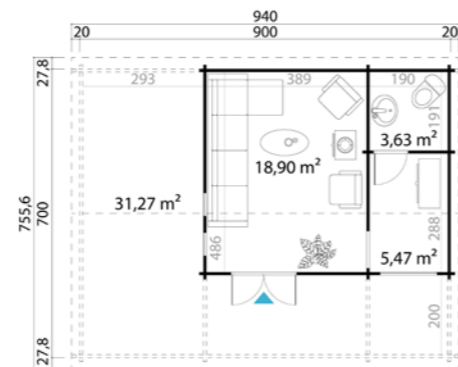

## WHITE NILE

### MINIMALIST DESIGN MEETS HIGH COMFORT. THE COSY TERRACE ENTICES YOU TO LINGER.

| WHITE NILE                     |                                 |
|--------------------------------|---------------------------------|
| Item number                    | 702941                          |
| <b>Base dimensions W × D</b>   | <b>100 + 300 × 350 + 294 cm</b> |
| Wall thickness                 | 70 mm                           |
| Floor area                     | 10.50 m <sup>2</sup>            |
| Terrace area                   | 18.90 m <sup>2</sup>            |
| Interior                       | 9.60 m <sup>2</sup>             |
| Volume                         | 24.50 m <sup>3</sup>            |
| Side wall height               | 224 cm                          |
| Ridge height                   | 299 cm                          |
| Roof overhang                  | 320 cm                          |
| Roof area                      | 39.50 m <sup>2</sup>            |
| Glazed double door W × H       | 158 × 193 cm                    |
| 3 × single window W × H        | 55 × 173 cm                     |
| Single window W × H            | 92 × 92 cm                      |
| Floor thickness                | 28 mm                           |
| Roof covering, optional        | 6 × 10 m                        |
| Roof shingles, optional (pack) | 15                              |

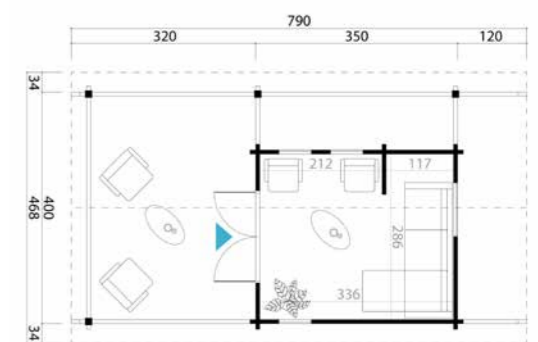





## ORINOCO

**INNOVATIVE DESIGN CREATES A GREAT FEELING OF SPACE IN A SMALL AREA.**

| ORINOCO                        |                           |
|--------------------------------|---------------------------|
| Item number                    | 702741                    |
| <b>Base dimensions W × D</b>   | <b>430 × 320 × 500 cm</b> |
| Wall thickness                 | 70 mm                     |
| Floor area                     | 16 m <sup>2</sup>         |
| Terrace area                   | 13.50 m <sup>2</sup>      |
| Interior                       | 14.90 m <sup>2</sup>      |
| Volume                         | 93.60 m <sup>3</sup>      |
| Side wall height               | 245 cm                    |
| Ridge height                   | 306 cm                    |
| Roof overhang                  | 460 cm                    |
| Roof area                      | 40 m <sup>2</sup>         |
| Glazed double door W × H       | 158 × 200 cm              |
| Glazed single door W × H       | 83 × 200 cm               |
| Single window W × H            | 92 × 92 cm                |
| Floor thickness                | 18 mm                     |
| Roof covering, optional        | 6 × 15 m                  |
| Roof shingles, optional (pack) | 18                        |

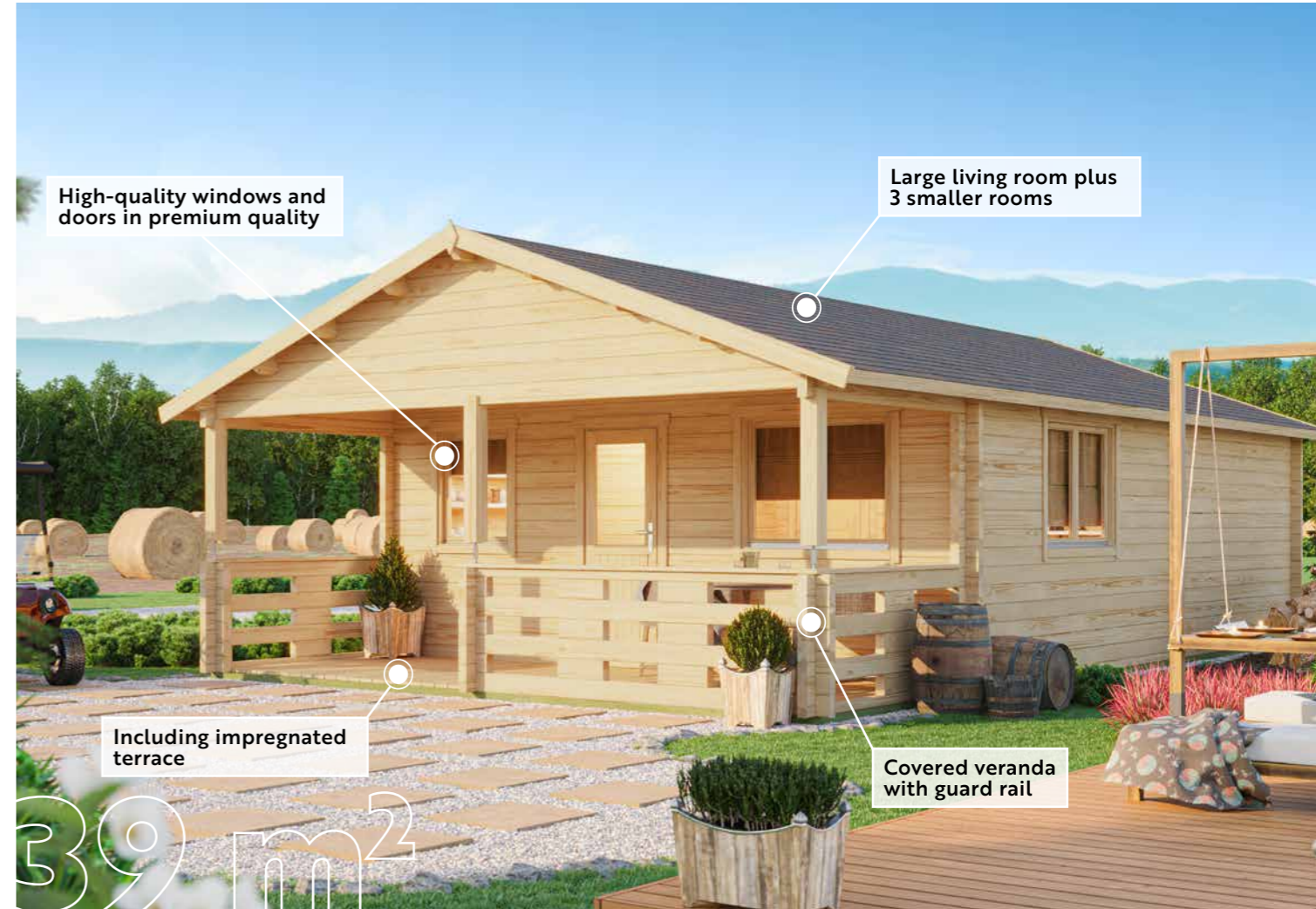
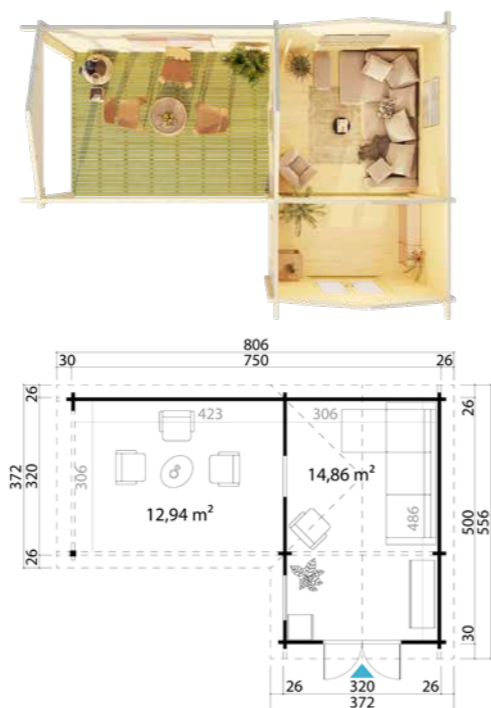

## OKA

**CLASSICALLY TIMELESS MODEL WITH SPACIOUS VERANDA.**

| OKA 70                         |                           |
|--------------------------------|---------------------------|
| Item number                    | 7012841                   |
| <b>Base dimensions W × D</b>   | <b>575 × 725 + 200 cm</b> |
| Wall thickness                 | 70 mm                     |
| Floor area                     | 41.70 m <sup>2</sup>      |
| Terrace area                   | 11.50 m <sup>2</sup>      |
| Interior                       | 39 m <sup>2</sup>         |
| Volume                         | 108.73 m <sup>3</sup>     |
| Side wall height               | 224 cm                    |
| Ridge height                   | 326 cm                    |
| Roof overhang                  | 220 cm                    |
| Roof area                      | 65.62 m <sup>2</sup>      |
| 4 × single door W × H          | 83 × 200 cm               |
| 2 × double window W × H        | 137 × 105 cm              |
| 4 × single window W × H        | 92 × 105 cm               |
| Floor thickness                | 28 mm                     |
| Roof covering, optional        | 8 × 10 m                  |
| Roof shingles, optional (pack) | 24                        |





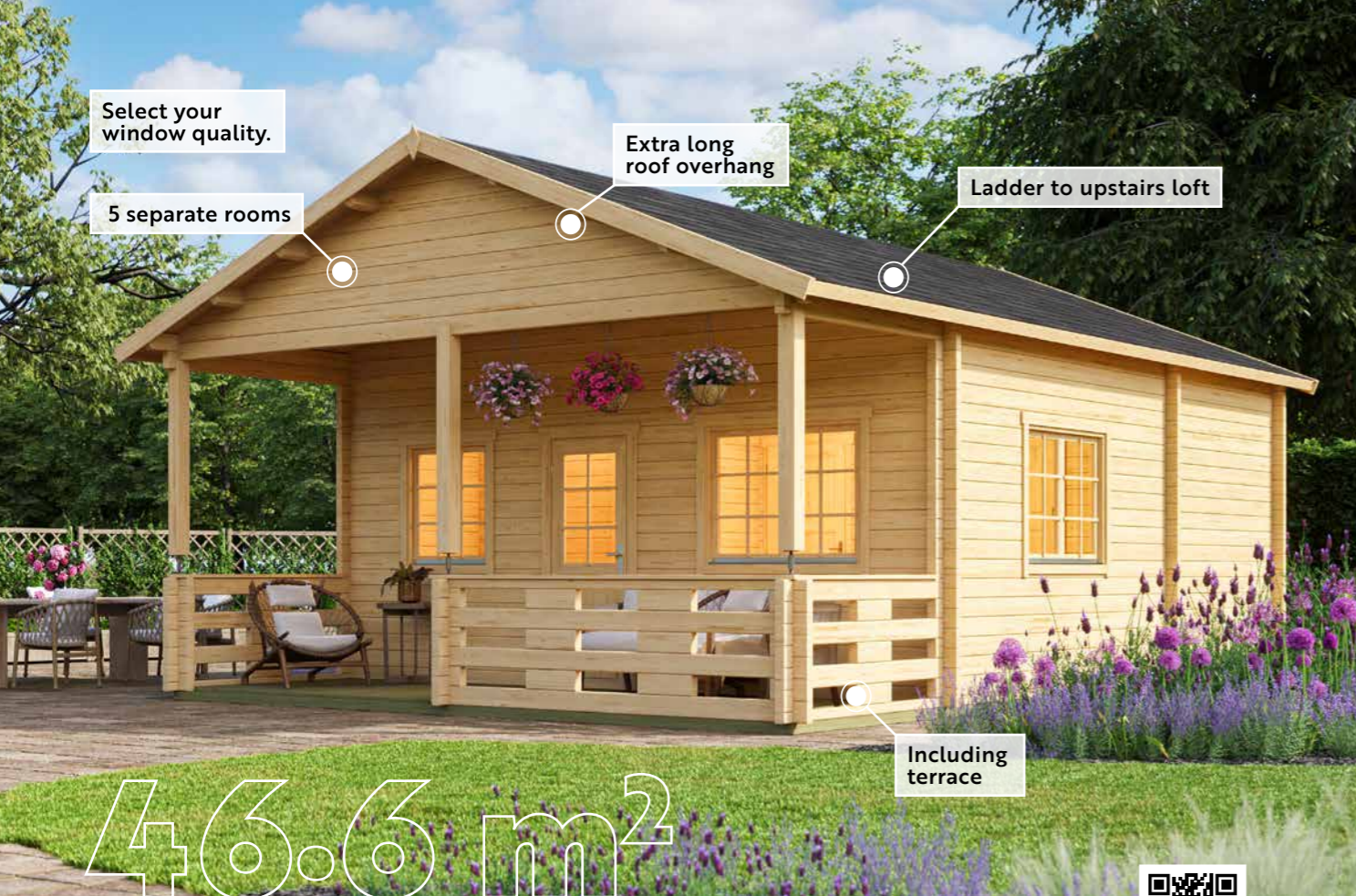

46.6 m<sup>2</sup>



## HAN SPACIOUS HOLIDAY HOME WITH LARGE VERANDA.

|                                | HAN PLATINUM*             | HAN DIAMOND**             |
|--------------------------------|---------------------------|---------------------------|
| Item number                    | 7010441                   | 7010444                   |
| <b>Base dimensions W x D</b>   | <b>575 x 625 + 190 cm</b> | <b>575 x 625 + 190 cm</b> |
| Wall thickness                 | 70 mm                     | 70 mm                     |
| Floor area                     | 35.90 m <sup>2</sup>      | 35.90 m <sup>2</sup>      |
| Terrace area                   | 10.90 m <sup>2</sup>      | 10.90 m <sup>2</sup>      |
| Interior                       | 46.60 m <sup>2</sup>      | 46.60 m <sup>2</sup>      |
| Volume                         | 115.38 m <sup>3</sup>     | 115.38 m <sup>3</sup>     |
| Side wall height               | 279 cm                    | 279 cm                    |
| Ridge height                   | 394 cm                    | 394 cm                    |
| Roof overhang                  | 220 cm                    | 220 cm                    |
| Roof area                      | 58.82 m <sup>2</sup>      | 58.82 m <sup>2</sup>      |
| 4 x single door W x H          | 83 x 200 cm               | 83 x 200 cm               |
| Single window W x H            | 65 x 65 cm                | 65 x 65 cm                |
| 4 x single window W x H        | 92 x 105 cm               | 92 x 105 cm               |
| 2 x double window W x H        | 137 x 105 cm              | 137 x 105 cm              |
| Floor thickness                | 28 mm                     | 28 mm                     |
| Roof covering, optional        | 8 x 10 m                  | 8 x 10 m                  |
| Roof shingles, optional (pack) | 22                        | 22                        |

\*Platinum window: Opening system: 2-hand tilt&turn.  
\*\*Diamond window: Opening system: 1-hand tilt&turn.

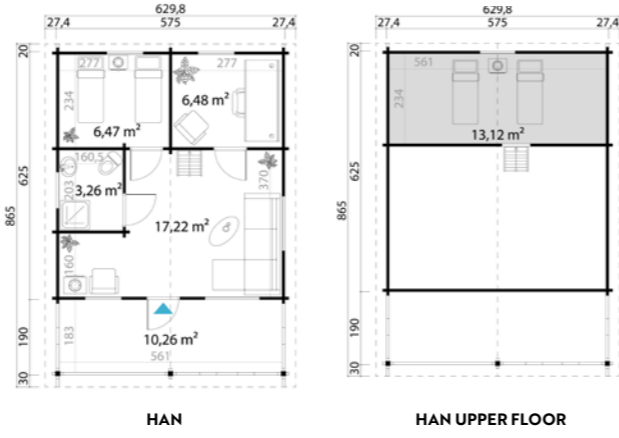

22.9 m<sup>2</sup>



## TAHITI SIMPLE ELEGANCE FOR PLENTY OF SPACE.

|                                | TAHITI 70            |
|--------------------------------|----------------------|
| Item number                    | 701302               |
| <b>Base dimensions W x D</b>   | <b>540 x 390 cm</b>  |
| Wall thickness                 | 70 mm                |
| Floor area                     | 18.50 m <sup>2</sup> |
| Terrace area                   | 2.60 m <sup>2</sup>  |
| Interior                       | 22.90 m <sup>2</sup> |
| Volume                         | 61.19 m <sup>3</sup> |
| Side wall height               | 258 cm               |
| Ridge height                   | 360 cm               |
| Roof overhang                  | 25 cm                |
| Roof area                      | 29.60 m <sup>2</sup> |
| Single door W x H              | 83 x 193 cm          |
| 3 x single window W x H        | 92 x 92 cm           |
| 2 x double window W x H        | 137 x 92 cm          |
| Floor thickness                | 18 mm                |
| Roof covering, optional        | 3 x 15 m             |
| Roof shingles, optional (pack) | 12                   |

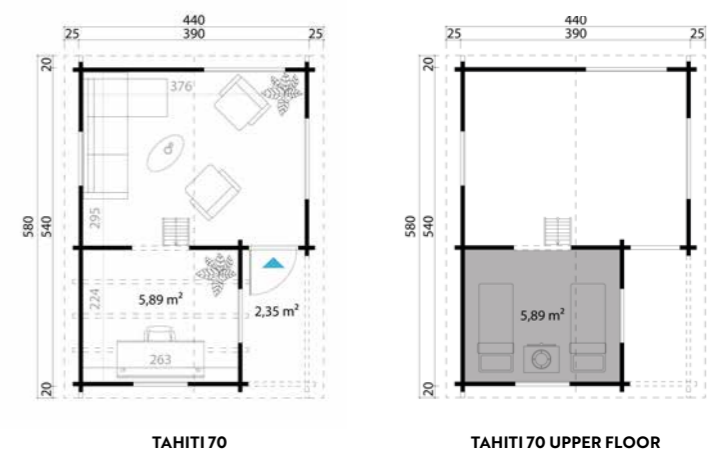





41.1 m<sup>2</sup>



## KASAI

### PRETTY GABLE ROOF MODEL WITH COSY VERANDA.

|                                | KASAI A 70           | KASAI B 70            |
|--------------------------------|----------------------|-----------------------|
| Item number                    | 7010141              | 7011741               |
| <b>Base dimensions W × D</b>   | <b>575 × 775 cm</b>  | <b>575 × 865 cm</b>   |
| Wall thickness                 | 70 mm                | 70 mm                 |
| Floor area                     | 38.80 m <sup>2</sup> | 44 m <sup>2</sup>     |
| Terrace area                   | 5.70 m <sup>2</sup>  | 5.70 m <sup>2</sup>   |
| Interior                       | 36.10 m <sup>2</sup> | 41.10 m <sup>2</sup>  |
| Volume                         | 98.03 m <sup>3</sup> | 110.60 m <sup>3</sup> |
| Side wall height               | 224 cm               | 224 cm                |
| Ridge height                   | 313 cm               | 313 cm                |
| Roof overhang                  | 159 cm               | 159 cm                |
| Roof area                      | 53.79 m <sup>2</sup> | 59.73 m <sup>2</sup>  |
| 4 × single door W × H          | 83 × 200 cm          | 83 × 200 cm           |
| 1 × double window W × H        | 137 × 105 cm         | 137 × 105 cm          |
| 5 × single window W × H        | 92 × 105 cm          | 92 × 105 cm           |
| Floor thickness                | 28 mm                | 28 mm                 |
| Roof covering, optional        | 8 × 10 m             | 8 × 10 m              |
| Roof shingles, optional (pack) | 20                   | 22                    |



KASAI A 70



KASAI A 70



KASAI B 70



KASAI B 70



36.6 m<sup>2</sup>

## MAIPO

### BARN-STYLE HOLIDAY HOME: PLENTY OF ROOM FOR ALL-ROUND RELAXATION.

|                                | MAIPO                |
|--------------------------------|----------------------|
| Item number                    | 702841               |
| <b>Base dimensions W × D</b>   | <b>400 × 700 cm</b>  |
| Wall thickness                 | 70 mm                |
| Floor area                     | 28 m <sup>2</sup>    |
| Interior                       | 36.60 m <sup>2</sup> |
| Volume                         | 95.35 m <sup>3</sup> |
| Side wall height               | 272 cm               |
| Ridge height                   | 456 cm               |
| Roof overhang                  | 50 cm                |
| Roof area                      | 50.99 m <sup>2</sup> |
| Double door W × H              | 158 × 200 cm         |
| Single door W × H              | 83 × 200 cm          |
| 2 × single window W × H        | 92 × 92 cm           |
| 2 × single window W × H        | 65 × 65 cm           |
| Floor thickness                | 18 mm                |
| Roof covering, optional        | 8 × 10 m             |
| Roof shingles, optional (pack) | 23                   |



MAIPO



MAIPO



MAIPO UPPER FLOOR

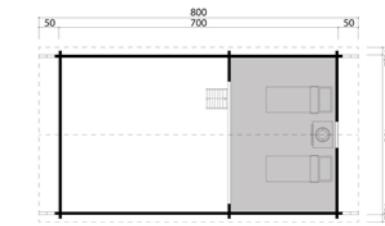

MAIPO UPPER FLOOR



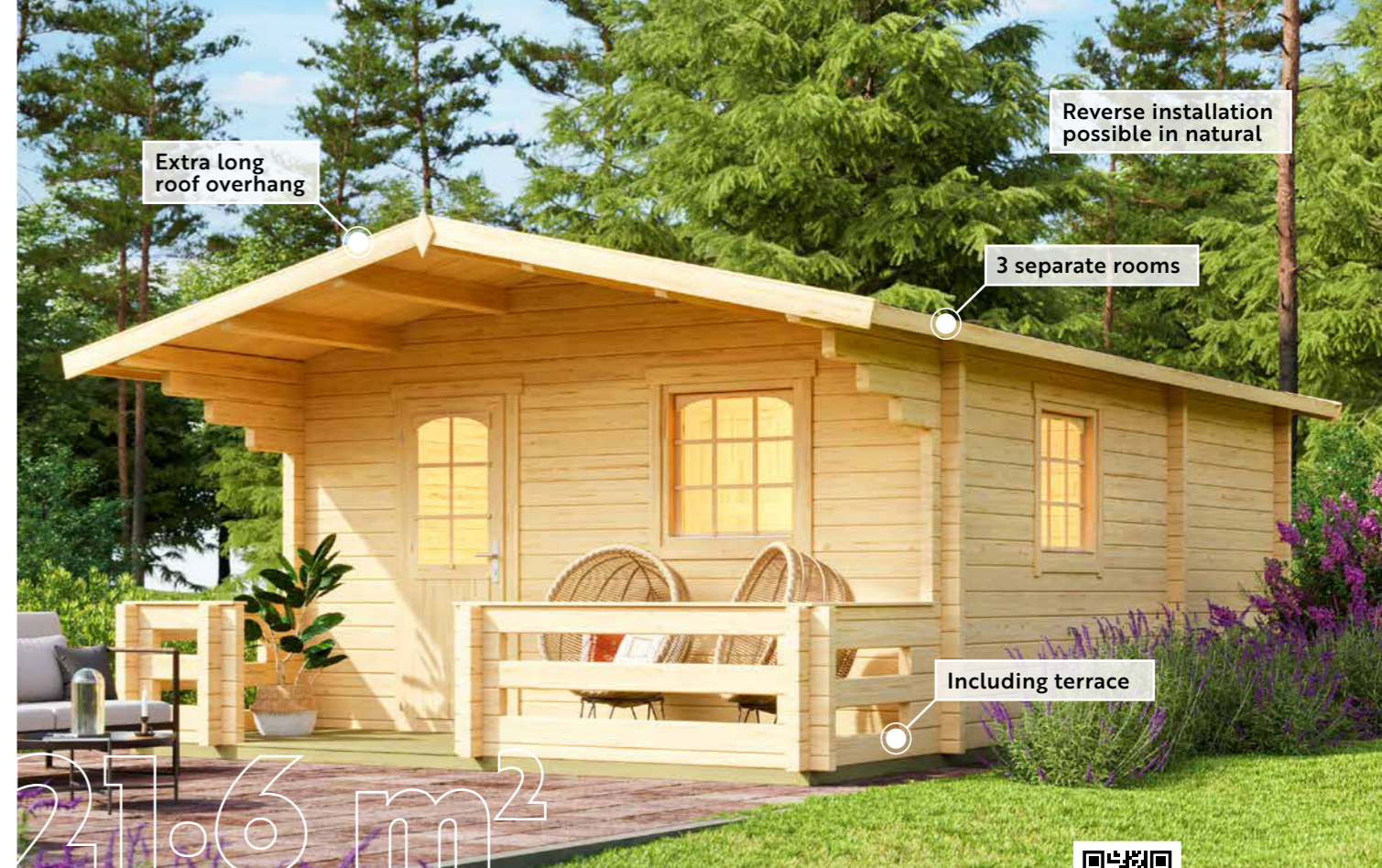

## TWIN CABIN

### SMALL CLASSIC FOR DOUBLE THE HOLIDAY FUN.

| TWIN CABIN                     |                           |
|--------------------------------|---------------------------|
| Item number                    | 703842                    |
| <b>Base dimensions W x D</b>   | <b>600 x 280 + 140 cm</b> |
| Wall thickness                 | 70 mm                     |
| Floor area                     | 16.80 m <sup>2</sup>      |
| Terrace area                   | 8.40 m <sup>2</sup>       |
| Interior                       | 15.40 m <sup>2</sup>      |
| Volume                         | 43.46 m <sup>3</sup>      |
| Side wall height               | 224 cm                    |
| Ridge height                   | 345 cm                    |
| Roof overhang                  | 160 cm                    |
| Roof area                      | 34.73 m <sup>2</sup>      |
| 2 x single door W x H          | 83 x 200 cm               |
| 2 x double window W x H        | 137 x 92 cm               |
| Floor thickness                | 28 mm                     |
| Roof covering, optional        | 4 x 15 m                  |
| Roof shingles, optional (pack) | 13                        |

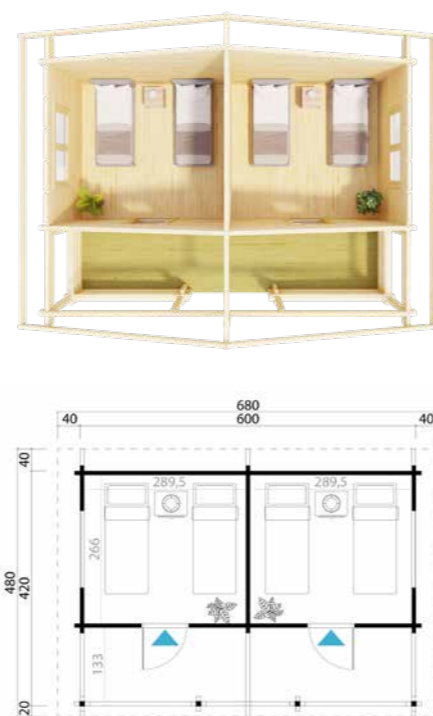

## ELBA

### COSY CABIN WITH COVERED TERRACE.

|                                | ELBA 70                   | ELBA 44                   |
|--------------------------------|---------------------------|---------------------------|
| Item number                    | 701002                    | 441302                    |
| <b>Base dimensions W x D</b>   | <b>420 x 540 + 140 cm</b> | <b>420 x 540 + 140 cm</b> |
| Wall thickness                 | 70 mm                     | 44 mm                     |
| Floor area                     | 22.70 m <sup>2</sup>      | 22.70 m <sup>2</sup>      |
| Terrace area                   | 5.90 m <sup>2</sup>       | 5.90 m <sup>2</sup>       |
| Interior                       | 20.90 m <sup>2</sup>      | 21.60 m <sup>2</sup>      |
| Volume                         | 51.55 m <sup>3</sup>      | 52.91                     |
| Side wall height               | 218 cm                    | 217                       |
| Ridge height                   | 265 cm                    | 268                       |
| Roof overhang                  | 150 cm                    | 150                       |
| Roof area                      | 35.50 m <sup>2</sup>      | 34.08                     |
| 3 x single door W x H          | 83 x 193 cm               | 84x196                    |
| 4 x single window W x H        | 92 x 92 cm                | 88x88                     |
| Floor thickness                | 18 mm                     | 18 mm                     |
| Roof covering, optional        | 3 x 15 m                  | 3 x 15 m                  |
| Roof shingles, optional (pack) | 14                        | 13                        |

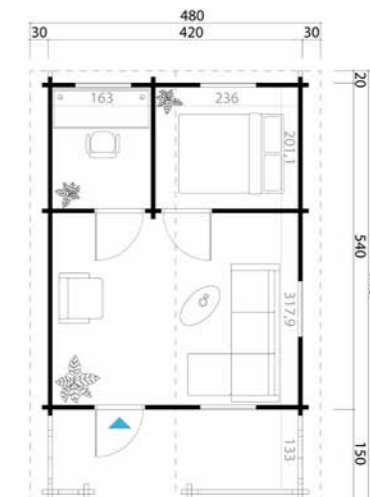

### APPROPRIATE ACCESSORIES



Other accessories can be found from page 102



Reverse installation possible in natural



Including beautiful and generous covered terrace

10.6 m<sup>2</sup>

## TRESCO

### MODERN GABLE-ROOFED CABIN WITH OPTIMALLY SPLIT ROOMS.

|                                | TRESCO                    |
|--------------------------------|---------------------------|
| Item number                    | 703941                    |
| <b>Base dimensions W × D</b>   | <b>450 × 260 × 140 cm</b> |
| Wall thickness                 | 70 mm                     |
| Floor area                     | 11.70 m <sup>2</sup>      |
| Terrace area                   | 6.30 m <sup>2</sup>       |
| Interior                       | 10.60 m <sup>2</sup>      |
| Volume                         | 27.58 m <sup>3</sup>      |
| Side wall height               | 237 cm                    |
| Ridge height                   | 304 cm                    |
| Roof overhang                  | 170 cm                    |
| Roof area                      | 27.04 m <sup>2</sup>      |
| 2 × single door W × H          | 83 × 200 cm               |
| 2 × single window W × H        | 92 × 92 cm                |
| Floor thickness                | 28 mm                     |
| Roof covering, optional        | 4 × 10 m                  |
| Roof shingles, optional (pack) | 11                        |

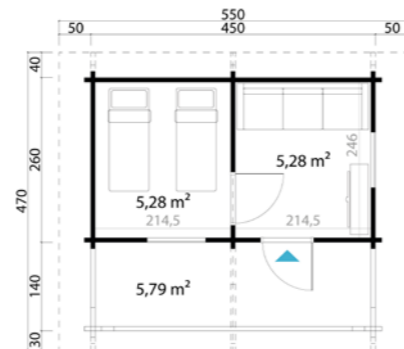

Including ladder to spacious upstairs loft



24 m<sup>2</sup>

## TIGRIS

### MINI HOLIDAY HOME IN SAUNA DESIGN. FOR A RELAXING TIME-OUT.

|                                | TIGRIS               |
|--------------------------------|----------------------|
| Item number                    | 701841               |
| <b>Base dimensions W × D</b>   | <b>570 × 550 cm</b>  |
| Wall thickness                 | 70 mm                |
| Floor area                     | 25.80 m <sup>2</sup> |
| Terrace area                   | 5.50 m <sup>2</sup>  |
| Interior                       | 24 m <sup>2</sup>    |
| Volume                         | 75.38 m <sup>3</sup> |
| Side wall height               | 272 cm               |
| Ridge height                   | 360 cm               |
| Roof overhang                  | 180 cm               |
| Roof area                      | 38.94 m <sup>2</sup> |
| 2 × single door W × H          | 83 × 193 cm          |
| 2 × single window W × H        | 70 × 119 cm          |
| 2 × single window W × H        | 65 × 65 cm           |
| 2 × double window W × H        | 137 × 92 cm          |
| Floor thickness                | 18 mm                |
| Roof covering, optional        | 4 × 15 m             |
| Roof shingles, optional (pack) | 15                   |



TIGRIS UPPER FLOOR



TIGRIS UPPER FLOOR



TIGRIS



TIGRIS





## JARI CHARMING CABIN WITH PRACTICAL ROOF OVERHANG.

| JARI                           |                           |
|--------------------------------|---------------------------|
| Item number                    | 703541                    |
| <b>Base dimensions W × D</b>   | <b>360 × 360 × 140 cm</b> |
| Wall thickness                 | 70 mm                     |
| Floor area                     | 13 m <sup>2</sup>         |
| Terrace area                   | 5 m <sup>2</sup>          |
| Interior                       | 12 m <sup>2</sup>         |
| Volume                         | 23.05 m <sup>3</sup>      |
| Side wall height               | 237 cm                    |
| Ridge height                   | 291 cm                    |
| Roof overhang                  | 160 cm                    |
| Roof area                      | 42.90 m <sup>2</sup>      |
| Single door W × H              | 83 × 200 cm               |
| Double window W × H            | 137 × 105                 |
| Double window W × H            | 137 × 92                  |
| Floor thickness                | 28 cm                     |
| Roof covering, optional        | 3 × 15 m                  |
| Roof shingles, optional (pack) | 11                        |

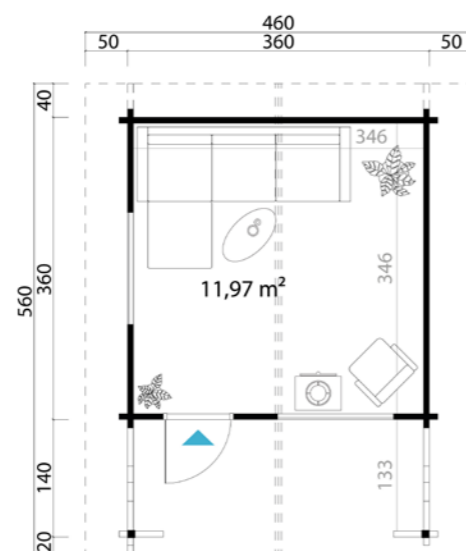

## ELGIN SPACIOUS, MODERN CABIN WITH FLOOR-TO-CEILING WINDOWS.

| ELGIN 70                       |                      |
|--------------------------------|----------------------|
| Item number                    | 7012902              |
| <b>Base dimensions W × D</b>   | <b>480 × 360 cm</b>  |
| Wall thickness                 | 70 mm                |
| Floor area                     | 17.30 m <sup>2</sup> |
| Interior                       | 16.10 m <sup>2</sup> |
| Volume                         | 40.09 m <sup>3</sup> |
| Side wall height               | 217 cm               |
| Ridge height                   | 265 cm               |
| Roof overhang                  | 50 cm                |
| Roof area                      | 23.68 m <sup>2</sup> |
| Double door W × H              | 158 × 193 cm         |
| 4 × single window W × H        | 55 × 173 cm          |
| Floor thickness                | 18 mm                |
| Roof covering, optional        | 3 × 15 m             |
| Roof shingles, optional (pack) | 9                    |

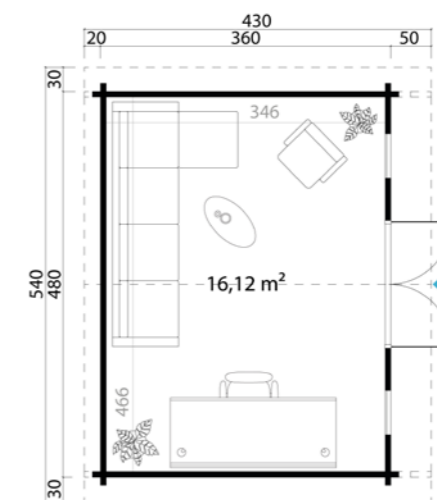

SNAP &  
WATCH



Reverse installation possible in natural

Extra long roof overhang

Wide double door

Zanzibar 4

31.5 m<sup>2</sup>



## ZANZIBAR

### MODERN CLASSIC WITH EXTRA LONG ROOF OVERHANG.

|                                | ZANZIBAR 1           | ZANZIBAR 4           |
|--------------------------------|----------------------|----------------------|
| Item number                    | 700702               | 700902               |
| <b>Base dimensions W x D</b>   | <b>485 x 390 cm</b>  | <b>575 x 575 cm</b>  |
| Wall thickness                 | 70 mm                | 70 mm                |
| Floor area                     | 18.90 m <sup>2</sup> | 33.10 m <sup>2</sup> |
| Interior                       | 17.70 m <sup>2</sup> | 31.50                |
| Volume                         | 45.16 m <sup>3</sup> | 82.39 m <sup>3</sup> |
| Side wall height               | 218 cm               | 218 cm               |
| Ridge height                   | 292 cm               | 306 cm               |
| Roof overhang                  | 150 cm               | 150 cm               |
| Roof area                      | 31.36 m <sup>2</sup> | 49.17 m <sup>2</sup> |
| 1 x double door W x H          | 158 x 193 cm         | 158 x 193 cm         |
| 1 x double window W x H        | 137 x 92 cm          | -                    |
| 2 x double window W x H        | -                    | 137 x 92 cm          |
| 1 x single window W x H        | 92 x 92 cm           | -                    |
| Floor thickness                | 18 mm                | 18 mm                |
| Roof covering, optional        | 4 x 15 m             | 8 x 10 m             |
| Roof shingles, optional (pack) | 12                   | 18                   |



ZANZIBAR 4



ZANZIBAR 1



21.7 m<sup>2</sup>

Spiekeroog 3

Why not complement this with our impregnated terrace 390 x 120 cm or 485 x 120 cm (p. 106)



## SPIEKEROOG

### COMFORT SQUARED! TIMELESS DESIGN WITH PRACTICAL DOUBLE DOOR.

|                                | SPIEKEROOG 1         | SPIEKEROOG 2         | SPIEKEROOG 3         |
|--------------------------------|----------------------|----------------------|----------------------|
| Item number                    | 700102               | 700202               | 700302               |
| <b>Base dimensions W x D</b>   | <b>390 x 390 cm</b>  | <b>480 x 390</b>     | <b>480 x 480</b>     |
| Wall thickness                 | 70 mm                | 70 mm                | 70 mm                |
| Floor area                     | 15.20 m <sup>2</sup> | 18.70 m <sup>2</sup> | 23 m <sup>2</sup>    |
| Interior                       | 14.10 m <sup>2</sup> | 17.50 m <sup>2</sup> | 21.70 m <sup>2</sup> |
| Volume                         | 35.41 m <sup>3</sup> | 45.07 m <sup>3</sup> | 55.52 m <sup>3</sup> |
| Side wall height               | 218 cm               | 218 cm               | 218 cm               |
| Ridge height                   | 265 cm               | 279 cm               | 279 cm               |
| Roof overhang                  | 120 cm               | 120 cm               | 90 cm                |
| Roof area                      | 24.38 m <sup>2</sup> | 28.62 m <sup>2</sup> | 31.86 m <sup>2</sup> |
| Double door W x H              | 158 x 193 cm         | 158 x 193 cm         | 158 x 193 cm         |
| Single window W x H            | 92 x 92 cm           | -                    | -                    |
| Double window W x H            | -                    | 137 x 92 cm          | 137 x 92 cm          |
| Floor thickness                | 18 cm                | 18 cm                | 18 cm                |
| Roof covering, optional        | 3 x 15 m             | 3 x 15 m             | 3 x 15 m             |
| Roof shingles, optional (pack) | 10                   | 11                   | 12                   |

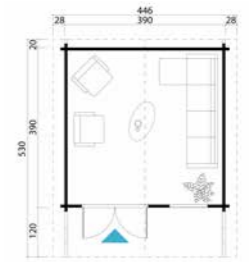

SPIEKEROOG 1

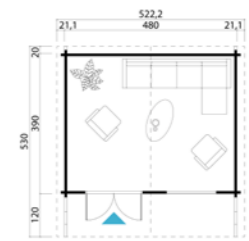

SPIEKEROOG 2



SPIEKEROOG 3





# GARAGES.

THE PLACE FOR STORAGE,  
WORKING OR THE WORKSHOP.



03 01

MODELS

WALL  
THICK-  
NESSES





# GARAGES. THE OPTIMAL SPACE, NOT ONLY FOR THE CAR.

Do you need more space in your home? No problem! Our garages offer ideal storage options for your vehicle, your bikes or even your workshop. All garages are delivered without a floor.

All garages can be ordered in four variants: 1. without garage door, 2. with wood double garage door, 3. with Hörmann steel up-and-over garage door with profile board frame, 4. new to the range is our sectional garage door, which you can order for selected models.



| DESIGN                       |               |
|------------------------------|---------------|
| 1 Wall thickness mm          | 44            |
| 2 Double tongue and groove   | +             |
| Wind-tight chalet connection | +             |
| 3 Wind protection            | Storm strip   |
| 4 Impregnated substructure   | +             |
| 5 Floorboards                | Without floor |
| ROOF CONSTRUCTION            |               |
| 6 Roof boards                | 18 mm         |
| 7 Roof construction          | Roof purlins  |

## Essentials

**SPRUCE 44 / 70 MM**  
**DOUBLE TONGUE AND GROOVE**  
**IMPREGNATED SUBSTRUCTURE**  
**ROOF BOARDS 15 / 18 MM**  
**SAFETY GLASS**



| WINDOW                 |                        |
|------------------------|------------------------|
| Wood type              | Untreated glued spruce |
| 1 Profile thickness mm | 44                     |
| 2 Mullions             | (With) screws          |
| 3 Safety glass         | Single (4 mm)          |
| U-value > W/m²K        | 5.60                   |
| 4 Drip cap             | Wood                   |
| 5 Window opening       | inwards                |
| Opening system         | 2-hand tilt & turn     |

  
SAFETY GLASS



| DOORS                  |                        |
|------------------------|------------------------|
| Wood type              | Untreated glued spruce |
| 1 Profile thickness mm | 44                     |
| 2 Mullions             | (With) screws          |
| 3 Safety glass         | Single (4 mm)          |
| U-value > W/m²K        | 5.60                   |
| 4 Door threshold       | Aluminium              |
| 5 Door opening         | outwards               |
| Lock                   | Cylinder               |

  
SAFETY GLASS



# HAWAII

## BEAUTIFUL SKLIGHT, A SEPARATE STORE ROOM AND SPACE FOR TWO CARS.



1. Hawaii without garage door  
2. Hawaii with up-and-over garage door  
3. Hawaii with wood garage door  
4. Hawaii with sectional garage door

|                                | HAWAII WITHOUT GARAGE DOOR | HAWAII WITH UP-AND-OVER GARAGE DOOR | HAWAII WITH WOOD GARAGE DOOR | HAWAII WITH SECTIONAL GARAGE DOOR |
|--------------------------------|----------------------------|-------------------------------------|------------------------------|-----------------------------------|
| Item number                    | 4410693                    | 4410658                             | 4410694                      | 43080                             |
| <b>Base dimensions W x D</b>   | <b>780 x 520 cm</b>        | <b>780 x 520 cm</b>                 | <b>780 x 520 cm</b>          | <b>780 x 520 cm</b>               |
| Wall thickness                 | 44 mm                      | 44 mm                               | 44 mm                        | 44 mm                             |
| Floor area                     | 40.60 m <sup>2</sup>       | 40.60 m <sup>2</sup>                | 40.60 m <sup>2</sup>         | 40.60 m <sup>2</sup>              |
| Interior                       | 39.20 m <sup>2</sup>       | 39.20 m <sup>2</sup>                | 39.20 m <sup>2</sup>         | 39.20 m <sup>2</sup>              |
| Volume                         | 103.23 m <sup>3</sup>      | 103.23 m <sup>3</sup>               | 103.23 m <sup>3</sup>        | 103.23 m <sup>3</sup>             |
| Side wall height               | 228 cm                     | 228 cm                              | 228 cm                       | 228 cm                            |
| Ridge height                   | 321 cm                     | 321 cm                              | 321 cm                       | 321 cm                            |
| Roof overhang                  | 31 cm                      | 31 cm                               | 31 cm                        | 31 cm                             |
| Roof area                      | 51.66 m <sup>2</sup>       | 51.66 m <sup>2</sup>                | 51.66 m <sup>2</sup>         | 51.66 m <sup>2</sup>              |
| Garage door                    | –                          | 238 x 208 cm                        | 239 x 202 cm                 | 240 x 205 cm                      |
| Single door W x H              | 84 x 185 cm                | 84 x 185 cm                         | 84 x 185 cm                  | 84 x 185 cm                       |
| 3 x fixed window W x H         | 150 x 41 cm                | 150 x 41 cm                         | 150 x 41 cm                  | 150 x 41 cm                       |
| Floor thickness                | –                          | –                                   | –                            | –                                 |
| Roof covering, optional        | 8 x 10 m                   | 8 x 10 m                            | 8 x 10 m                     | 8 x 10 m                          |
| Roof shingles, optional (pack) | 19                         | 19                                  | 19                           | 19                                |

|                                | HAWAII 70 WITHOUT GARAGE DOOR | HAWAII 70 WITH UP-AND-OVER GARAGE DOOR | HAWAII 70 WITH WOOD GARAGE DOOR | HAWAII 70 WITH SECTIONAL GARAGE DOOR |
|--------------------------------|-------------------------------|--|---------------------------------|--------------------------------------|
| Item number                    | 7016541                       | 7016558                                | 7016594                         | 7016599                              |
| <b>Base dimensions W x D</b>   | <b>780 x 520 cm</b>           | <b>780 x 520 cm</b>                    | <b>780 x 520 cm</b>             | <b>780 x 520 cm</b>                  |
| Wall thickness                 | 70 mm                         | 70 mm                                  | 70 mm                           | 70 mm                                |
| Floor area                     | 40.60 m <sup>2</sup>          | 40.60 m <sup>2</sup>                   | 40.60 m <sup>2</sup>            | 40.60 m <sup>2</sup>                 |
| Interior                       | 38.40 m <sup>2</sup>          | 38.40 m <sup>2</sup>                   | 38.40 m <sup>2</sup>            | 38.40 m <sup>2</sup>                 |
| Volume                         | 106.80 m <sup>3</sup>         | 106.80 m <sup>3</sup>                  | 106.80 m <sup>3</sup>           | 106.80 m <sup>3</sup>                |
| Side wall height               | 231 cm                        | 231 cm                                 | 231 cm                          | 231 cm                               |
| Ridge height                   | 329 cm                        | 329 cm                                 | 329 cm                          | 329 cm                               |
| Roof overhang                  | 33 cm                         | 33 cm                                  | 33 cm                           | 33 cm                                |
| Roof area                      | 52.16 m <sup>2</sup>          | 52.16 m <sup>2</sup>                   | 52.16 m <sup>2</sup>            | 52.16 m <sup>2</sup>                 |
| Garage door                    | –                             | 238 x 208 cm                           | 239 x 202 cm                    | 240 x 205 cm                         |
| Single door W x H              | 83 x 193 cm                   | 83 x 193 cm                            | 83 x 193 cm                     | 83 x 193 cm                          |
| 3 x fixed window W x H         | 150 x 51 cm                   | 150 x 51 cm                            | 150 x 51 cm                     | 150 x 51 cm                          |
| Roof covering, optional        | 8 x 10 m                      | 8 x 10 m                               | 8 x 10 m                        | 8 x 10 m                             |
| Roof shingles, optional (pack) | 19                            | 19                                     | 19                              | 19                                   |

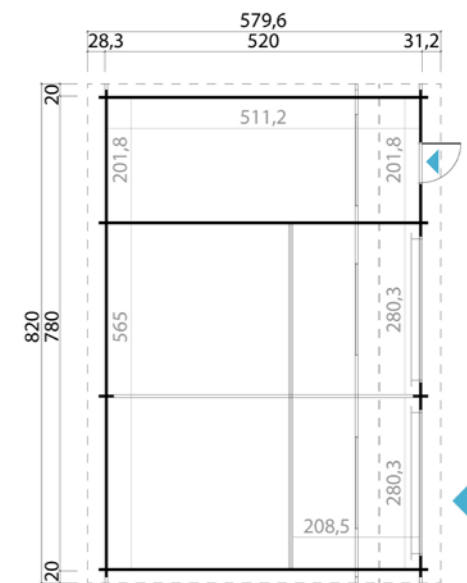





1. Canberra without garage door | 2. Canberra with up-and-over garage door | 3. Canberra with wood garage door

## CANBERRA WITH SIDE ENTRANCE DOOR IN FROSTED GLASS FOR LIGHT AND MORE PRIVACY.

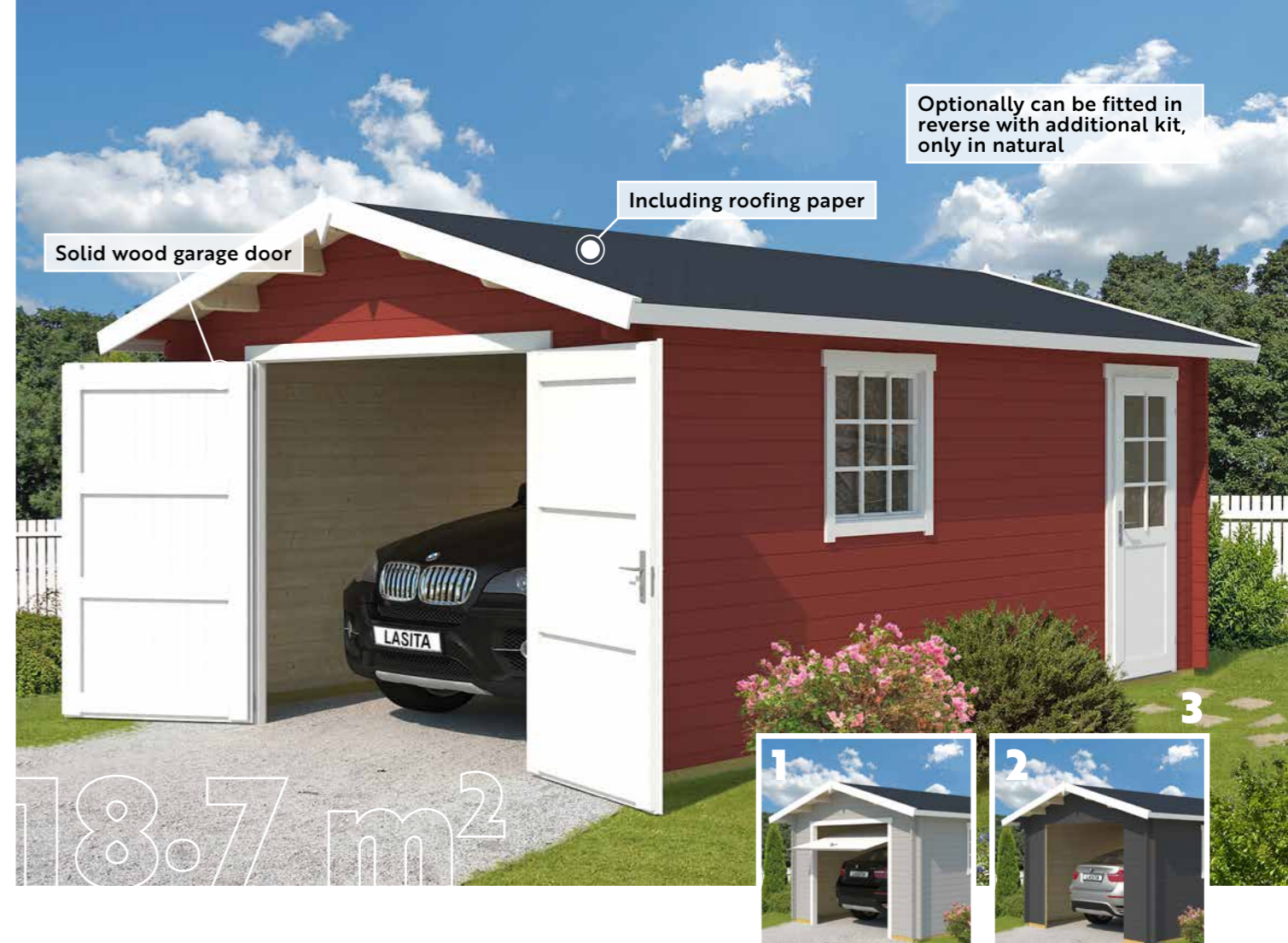

1. Antigua with up-and-over garage door | 2. Antigua without garage door | 3. Antigua with wood garage door

## ANTIGUA WITH SIDE ENTRY AND LARGE WINDOW.

|                              | CANBERRA WITHOUT GARAGE DOOR | CANBERRA WITH UP-AND-OVER GARAGE DOOR | CANBERRA WITH WOOD GARAGE DOOR |
|------------------------------|------------------------------|---------------------------------------|--------------------------------|
| Item number                  | 4412193                      | 4412158                               | 4412194                        |
| <b>Base dimensions W × D</b> | <b>360 × 540 cm</b>          | <b>360 × 540 cm</b>                   | <b>360 × 540 cm</b>            |
| Wall thickness               | 44 mm                        | 44 mm                                 | 44 mm                          |
| Floor area                   | 19.40 m <sup>2</sup>         | 19.40 m <sup>2</sup>                  | 19.40 m <sup>2</sup>           |
| Interior                     | 18.70 m <sup>2</sup>         | 18.70 m <sup>2</sup>                  | 18.70 m <sup>2</sup>           |
| Volume                       | 42.54 m <sup>3</sup>         | 42.54 m <sup>3</sup>                  | 42.54 m <sup>3</sup>           |
| Side wall height             | 222 cm                       | 222 cm                                | 222 cm                         |
| Ridge height                 | 234 cm                       | 234 cm                                | 234 cm                         |
| Roof overhang                | 40 cm                        | 40 cm                                 | 40 cm                          |
| Roof area                    | 24.90 m <sup>2</sup>         | 24.90 m <sup>2</sup>                  | 24.90 m <sup>2</sup>           |
| Garage door                  | –                            | 238 × 208 cm                          | 239 × 202 cm                   |
| Single door W × H            | 84 × 196 cm                  | 84 × 196 cm                           | 84 × 196 cm                    |
| 2 × fixed window W × H       | 150 × 41 cm                  | 150 × 41 cm                           | 150 × 41 cm                    |
| Floor thickness              | –                            | –                                     | –                              |
| Roof covering, optional      | 4 × 10 m                     | 4 × 10 m                              | 4 × 10 m                       |

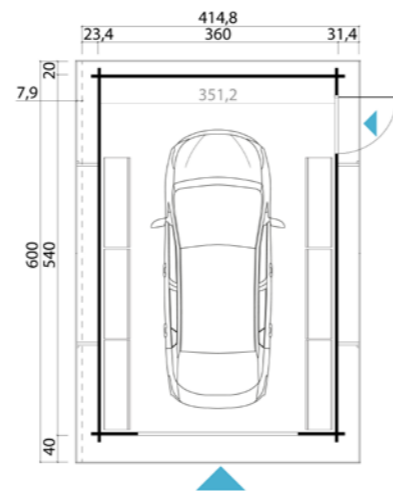

|                                | ANTIGUA WITHOUT GARAGE DOOR | ANTIGUA WITH UP-AND-OVER GARAGE DOOR | ANTIGUA WITH WOOD GARAGE DOOR |
|--------------------------------|-----------------------------|--------------------------------------|-------------------------------|
| Item number                    | 443193                      | 443158                               | 443194                        |
| <b>Base dimensions W × D</b>   | <b>360 × 540 cm</b>         | <b>360 × 540 cm</b>                  | <b>360 × 540 cm</b>           |
| Wall thickness                 | 44 mm                       | 44 mm                                | 44 mm                         |
| Floor area                     | 19.40 m <sup>2</sup>        | 19.40 m <sup>2</sup>                 | 19.40 m <sup>2</sup>          |
| Interior                       | 18.70 m <sup>2</sup>        | 18.70 m <sup>2</sup>                 | 18.70 m <sup>2</sup>          |
| Volume                         | 46.26 m <sup>3</sup>        | 46.26 m <sup>3</sup>                 | 46.26 m <sup>3</sup>          |
| Side wall height               | 222 cm                      | 222 cm                               | 222 cm                        |
| Ridge height                   | 274 cm                      | 274 cm                               | 274 cm                        |
| Roof overhang                  | 40 cm                       | 40 cm                                | 40 cm                         |
| Roof area                      | 26.40 m <sup>2</sup>        | 26.40 m <sup>2</sup>                 | 26.40 m <sup>2</sup>          |
| Wood garage door W × H         | –                           | 238 × 208 cm                         | 239 × 202 cm                  |
| Single door W × H              | 84 × 196 cm                 | 84 × 196 cm                          | 84 × 196 cm                   |
| Single window W × H            | 88 × 88 cm                  | 88 × 88 cm                           | 88 × 88 cm                    |
| Roof covering, optional        | 4 × 10 m                    | 4 × 10 m                             | 4 × 10 m                      |
| Roof shingles, optional (pack) | 11                          | 11                                   | 11                            |

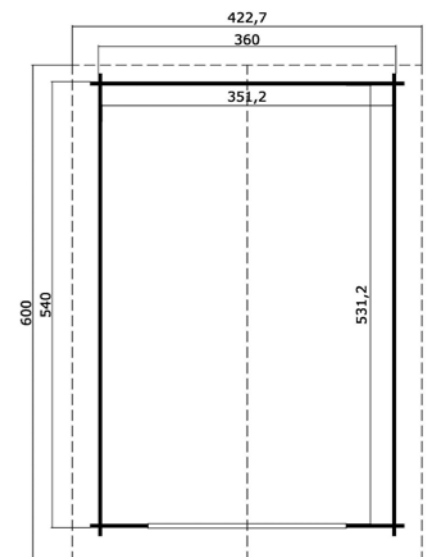



# ACCESSORIES.

FOR ADDING INDIVIDUAL TOUCHES. EXACTLY  
AS YOU WISH.

# 29

OPTIONS





# ACCESSORIES

## STANDARD ROOFING FELT

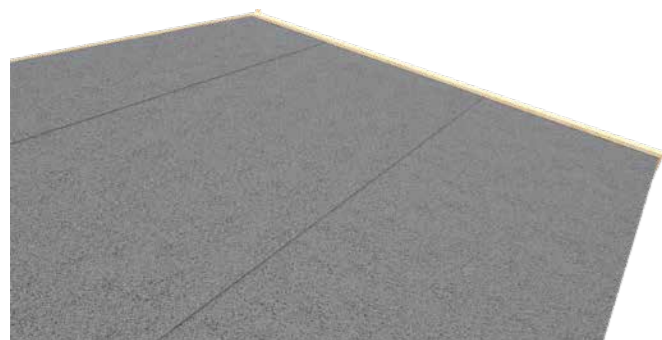

Suitable for short-term use or as underlay for other roof coverings such as shingles or premium roofing felt, available in classic grey, on a 10 m<sup>2</sup> or 15 m<sup>2</sup> roll.

|             | ROLL 10           | ROLL 15           |
|-------------|-------------------|-------------------|
| Item number | 261               | 262               |
| Floor area  | 10 m <sup>2</sup> | 15 m <sup>2</sup> |

## PREMIUM ROOFING FELT



High-quality polymer bitumen roofing felt – suitable for long-term, waterproof covering of roofs, available in 4 colours, on 15 m<sup>2</sup> roll.

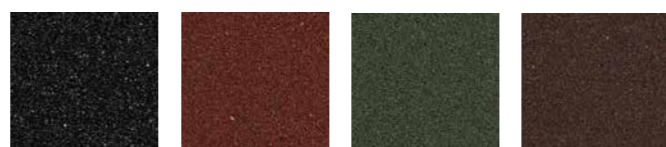

|             | BLACK             | RED               | GREEN             | BROWN             |
|-------------|-------------------|-------------------|-------------------|-------------------|
| Item number | 37449             | 37451             | 37452             | 37453             |
| Floor area  | 15 m <sup>2</sup> | 15 m <sup>2</sup> | 15 m <sup>2</sup> | 15 m <sup>2</sup> |

## ROOF SHINGLES



The 3-strip roof shingles are the most widely used roof shingles. They are easy to install and guarantee a stylish, high-quality appearance, available in the 4 most popular colours, 3 m<sup>2</sup> per pack.



|             | BLACK            | RED              | GREEN            | BROWN            |
|-------------|------------------|------------------|------------------|------------------|
| Item number | 263              | 16274            | 16275            | 264              |
| Floor area  | 3 m <sup>2</sup> | 3 m <sup>2</sup> | 3 m <sup>2</sup> | 3 m <sup>2</sup> |

## ONDULINE



ONDULINE KSK-M is a cold self-adhesive roofing membrane with an aluminium top layer and a particularly high adhesive strength. It is easy, safe and quick to apply. The aluminium top layer offers outstanding protection against UV radiation and other environmental influences. The substrate must be dry, stable, frost-free, grease-free and resistant to abrasion. Does not stick to silicone. Unevenness, holes and similar must be levelled or filled. Dimensions 500 x 100 cm.

|             | GREY             |
|-------------|------------------|
| Item number | 37470            |
| Floor area  | 5 m <sup>2</sup> |

## INFRARED HEATER



In Jura marble

Made of genuine Carrara-style marble

Marmory infrared heater: Beneficial infrared heat and healthy climate with state-of-the-art controls. Everything is possible, from a number of daily and weekly settings, frost protection or holiday mode to "open window detected". Simply install, plug in and feel really good. Connection voltage: 230 V, 50 Hz. When installing in a garden cabin, a non-combustible plate must be mounted between the heating panel and the wall as a base for the heater.

|             | JURA 500 WATTS | JURA 800 WATTS  | CARRARA 500 WATTS | CARRARA 800 WATTS |
|-------------|----------------|-----------------|-------------------|-------------------|
| Item number | M500-X018      | M800-X006       | C480-X014         | C780-X010         |
| Dimensions  | 50 x 60 x 2 cm | 100 x 40 x 2 cm | 50 x 60 x 2 cm    | 100 x 40 x 2 cm   |

## PENT ROOF



|                                | A 90 x 240          | A 90 x 300          | B 90 x 240          | B 90 x 300          |
|--------------------------------|---------------------|---------------------|---------------------|---------------------|
| Item number                    | 280700              | 285200              | 9901600             | 9901700             |
| Wall thickness                 | –                   | –                   | 19 mm               | 19 mm               |
| <b>Base dimensions W x D</b>   | <b>90 x 240 cm</b>  | <b>90 x 300 cm</b>  | <b>90 x 240 cm</b>  | <b>90 x 300 cm</b>  |
| Floor area                     | 2 m <sup>2</sup>    | 2.50 m <sup>2</sup> | 2 m <sup>2</sup>    | 2.50 m <sup>2</sup> |
| Volume                         | 3.50 m <sup>3</sup> | 4.40 m <sup>3</sup> | 3.50 m <sup>3</sup> | 4.40 m <sup>3</sup> |
| Side wall height               | 166 cm              | 166 cm              | 166 cm              | 166 cm              |
| Ridge height                   | 186 cm              | 186 cm              | 186 cm              | 186 cm              |
| Roof area                      | 2.60 m <sup>2</sup> | 3.30 m <sup>2</sup> | 2.60 m <sup>2</sup> | 3.30 m <sup>2</sup> |
| Roof covering, optional        | 1 x 15 m            | 1 x 15 m            | 1 x 15 m            | 1 x 15 m            |
| Roof shingles, optional (pack) | 2                   | 2                   | 2                   | 2                   |



# ACCESSORIES

## TERRACES

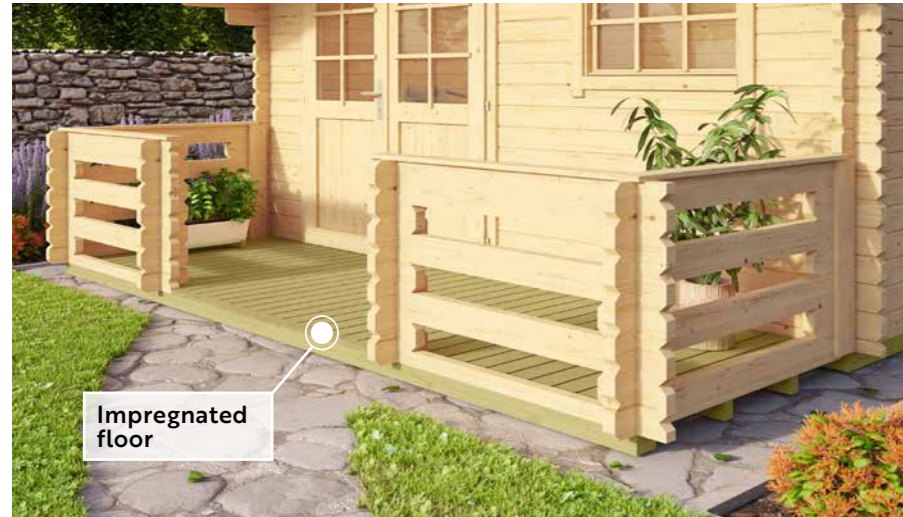

|                              | 28 3013             | 40 3613             | 40 3913             | 40 48513            |
|------------------------------|---------------------|---------------------|---------------------|---------------------|
| Item number                  | 285300              | 4018600             | 4018700             | 4018800             |
| Wall thickness               | 28 mm               | 40 mm               | 40 mm               | 40 mm               |
| <b>Base dimensions W x D</b> | <b>300 x 120 cm</b> | <b>360 x 120 cm</b> | <b>390 x 120 cm</b> | <b>485 x 120 cm</b> |
| Floor area                   | 3.40 m <sup>2</sup> | 3.90 m <sup>2</sup> | 4.20 m <sup>2</sup> | 5.30 m <sup>2</sup> |
| Floor                        | Included            | Included            | Included            | Included            |

## BAR



|                  | BAR UNIT    |
|------------------|-------------|
| Item number      | 991900      |
| Dimensions W x D | 190 x 65 cm |
| Height           | 102 cm      |

## FLOWER BOX



|             | FOR SINGLE WINDOWS |
|-------------|--------------------|
| Item number | 990600             |
|             | FOR DOUBLE WINDOWS |
| Item number | 990800             |

## GUTTERS



Gutter sets for garden cabins with a wall depth of 490 cm. Consisting of gutter, gutter connector, gutter bracket, end pieces, rainwater downpipe, pipe elbow, downpipe bracket, diameter 10 cm.

|                 | SET A      | SET A INCL. DOWNPIPE | SET B      | SET B INCL. DOWNPIPE | SET C INCL. DOWNPIPE | SET D INCL. DOWNPIPE | SET E INCL. DOWNPIPE | SET F INCL. DOWNPIPE |
|-----------------|------------|----------------------|------------|----------------------|----------------------|----------------------|----------------------|----------------------|
| Item number     | 35807      | 35808                | 35809      | 35810                | 35811                | 35812                | 35813                | 35814                |
| For roof length | 180-219 cm | 180-219 cm           | 220-259 cm | 220-259 cm           | 260-300 cm           | 301-349 cm           | 350-390 cm           | 400-490 cm           |

## PAINT FOR REPAINTING

If you have bought a garden cabin that has already been painted by Lasita Maja, you can obtain the original paint for repainting from a well-stocked specialist shop.



© OSMO

## WINDOW SHUTTERS



Available for single or double windows

| Window shutters for windows (cm) | 540 x 540 | 685 x 882 | 770 x 770 | 770 x 990 | 882 x 882 | 882 x 990 | 882 x 1110 | 1290 x 882 |
|----------------------------------|-----------|-----------|-----------|-----------|-----------|-----------|------------|------------|
| Item number                      | 994300    | 994400    | 994500    | 994600    | 994700    | 994800    | 994900     | 995000     |









© LASITA MAJA  
VERSION 01/2023 EN

The dimensions specified in the catalogue are approximate. The actual dimensions may differ slightly. Unless specified to the contrary, the products are given without accessories and without decoration. We reserve the right to make technical changes to the benefit of our products, along with small design modifications. No liability for printing errors.